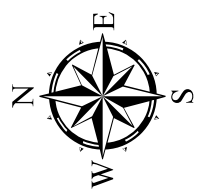
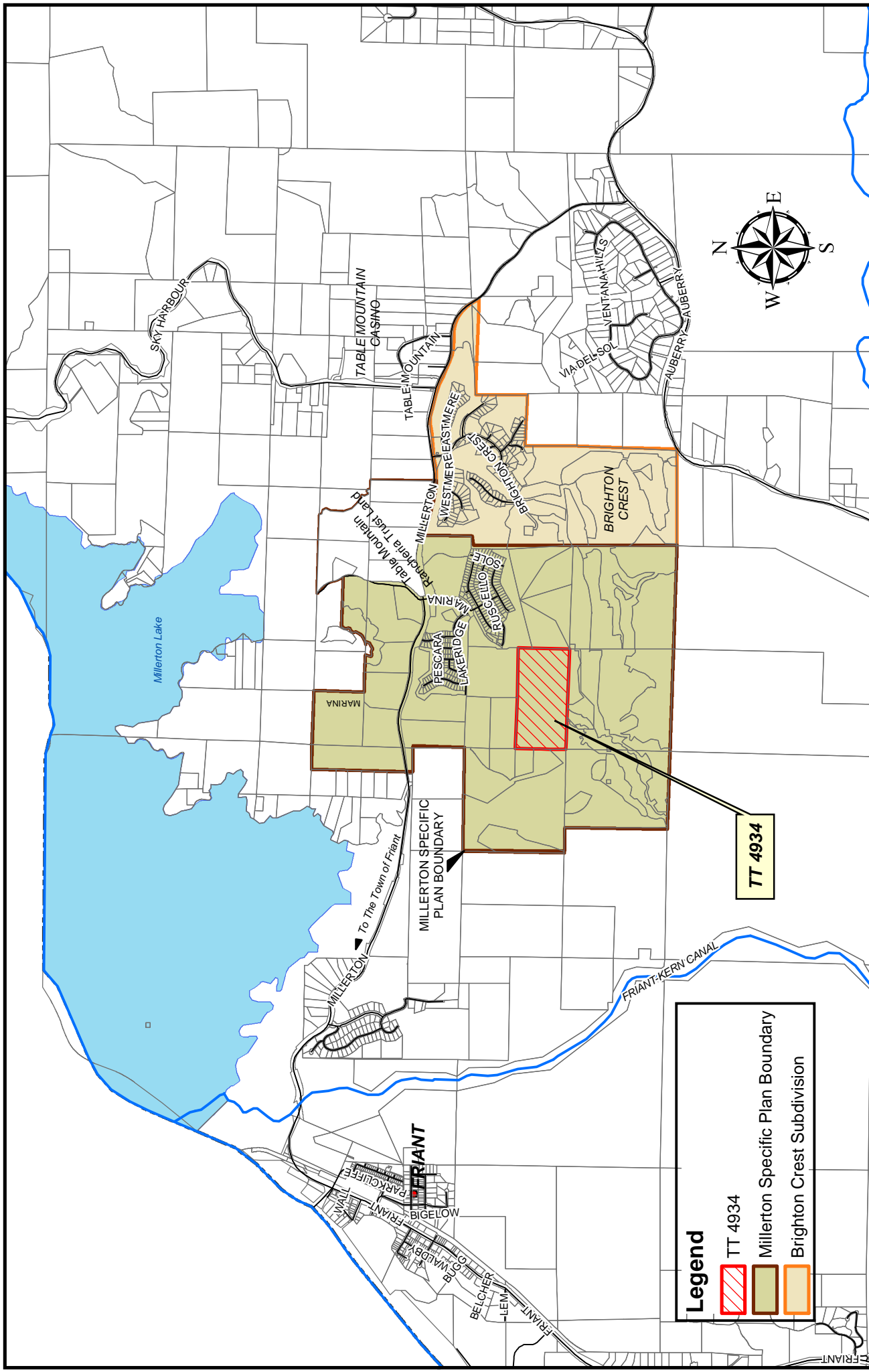

EXHIBIT A



Legend

- TT 4934
- Millerton Specific Plan Boundary
- Brighton Crest Subdivision

TT 4934



Department of Public Works and Planning
Development Services and Capital Projects Division

TRACT NO. 4934

SCALE IN FEET



DATE:

03/01/2019

DRAWN: K. JONES

Exhibit A

EXHIBIT "B"
2020
MILLERTON NEW TOWN INFRASTRUCTURE FACILITY FEES

<u>WATER FACILITIES</u>	<u>TOTAL COST</u>	<u>NO. OF UNITS</u>	<u>COST PER UNIT</u>
Intake and Transmission	\$ 5,542,554.23	3336	\$ 1,661.44
Groundwater Extraction	\$ 247,611.88	3336	\$ 74.22
Water Treatment	\$ 8,626,462.80	3336	\$ 2,585.87
Water Distribution and Storage	\$ 10,870,980.42	3336	\$ 3,258.69
 <u>WASTEWATER FACILITIES</u>			
Wastewater Treatment	\$ 33,130,194.50	3851	\$ 8,603.01
Wastewater Collection	\$ 3,104,747.59	3006	\$ 1,032.85
Reclaimed Effluent Disposal	\$ 2,288,563.40	3851	\$ 594.28
3% Administration Fee	\$ 1,914,333.44		\$ 534.31
 <u>TOTAL</u>	 <u>\$ 63,811,114.82</u>		 <u>\$ 18,344.67</u>

EXHIBIT "C"
2020
MILLERTON SPECIFIC PLAN FEES

<u>ROAD IMPROVEMENTS</u>	<u>TOTAL COST</u>	<u>NO. OF UNITS</u>	<u>COST PER UNIT</u>
Marina Drive	\$ 11,857,631.20	3499	\$ 3,388.86
Millerton Road	\$ 2,793,621.37	3499	\$ 798.41
Collector Road	\$ 8,945,740.64	3499	\$ 2,556.66
 <u>SIGNAL LOCATION</u>			
Millerton at Marina	\$ 354,778.50	3499	\$ 101.39
 <u>PARKS</u>			
White Fox Creek/Marina Dr. Prkwy	\$ 298,042.99	3499	\$ 85.18
Community Park	\$ 1,071,942.85	3499	\$ 306.36
3% Administration Fee	\$ 759,652.73		\$ 217.11
 <u>TOTAL</u>	 <u>\$ 25,321,757.55</u>		 <u>\$ 7,453.96</u>