



Sustainable Transportation Planning Grant Program

GRANT APPLICATION COVER SHEET

PART A. APPLICATION INFORMATION				FY 2022-23	
Grant Category (select only one)					
Sustainable Communities (MPOs with sub-applicant, RTPAs, Transit Agencies, Cities, Counties, Tribes, other Public Transportation Planning Entities)			Strategic Partnerships (MPOs and RTPAs only)		
<input checked="" type="radio"/>	Sustainable Communities Competitive (11.47% Local Match requirement)		<input type="radio"/>	Strategic Partnerships (FHWA SPR Part I) (20% Local Match requirement)	
<input type="radio"/>	Sustainable Communities Competitive Technical (11.47% Local Match requirement)		<input type="radio"/>	Strategic Partnerships Transit (FTA 5304) (11.47% Local Match requirement)	
Application Submittal Type (more than one may be selected)					
New		Prior Phases		Re-Submittal	
<input checked="" type="radio"/>	New Application	<input type="radio"/>	Continuation of a prior project. If so, list the project title below.	<input type="radio"/>	Re-submittal from a prior grant cycle.
				<input type="radio"/>	How many times has an application been submitted for this project?

PART B. PROJECT INFORMATION					
Project Title and Location					
Project Title	Multi-modal Planning & Research for DUCs within the County of Fresno				
Project Location (City)	Fresno County, CA	Project Location (County)	Various Locations		
PART D: Funding Information					
1. Is the applicant proposing to meet the minimum local match requirement or an over-match? Use the Match Calculator to determine the appropriate match. Match Calculator					
<input checked="" type="checkbox"/> Minimum Local Match <input type="checkbox"/> Over-Match					
2. What is the source of Local Match funds being used? (MPOs – Federal Toll Credits, PL, FTA 5303, and Sustainable Communities Formula <u>cannot</u> be used to match Sustainable Communities Competitive)					
<input checked="" type="checkbox"/> Local Transportation Funds <input type="checkbox"/> Local Sales Tax <input type="checkbox"/> Special Bond Measures					
<input checked="" type="checkbox"/> Other, specify: <input type="text" value="Measure C"/>					
Grant Funds Requested	Local Match (Cash)	Local Match (In-Kind)	Total Local Match	% Local Match	Total Project Cost
\$ 584,298	\$ 75,702	\$ 40,000	\$ 115,702	16.53%	\$ 700,000



Sustainable Transportation Planning Grant Program
GRANT APPLICATION COVER SHEET

PART C. CONTACT INFORMATION*

	Applicant	Sub-Applicant	Sub-Applicant
Organization (legal name)	County of Fresno		
Dept./Division	Public Works & Planning		
Street Address	2220 Tulare Street, 6th Floor		
City	Fresno, CA		
Zip Code	93721		
Phone Number	(559) 600-4109		
Executive Director Name	Steven E. White		
Title	Director		
Executive Director E-mail	stwhite@fresnocountyca.gov		
Contact Person Name	Mohammad Alimi		
Contact Person Title	Design Engineer		
Contact Phone Number	(559) 600-4505		
Contact E-mail	malimi@fresnocountyca.gov		

*Use additional pages if necessary.

PART D. COMPLIANT HOUSING ELEMENT

City/County Applying for Sustainable Communities Grants	Yes	No
Does the City/County have a compliant Housing Element?	<input checked="" type="radio"/>	<input type="radio"/>
Has the City/County submitted Annual Progress Report to the California Department of Housing and Community Development for calendar years 2019 and 2020?	<input checked="" type="radio"/>	<input type="radio"/>



Sustainable Transportation Planning Grant Program
GRANT APPLICATION COVER SHEET

PART E. LEGISLATIVE INFORMATION

Use the following link to determine the appropriate legislative members in the Project area.

Search by address: <http://findyourrep.legislature.ca.gov/>

State Senator(s)		Assembly Member(s)	
District	Name	District	Name
8	Andreas Borgeas	23	Jim Patterson
12	Anna Caballero	31	Joaquin Arambula
14	Melissa Hurtado	-	
-		-	
-		-	
-		-	
-		-	
-		-	

PART F. LETTERS OF SUPPORT

List all letters of support received for the proposed project.

Name/Agency	Name/Agency
Fresno Council of Governments	
Fresno County Rural Transit Agency	
Housing & Comm. Dev. Community Advisory Committ	
Del Rey Community Services District	
Laton Community Services District	



Sustainable Transportation Planning Grant Program

GRANT APPLICATION SIGNATURE PAGE

If selected for funding, the information contained in this application will become the foundation of the contract with Caltrans.

To the best of my knowledge, all information contained in this application is true and correct. If awarded a grant with Caltrans, I agree that I will adhere to the program guidelines.

Applicant			
Authorized Official (Applicant)			
Print Full Name	Steven E. White, PE, PLS		
Title	Director, Department of Public Works and Planning		
Signature	Steve White <small>Digitally signed by Steve White Date: 2021.10.26 17:59:02 -07'00'</small>	Date	
Sub-Applicant(s)*			
Authorized Official (Sub-Applicant)			
Print Full Name			
Title			
Signature		Date	
Authorized Official (Sub-Applicant)			
Print Full Name			
Title			
Signature		Date	
Authorized Official (Sub-Applicant)			
Print Full Name			
Title			
Signature		Date	

*Use additional pages if necessary.



Sustainable Transportation Planning Grant Program
SUSTAINABLE COMMUNITIES - GRANT APPLICATION
NARRATIVE

PART G. APPLICATION NARRATIVE

FY 2022-23

Project Information

Organization (legal name)	County of Fresno, Department of Public Works & Planning
Project Title	Multi-modal Planning & Research for DUCs within the County of Fresno
Project Area Boundaries	County of Fresno

Application Narrative

1. Project Description (10 points)

Briefly summarize project in a clear and concise manner, including why the project is necessary, major deliverables, parties involved, and any connections to relevant local, regional, and/or State planning efforts. **Do not exceed the space provided.**

The County of Fresno (County) has identified the need for a more comprehensive plan to select local communities in which to focus efforts on infrastructure project identification and implementation. The projects that are generated by this study will be considered for selection for state and federal grants such as the Active Transportation Program (ATP), Congestion Mitigation and Air Quality program (CMAQ), Surface Transportation Block Grant program (STBG), and others.

The funding, if awarded, will be used to hire a consultant who will be tasked with investigating and analyzing the needs of the County's Disadvantaged Unincorporated Communities (DUCs) and provide the necessary information to identify those areas within the County most in need of infrastructure improvements. The County will make available supplemental funding such Measure C (Bicycle, Pedestrian, Urban & Rural trails, etc.) for the local match.

The parties involved include the County, Fresno Council of Governments (FCOG), California Department of Transportation (Caltrans), and Consultant(s) to be determined.



Sustainable Transportation Planning Grant Program

SUSTAINABLE COMMUNITIES - GRANT APPLICATION

NARRATIVE

2A. Project Justification (15 points)

- Describe the problems or deficiencies the project is attempting to address, as well as how the project will address the identified problems or deficiencies
- List the ramifications of not funding this project
- Clearly define the existing issues surrounding the project (e.g., transportation issues, inadequate transit services, impacts of heavy trucking on local streets, air pollution, etc.)
- Competitive applications support the need for the project with empirical data
- Describe how this project addresses issues raised
- Define the public benefit
- Explain how the public was involved with identifying issues
- Describe the impact of not funding the project
- **Do not exceed the space provided**

In order to satisfy the requirements of the present-day regional, state, and federal grant opportunities, there is a need for a study to identify which DUCs should be the focus of future infrastructure grant opportunities. The study would use research methods to address the effects of climate change, transportation integration, and social equity. This project will launch a comprehensive study to advance efforts toward the creation of a master project index which will provide details of the transportation needs of DUCs throughout the County. These communities will be studied regarding safety and reconstruction/rehabilitation of vehicular, bicycling, and pedestrian transportation facilities.

If the scoring committee decides not to fund this project, the County will continue to strive towards serving its DUCs; although, a study into which communities should be prioritized for optimal grant applications is needed if the County is to efficiently comply with recent State legislation regarding climate change, reducing greenhouse gases, and addressing social inequity. It is imperative that local government agencies be able to keep up with our changing world in order to serve its disadvantaged citizens more comprehensively.

The primary function of the County's Department of Public Works & Planning (PWP) is to protect and improve the investment in public infrastructure for its citizens. Currently, there are approximately 3,555 miles of roadway in unincorporated Fresno County (the most of any county in California) along with 544 bridges, providing for the safe and efficient movement of people and goods throughout the County. Many of the County's DUCs lack affordable low income housing, bicycling and pedestrian facilities, access to public transit, and adequately maintained roads. These communities lack the requisites and/or resources to qualify for public funding on their own, so the County must step in and provide the necessary improvements. Due to the limited amount of funding received from State entities, the County is unable to provide these improvements without the assistance of public grant funding.

The objective of this project is to gather empirical data to increase the County's understanding of the transportation needs of its DUCs and pursue avenues to rectify transportation infrastructure deficiencies in those communities. The data gathered may include commute patterns, accessibility, access to job centers, or Vehicle Miles Traveled (VMT) and Average Daily Traffic (ADT) data to show where the communities' biggest needs lie. The data included in Attachment I



Sustainable Transportation Planning Grant Program
SUSTAINABLE COMMUNITIES - GRANT APPLICATION
NARRATIVE

2A. Project Justification (continued)

The current methods of project identification the County employs is in need of updating to a more modern approach through advanced planning and research outlets. The funding, if awarded, will be used to hire a consultant who will have to ability to research more deeply the transportation needs of the County's DUCs.

The project is intended to foster material positive impact on DUCs within the County's jurisdiction. The information acquired by the study will provide the necessary information to identify those areas within the County most in need of transportation infrastructure improvements that will be eligible for state and federal grants, such as the Active Transportation Program (ATP), Highway Safety Improvement Program (HSIP), Congestion Mitigation and Air Quality program (CMAQ), Surface Transportation Block Grant program (STBG), and Highway Bridge Program (HBP) (others?). By providing these types of projects for the County's citizens, it will ensure a safer and more sustainable future for those living in DUCs.

Letters of support have been attained from various communities and are attached as Attachment F.

Should the project not be funded, the County will be limited in its ability to address the needs of its 36 DUCs. This study is one of the top priorities of the County in order to more thoroughly understand the needs of its DUCs (Attachment A). If partial funding is allowed, the County would strive to maximize the funding granted to, at the very least, complete the County's Active Transportation Plan (estimated \$200,000 need). Any project costs beyond \$200,000 would be utilized to identify, prioritize, and prepare application-ready projects for future funding opportunities. Current statistical data such as pedestrian-vehicle injuries and crashes with fatalities have been included in Attachment D.



Sustainable Transportation Planning Grant Program
SUSTAINABLE COMMUNITIES - GRANT APPLICATION
NARRATIVE

2B. Disadvantaged Communities Justification (5 points) - Do not exceed the space provided

- Explain how the project area or portions of the project area are defined as a disadvantaged community, including Native American Tribal Governments and rural communities
- Explain how the proposed project addresses the needs of the disadvantaged community
- Describe how disadvantaged communities will benefit from the proposed planning project
- The tools in Grant Application Guide, Appendix A, are intended to help applicants define a disadvantaged community. Cite data sources, the tools used, and include a comparison to the statewide thresholds that are established in each tool

The County identified its DUCs using current U.S. Census Tract data and recent independent studies. The DUCs are identified as those being below 80% of the statewide median household income (MHI) of \$75,235. The entire County's MHI is \$53,969, which is well below the state's MHI. For each DUC within the County's jurisdiction, the MHI fell below even the County's MHI. The average of the combined 36 DUCs within the County is \$35,862 (See Attachment G). Many of the County's DUCs are lacking a community services district. The study will identify which communities require projects that improve pedestrian and cycling facilities and road repairs. In DUCs that have no pedestrian facilities, flooding during the rainy months is an issue for children and other pedestrians because they oftentimes resort to walking in the road alongside vehicles, jeopardizing public safety. Many DUCs haven't seen any road repairs in decades due to ineligibility for certain public funding grants. The project will identify and prioritize which DUCs to focus on for future transportation related public funding grants. This will allow the County to apply for funding in the areas most in need of transportation improvements. The DUCs will benefit from the proposed project by providing safe walking paths between neighborhoods and schools, improved bicycling facilities, and smoother roadways to improve safety for both drivers and pedestrians.

2C. Disadvantaged Communities Engagement (5 points) - Do not exceed the space provided

- Describe how the proposed effort would engage disadvantaged communities, including Native American Tribal Governments and rural communities. Include specific outreach methods for involving disadvantaged communities
- Describe how disadvantaged communities will continue to be engaged during the next phases after the proposed planning project is complete, including project implementation. See Grant Application Guide, Appendix A, for best practices in community engagement

The residents of the DUCs to be studied are eager to share their stories and experiences. The County's goal with the proposed study is to become a collaborator with these communities in order to meet their transportation needs in the most efficient way possible.

While the number of communities in need are overwhelming, The study will assist the County with enhancing the lines of communication with the various DUCs. Moving forward, the County will need to justify to its stakeholders why one DUC receives priority over another. With limited resources and a widespread need throughout the County, there is a need to prioritize projects absent of outside bias as to which community receives resources in order of greatest efficient use of County resources. The study will be a valuable tool in its future communication with the County's DUCs and its stakeholders.



Sustainable Transportation Planning Grant Program

SUSTAINABLE COMMUNITIES - GRANT APPLICATION

NARRATIVE

3. Grant Specific Objectives (Total 35 points)

Integrate the following Grant Program Considerations (Grant Application Guide, Chapter 1.2) in the responses for 3A-G below, as applicable:

- Caltrans Strategic Management Plan
- California Transportation Plan (CTP)
- Modal Plans that Support the CTP
- Title VI and Environmental Justice
- Climate Action Plan for Transportation Infrastructure

3A. Grant Specific Objectives (5 points) - Do not exceed the space provided

- Explain how the proposal encourages local and regional multimodal transportation, housing and land use planning that furthers the region's RTP SCS (where applicable)
- Demonstrate how the proposed effort would coordinate transportation, housing, and land use planning components of the project to inform one another (i.e., regular coordination meetings between responsible entities, joint community meetings, letters of commitment from all relevant implementing agencies, etc.)
- Explain how the proposed effort would contribute to shifts in land use towards more sustainable and equitable communities, such as more affordable housing near transit or more compact regional development patterns (Reference Grant Application Guide, Chapter 2.2, for example project types)

This study an important step toward integrating the County's Trails Master Plan with FCOG's Regional Active Transportation Plan and Caltrans' long-range modal statewide plan. The study will satisfy the provisions of the Caltrans 2020-2024 Strategic Plan by focusing its efforts toward more socially and environmentally responsible methods of project identification. The project is also in line with the California Transportation Plan 2050 in that the study will help guide the County's transportation decisions and grant applications moving forward to meet our future multi modal mobility needs and reduce greenhouse gas emissions.

To satisfy the requirements of all the present-day regional, state, and federal grant opportunities, there is a need for such a study to identify which communities should be the focus of future grant opportunities. The study would use research methods which address the effects of climate change, transportation integration, and social equity. The outcome of the study should result in stronger partnerships with the County's stakeholders.



Sustainable Transportation Planning Grant Program
SUSTAINABLE COMMUNITIES - GRANT APPLICATION
NARRATIVE

3B. Grant Specific Objectives (5 points)- Do not exceed the space provided

- Explain how the proposal contributes to the State's GHG reduction targets and advances transportation related GHG emission reduction project types/strategies (i.e., mode shift, demand management, travel cost, operational efficiency, accessibility, and coordination with future employment and residential land use, etc.)

The west side of Fresno County contains some of the of the most pollution-burdened census tracts in the state (see Attachment E). These neighborhoods rank high for fine particulate matter in the air, pesticide exposure and contaminated drinking water, as well as high rates of poverty, unemployment, asthma, low birth weight and cardiovascular disease.

Fresno County has the most road miles of any other county in California (See Attachment H). Most of the gas tax, however is distributed based on an area's population and not road miles. As a result, there isn't enough funding to make the necessary improvements in each community with gas tax funding alone. The deferred costs of road and sidewalk maintenance are estimated at approximately \$1 billion.

The data provided on Attachment I shows the VMT conditions for the 36 DUCs in Fresno County. The counts reflect a high exiting VMT due to a lack of multi-modal options as residents of the DUCs rely solely on individual vehicles to get around. The study will help identify how the communities would benefit most from transportation infrastructure improvements which will help lower VMTs, reduce PM 2.5 contaminants and GHG emissions, and target which communities would have the most success with future grant opportunities.

3C. Grant Specific Objectives (5 points) - Do not exceed the space provided

- Explain how the proposal supports other State goals, including but not limited to:
 - State Planning Priorities (Government Code Section 65041.1)
 - Climate Adaptation Goals (Safeguarding California)
 - Goals and Best Practices cited in the 2017 RTP Guidelines, Appendices K and L

In keeping with California's planning priorities, the study will examine current data and emerging data trends to consider future issues and challenges for the County's DUCs. Similar to a general plan, the study will provide a basis of the County to make decisions regarding where infrastructure improvements are the most needed and which will minimize ongoing costs to taxpayers.

The study will discuss how the prioritized infrastructure improvements in the County's DUCs will assist in achieving California's Climate Action Plan for Transportation Infrastructure (CAPTI). The projects resulting from the County's study will not only combat and adapt to climate change by researching ways to target GHG emissions among the County's transportation facilities, but also strive to support public health, safety, and social equity.

In order to comply with the Goals and Best Practices cited in the 2017 RTP Guidelines, the study will identify projects which increase physical activity and active transportation, reduce collision injuries and fatalities, minimize air pollution, and contribute to the overall health and well-being of residents in the County's DUCs.



Sustainable Transportation Planning Grant Program
SUSTAINABLE COMMUNITIES - GRANT APPLICATION
NARRATIVE

3D. Grant Specific Objectives (5 points) - Do not exceed the space provided

- Explain how the proposal encourages stakeholder involvement
 - List the stakeholders involved in the planning effort (e.g., first responders, community-based organizations, local housing and public health departments, transit agencies, and partners including State, federal, local agencies)
 - Explain how stakeholders will be involved throughout the project

The study will engage divisions within PWP, such as the Community Development Division, the Development Services Division, the Road Maintenance and Operations Division. Outside of PWP, the County's Department of Public Health will be engaged to assist in health data acquired from the various DUCs. The study will also engage FCOG's resources and data from the U.S. Census Bureau to pinpoint exactly which communities are most in need of improvements. Other agencies which may be involved in the study include the San Joaquin Valley Air Pollution Control District and the Fresno County Housing Authority.

The County believes that also involving any of the DUCs' community services districts, as well as their residents, will lead to a better process, greater community support, and more ideas on the table. The study will result in a better understanding of these communities with a participatory process which will foster an overall more effective effort to take advantage of all the possible advantages brought by infrastructure improvements.

3E. Grant Specific Objectives (5 points) - Do not exceed the space provided

- Explain how the proposal involves active community engagement
- Describe the specific public outreach methods/events that will be employed in the project
- Explain how public input will inform the project
- Describe how the effort will survey the public at the end of each outreach event to gauge effectiveness of these activities for the planning effort

The proposed study will be designed to promote active community engagement in the form of outreach efforts, which may include public information meetings, interactive surveys, community-based participatory research, community or professional workshops, and engagement with local boards and/or committees. The input from these sources is intended be valuable to the County as a whole so that all residents can benefit from the various options available as a result of the study.



Sustainable Transportation Planning Grant Program
SUSTAINABLE COMMUNITIES - GRANT APPLICATION
NARRATIVE

3F. Grant Specific Objectives (5 points) - Do not exceed the space provided

- Explain how the proposal assists in achieving the Caltrans Mission and Grant Program Objectives (Grant Application Guide, Chapter 1.2): Sustainability, Preservation, Accessibility, Safety, Innovation, Economy, Health, and Social Equity, as applicable

The proposed study will address sustainability issues by identifying the DUCs most in need of reliable and efficient mobility of people, goods, and services, while meeting the State's GHG emission reduction goals. Preservation of the County's transportation systems is vital to the long-term success of its transportation planning goals by identifying projects which will enhance the quality of life and environmental health of the DUC residents. By pinpointing which areas need an increase in pedestrian and bicycle facilities, safer intersections, and road repairs, the study will not only improve the mobility of all DUC residents, but enhance safety and security of the transportation system for motorized and active transportation users. The study will seek to promote the best use of technology and innovative designs to improve the performance and social equity of our transportation system and provide sustainable transportation options. The resulting projects will support the economic vitality of the DUCs identified for improvements by easing obstacles to multi-modal travel within the communities to various local destinations such as businesses, schools, community centers, and services. The improvements to DUC transportation systems will decrease exposure to local pollution sources, reduce serious injuries and fatalities, and promote physical activity, thereby enhancing health, longevity, and quality of life. Transportation solutions that focus on and prioritize the needs of the County's DUCs will mitigate the challenges of social equity by encouraging residents to participate in the transportation decision-making process.

3G. Grant Specific Objectives (5 points) - Do not exceed the space provided

- Explain how the proposal ultimately results in funded and programmed multimodal transportation system improvements. Applicants should discuss next steps for project implementation, including timing for programming improvements that would result from the planning effort

One focus of the proposed study will be to examine next steps to prepare the transportation infrastructure, coordinate with the stakeholders involved in implementation, recommend solutions to transportation infrastructure challenges, and apply those solutions to rectify the needs of the DUCs. The data generated by the study may result in implementation of new ideas, processes, and procedures to provide efficient methods of producing transportation infrastructure improvements and monitoring those improvements in the long term.



Sustainable Transportation Planning Grant Program
SUSTAINABLE COMMUNITIES - GRANT APPLICATION
NARRATIVE

<p>4. Project Management (Total 30 points)</p> <p>See Scope of Work and Cost and Schedule samples and checklists for requirements (Grant Application Guide, Appendix B), also available on the Caltrans grants website: https://dot.ca.gov/programs/transportation-planning/regional-planning/sustainable-transportation-planning-grants</p>
<p>4A. Scope of Work (15 points)</p>
<p>4B. Cost and Schedule (15 points)</p>

SCOPE OF WORK

Project Information	
Grant Category	Sustainable Transportation Planning Grant
Grant Fiscal Year	2022-23
Project Title	Multi-modal Planning & Research for DUCs within the County of Fresno
Organization (legal name)	County of Fresno, Department of Public Works and Planning

Introduction

The County of Fresno (County) has identified the need for a more comprehensive plan to select local communities in which to focus efforts on infrastructure project identification and implementation. The projects that are generated by this study will be considered for selection for state and federal grants such as the Active Transportation Program (ATP), Congestion Mitigation and Air Quality program (CMAQ), Surface Transportation Block Grant program (STBG), and others.

The funding, if awarded, will be used to hire a consultant who will be tasked with investigating and analyzing the needs of the County's Disadvantaged Unincorporated Communities (DUCs) and provide the necessary information to identify those areas within the County most in need of infrastructure improvements. The County will make available supplemental funding such Measure C (Bicycle, Pedestrian, Urban & Rural trails, etc.) for the local match.

Project Stakeholders

The Project Stakeholders include, but are not limited to, the County's Department of Public Health (FCDPH), Fresno Council of Governments (FCOG), San Joaquin Valley Air Pollution Control District (SJVAPCD), the Fresno County Housing Authority (FCHA), California Department of Transportation (Caltrans), and Consultant(s) to be determined.

FCDPH will be engaged to assist in health data acquired from the various DUCs. The study will also engage FCOG's resources and data from the U.S. Census Bureau to pinpoint exactly which communities are most in need of improvements. SJVPCD will be a valuable resource of data which would be integrated into the study to determine the best methods of tackling air quality issues in the County. FCHA will play an integral part in providing statistics and data for the County's DUCs which will help determine which areas would most benefit from transportation improvements that may lead to greater availability of low-income housing. Caltrans may be asked to assist with infrastructure improvements which may affect state highway facilities, as well as routine funding authorizations for the grant and the various projects which may be generated from the study. Additionally, many of the County's DUCs have community services districts in place, and partnership with those agencies will be vital to the outcome of the study.

Overall Project Objectives

Sustainability

The proposed study will address sustainability issues by identifying the DUCs most in need of reliable and efficient mobility of people, goods, and services, while meeting the State's GHG emission reduction goals.

Preservation

Preservation of the County's transportation systems is vital to the long-term success of its transportation planning goals identifying projects which will enhance the quality of life and environmental health of the County's DUCs.

Accessibility

The study will examine potential methods to increase accessibility within the County's transportation infrastructure and ways to improve mobility of people in the County's DUCs, inclusive of those with disabilities and/or socio-economic disadvantage.

Safety

The safety and security of its citizens are a priority for the County. The study will aim to increase the safety and security of its DUCs' transportation system for motorized and active transportation users.

Innovation

A valuable portion of the study would be the investigation of potential technology and innovative designs which may improve the performance and social equity of the County's transportation system, as well as provide sustainable transportation options.

Economy

The projects generated from the proposed study would focus on improving transportation efficiency among the County's DUCs, which would increase the economic vitality and equity of these communities by offering residents outlets to reduce barriers to employment through transportation infrastructure improvements.

Health

The proposed study will focus on recommending projects that decrease exposure to local pollution sources, reduce serious injuries and fatalities on the transportation system, and promote physical activity across the lifespan, inclusive of those with disabilities, especially through transportation means.

Social Equity

The projects that are recommended by the proposed study will promote transportation solutions that focus on and prioritize the needs of disadvantaged communities most affected by poverty, air pollution and climate change. The projects will focus on solutions that integrate community values with transportation safety and performance while encouraging meaningful public involvement in the transportation decision making process. Transportation solutions that focus on and prioritize the needs of the County's DUCs will mitigate the challenges of social equity by encouraging residents to participate in the transportation decision-making process.

Summary of Project Tasks

Project management activities must be identified within the task they occur.

TASK 01: Project Administration

This is an Administrative Task that shall only be charged against by the Grantee for the Administration of this grant project. Costs for this task cannot exceed 5% of the grant award amount.

Grantee will manage and administer the grant project according to the Grant Application Guidelines, Regional Planning Handbook, and the executed grant contract between Caltrans and the Grantee.

Task Deliverables

- Kick-off meeting with Caltrans – Meeting Notes
- Quarterly invoices and progress reports

Task 02: Consultant Procurement

The County will procure a consultant, consistent with state and federal requirements, Local Assistance Procedures Manual for procuring Architectural and Engineering & Related consultants, the Grant Application Guide, Regional Planning Handbook, and the executed grant contract between Caltrans and the grantee.

Task Deliverables

- Provide current procurement procedures
- Copy of the Request for Proposal
- Copy of the contract between consultant and grantee, and all amendments to the consultant contract
- Meeting notes from project kick-off with consultant

TASK 1: EXISTING CONDITIONS

The consultant will inventory existing roads, sidewalks, bike lanes, and lack thereof in 36 disadvantaged communities.

Task Deliverables

- Gather Data on Existing Transportation Facilities in Disadvantaged Unincorporated Communities (DUCs)
- Review Existing Plans
- Create a Comprehensive Map of Transportation Facilities in DUCs
- Provide a report of Existing Conditions Summary

TASK 2: ANALYSIS

The consultant will analyze the information and make recommendations on what improvements are needed, how much they cost, and develop an initial priority list.

Task Deliverables

Caltrans Sustainable Transportation Planning Grant Program

- Make recommendations for improvements to existing conditions
- Create initial cost estimates for improvements
- Develop initial priority list based on need and feasibility

TASK 3: PUBLIC OUTREACH

The project consultant and/or sub-consultant will be tasked with organizing a minimum of five public outreach events. Depending on the on-going needs of COVID these may be a combination of in person or virtual events. These events will provide an introductory event, a minimum of three feedback/progress events, and a final report event. Should funding and needs allow for additional feedback/progress events then those may be arranged for pending approval from the Grant facilitator(s).

Task Deliverables

- Develop strategy for public outreach, through use of social media, traditional media, and community-based organizations
- Produce surveys, flyers, and advertisements
- Provide outreach and meetings in multiple languages as needed
- Hold 5 meetings (combination of in-person and virtual) and present draft plan, priority list and conceptual drawings to the public
- Provide sign in sheets/proof of attendance
- Provide summary report of public outreach events and feedback received.

TASK 4: ADVISORY COMMITTEE MEETINGS

The project consultant and/or sub-consultant will be tasked with attending and presenting to advisory groups as needed or requested.

Task Deliverables

- Present Draft and, later, Final Plan at up to 4 advisory group meetings
- Preparation of Visual Media Presentation of Draft and Final Plans through slideshow or video
- Assisting with preparation of advance agenda material
- Give presentation and answer questions from the group, and incorporate recommendations when possible

TASK 5: FINANCIAL EVALUATION

The consultant will further develop cost estimates for projects and provide recommendations on funding sources to pay for improvements as well as to provide recommendations on funding mechanisms to maintain improvements.

Task Deliverables

- Provide Specific Cost Estimates
- Identify Resources for Construction/Maintenance
- Identify Partner Entities/Mechanisms
- Identify Alternative Funding Sources

TASK 6: DRAFT AND FINAL PLAN

Caltrans Sustainable Transportation Planning Grant Program

The consultant will prepare a draft plan based on their analysis and Feedback from County staff. The Consultant will prepare a final plan based on feedback received from public outreach, the Board of Supervisors, and County staff.

Task Deliverables

- Draft plan for County review – list of comments
- Draft Plan for Public Review – list of comments
- Draft Plan for Board of Supervisors Review – list of comments
- Final Plan that includes a summary of next steps towards implementation, a starting list of projects and their ranked prioritization based on most efficient use of funds and their potential scoring for future funding, credits FHWA, FTA, and/or Caltrans on the cover or title page, submitted to Caltrans in an ADA accessible electronic copy

TASK 7: BOARD REVIEW/APPROVAL

The project consultant and/or sub-consultant will be tasked with attending and presenting the Draft Plan and Final Plan to the Board of Supervisors, and potentially other oversight groups.

Task Deliverables

- Present Draft and later, Final Plan at the Board of Supervisors meetings
- Preparation of Visual Media Presentation of Draft and Final Plans through slideshow or video
- Assisting with preparation of advance agenda material
- Give presentation and answer questions from the Board, and defend recommendations
- Give presentations at up to 2 additional meetings if needed.

Task 8: DRAFT PROJECT FUNDING APPLICATIONS

The consultant will be tasked with utilizing any remaining grant funds to develop draft applications for potential funding from various sources. The number of applications will be determined by the priority list and the amount of available remaining funds from this grant.

Task Deliverables

- Project scope development
- Line item cost estimate
- 30% conceptual engineering design
- Cost/benefit calculations
- Funding opportunity specific supporting documentation pending matching project with the highest scoring potential funding sources.

California Department of Transportation
Sustainable Transportation Planning Grant Program
COST AND SCHEDULE

Sustainable Transportation Planning Grant
FY 22-23
Multi-modal Planning &
County of Fresno

Task #	Task Title	Grant Amount*	Estimated Local Cash Match*	Estimated Local In-Kind Match*	Estimated Total Project Cost*	FY 2022/23				FY 2023/24				FY 2024/25											
						J	A	S	O	N	D	J	F	M	A	M	J	J	A	S	O	N	D	J	F
01	Project Administration (no more than 5% of total grant funds)	\$0	\$0	\$20,000	\$20,000																				
02	Consultant Procurement	\$0	\$0	\$10,000	\$10,000																				
1	Existing Conditions	\$39,839	\$5,162	\$0	\$45,000																				
2	Analysis	\$44,265	\$5,735	\$0	\$50,000																				
3	Public Outreach	\$39,839	\$5,162	\$0	\$45,000																				
4	Advisory Committee Meetings	\$13,280	\$1,721	\$0	\$15,000																				
5	Financial Evaluation	\$26,559	\$3,441	\$0	\$30,000																				
6	Draft and Final Plan	\$72,595	\$9,405	\$0	\$82,000																				
7	Board Review/Approval	\$13,280	\$1,721	\$0	\$15,000																				
8	Draft Project Funding Applications	\$177,060	\$22,940	\$0	\$200,000																				
Totals		\$426,715	\$55,285	\$30,000	\$512,000																				

* Use only whole dollars in the financial information fields. Dollar amounts must be rounded up/down and decimals should not be shown.

Does your agency plan to request reimbursement for indirect costs? Yes No If yes, what is the estimated indirect cost rate? _____

Does your agency plan to use the Tapered Match approach for invoicing purposes? Yes No

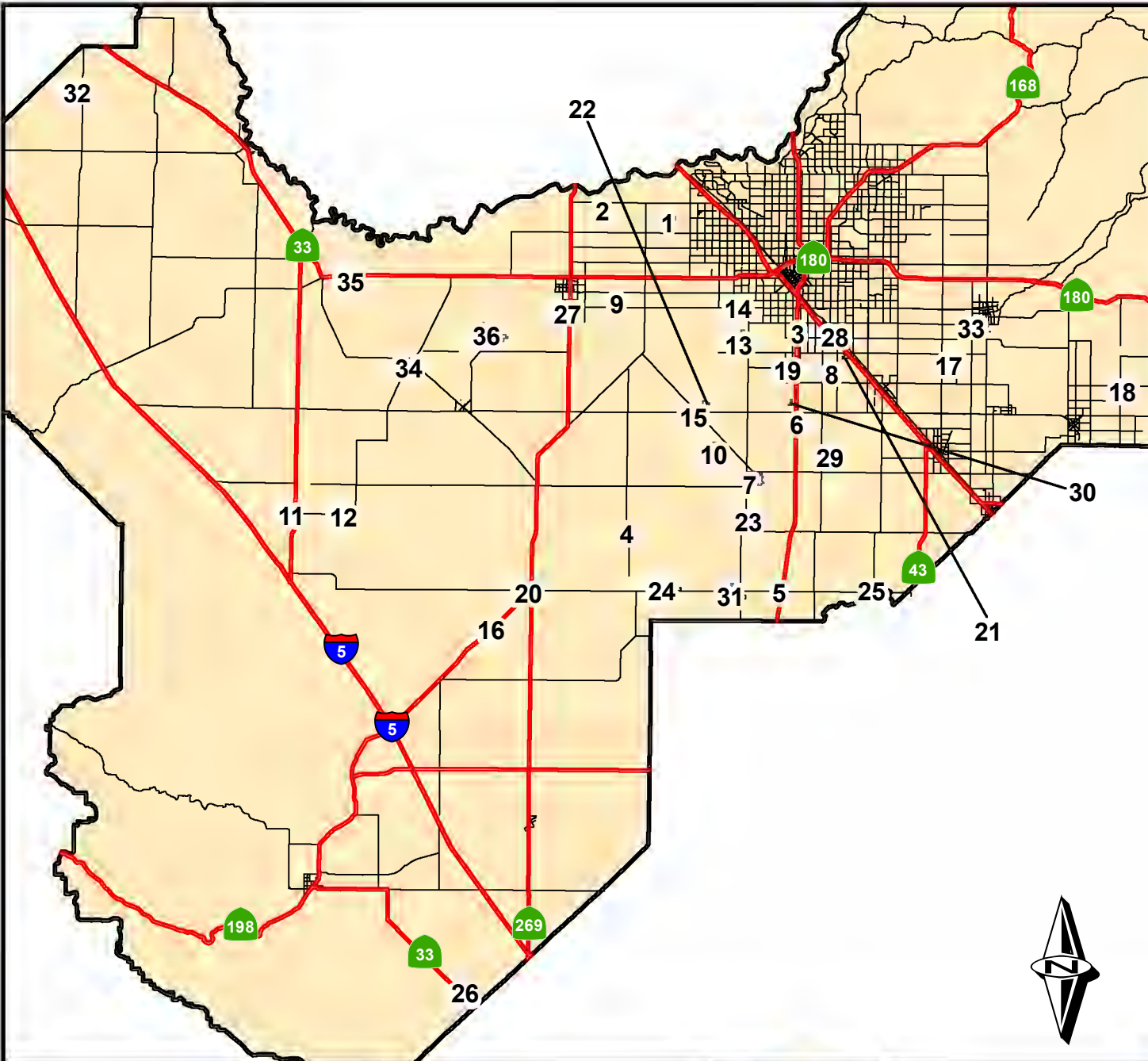

- COUNTY OF FRESNO
DISADVANTAGED UNINCORPORATED
COMMUNITIES**
1. ASHLAN AVENUE
 2. BIOLA
 3. BRITTEN AVENUE/CHERRY AVENUE
 4. BURREL
 5. CAMDEN AVENUE
 6. CARILLO AVENUE
 7. CARUTHERS
 8. CHESTNUT AVENUE - SHADY LAKES
 9. CHURCH AVENUE/FLOYD AVENUE
 10. CORNELIA AVENUE/FLORAL AVENUE
 11. CSA 30 - EL PORVENIR
 12. CSA 32 - CANTUA CREEK
 13. CSA 39 ZONE A
 14. CSA 39 ZONE B - WEST PARK
 15. CSA 43 - RAISIN CITY
 16. CSA 49 - O'NEILL FARMS/WESTSIDE
 17. DEL REY
 18. EAST ADAMS AVENUE
 19. EASTON
 20. FIVE POINTS
 21. FLAMINGO MOBILE HOME
 22. HAYES ROAD/PERRIN COLONY
 23. HUGHES AVENUE/MAGNOLIA AVENUE
 24. LANARE
 25. LATON
 26. LOST HILLS
 27. MADERA AVENUE
 28. MALAGA
 29. MONMOUTH
 30. PARLIER AVENUE/ELM AVENUE
 31. RIVERDALE
 32. RUSSELL AVENUE
 33. TOMBSTONE TERRITORY
 34. TRANQUILLITY
 35. WHITESBRIDGE
 36. YUBA AVENUE

	DATE
DESIGNED: C.M.	10/19/2021
DRAWN: C.M.	10/19/2021
CHECKED BY:	

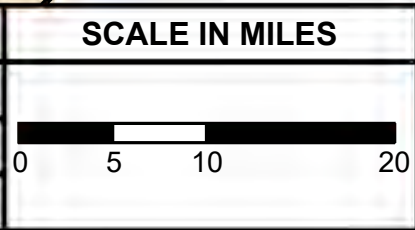

DEPARTMENT OF PUBLIC WORKS & PLANNING

COUNTY OF FRESNO
DISADVANTAGED UNINCORPORATED COMMUNITIES

ATTACHMENT A



County of Fresno
Disadvantaged Unincorporated Communities 2020

IDENTIFIED DISADVANTAGED UNINCORPORATED COMMUNITIES FRESNO COUNTY		
Name	Size (acres)	Parcels
1. Ashlan Avenue Community	57	18
2. Biola Community	242	335
3. Britten Avenue/Cherry Avenue Community	20	26
4. Burrel Community	12	26
5. Camden Avenue Community	4	1
6. Carillo Avenue Community	20	28
7. Caruthers Community	453	787
8. Chesnut Avenue Community – Shady Lakes	26	2
9. Church Avenue/Floyd Avenue Community	44	36
10. Cornelia Avenue/Floral Avenue Community	60	38
11. CSA 30 Community – El Porvenir	29	61
12. CSA 32 Community – Cantua Creek	80	79
13. CSA 39 Zone A Community	19	52
14. CSA 39 Zone B Community	51	111
15. CSA 43 Community – Raisin City	38	75
16. CSA 49 Community – O’Neill Farms/Westside	93	15
17. Del Rey Community	108	316
18. East Adams Avenue Community	9	18
19. Easton Community	701	522
20. Five Points Community	16	3
21. Flamingo Mobile Home Community	9	1
22. Hayes Road Community/Perrin Colony	54	42
23. Hughes Avenue/Magnolia Avenue Community	40	30
24. Lanare Community	51	346
25. Laton Community	251	510
26. Lost Hills Community	172	162
27. Madera Avenue Community	22	27
28. Malaga Community	72	232
29. Monmouth Community	15	36
30. Parlier Avenue/Elm Avenue Community	36	30
31. Riverdale Community	501	1,042
32. Russell Avenue Community	158	51
33. Tombstone Territory	57	50
34. Tranquillity Community	157	296
35. Whitesbridge Community	139	24
36. Yuba Avenue Community	633	118

ATTACHMENT B

Disadvantaged Unincorporated Communities – County of Fresno 2020

PHOTOS

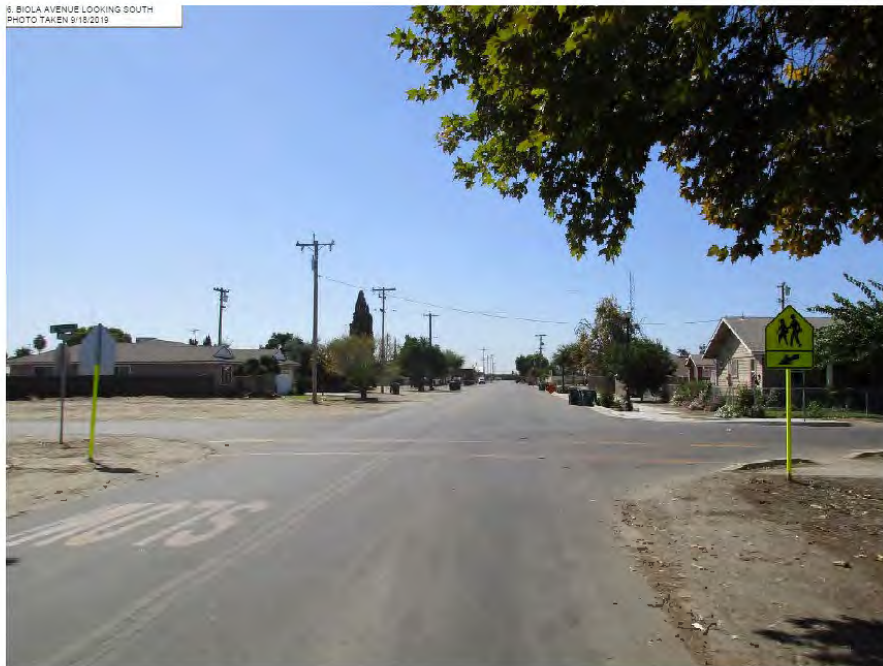

View of Biola Avenue looking South, which is located in the Community of Biola.



View of Britten Avenue looking East in The Britten Avenue/Cherry Avenues Community

ATTACHMENT B

Disadvantaged Unincorporated Communities – County of Fresno 2020

PHOTOS



View looking West down Carillo from Angus in Carillo Avenue Community



View of Prospect Avenue looking North (March 11, 2020) in the West Park Community

ATTACHMENT B

Disadvantaged Unincorporated Communities – County of Fresno 2020

PHOTOS



The view of Fike Avenue looking West in community of Raisin City, with Raisin City Holiness Church (on right)



View of northbound SR 145 in the community of O'Neill Farms (located on the Westside of the County) – School Bus Facility to West

ATTACHMENT B

Disadvantaged Unincorporated Communities – County of Fresno 2020

PHOTOS



The view from West Excelsior Avenue looking West in the community of O'Neill Farms (located on the Westside of the County)

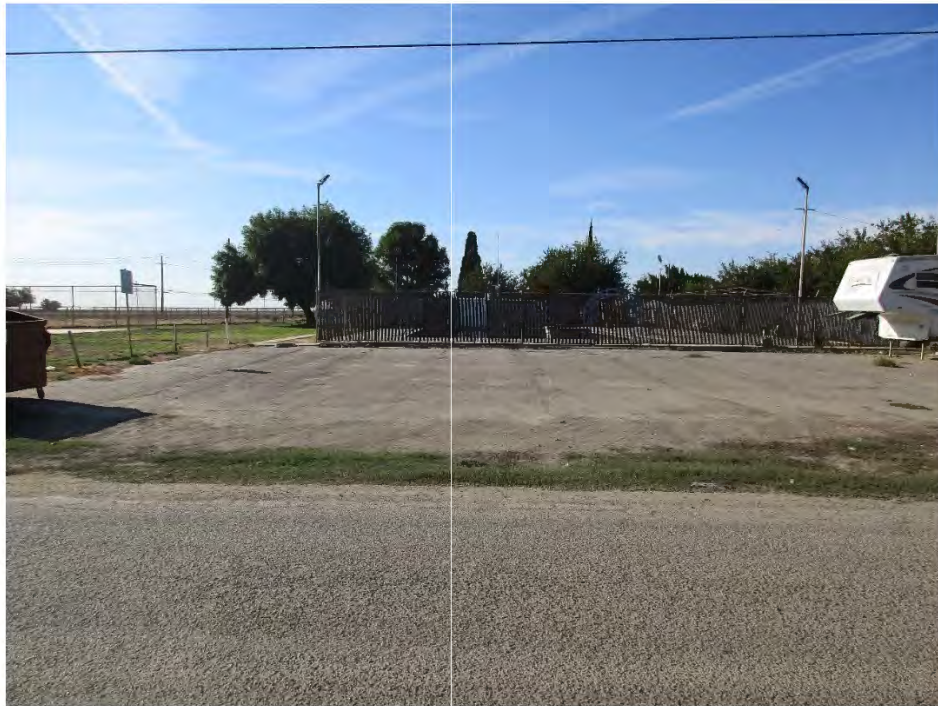

View from West Excelsior Avenue looking South in the community of O'Neill Farms (located on the Westside of the County)

ATTACHMENT B

Disadvantaged Unincorporated Communities – County of Fresno 2020

PHOTOS



View from West Excelsior Avenue looking West in the community of O'Neill Farms
(located on the Westside of the County)



View from looking West down Adams Avenue from the Most Easterly Lot,
which is located in the East Adams Avenue Community

ATTACHMENT B

Disadvantaged Unincorporated Communities – County of Fresno 2020

PHOTOS



View of Lincoln Avenue looking East in the Community of Easton



View of Elm Avenue looking South in the Community of Easton

ATTACHMENT B

Disadvantaged Unincorporated Communities – County of Fresno 2020

PHOTOS



View of Northerly Road looking East Five Points Community



View of Northerly Road looking East in Hayes Road Community

ATTACHMENT B

Disadvantaged Unincorporated Communities – County of Fresno 2020

PHOTOS



View of Murphy Avenue looking Northeast in the Community of Laton



View of Armstrong Avenue looking South in the Community of Laton

ATTACHMENT B

Disadvantaged Unincorporated Communities – County of Fresno 2020

PHOTOS



View of Latonia Street looking Southwest Latonia Street



View of Gould Avenue looking Southwest in the Community of Malaga

ATTACHMENT B

Disadvantaged Unincorporated Communities – County of Fresno 2020

PHOTOS



View looking East down Avenell from Topeka in Monmouth Community



View looking South down Chestnut from Overholser in Monmouth Community

ATTACHMENT B

Disadvantaged Unincorporated Communities – County of Fresno 2020

PHOTOS



View looking North down Chestnut from South of Avenell in Monmouth Community



View of Sherrill and Earl Streets (March 23, 2020) in the Community of Riverdale

ATTACHMENT B

Disadvantaged Unincorporated Communities – County of Fresno 2020

PHOTOS



The view of Mount Whitney in front of high school (March 23, 2020)
in the Community of Riverdale



The view of Mount Whitney (March 23, 2020) in the Community of Riverdale

ATTACHMENT B

Disadvantaged Unincorporated Communities – County of Fresno 2020

PHOTOS



View of Randolph Avenue Looking Northwest (March 23, 2020)
in the Community of Tranquillity



Inadequate Sidewalk near Tranquillity High School, corner of Daniels & Randolph

ATTACHMENT B

Disadvantaged Unincorporated Communities – County of Fresno 2020

PHOTOS



Intersection of Daniels & Scaggs in the community of Tranquillity



Daniels Ave near Tranquillity First United Church.

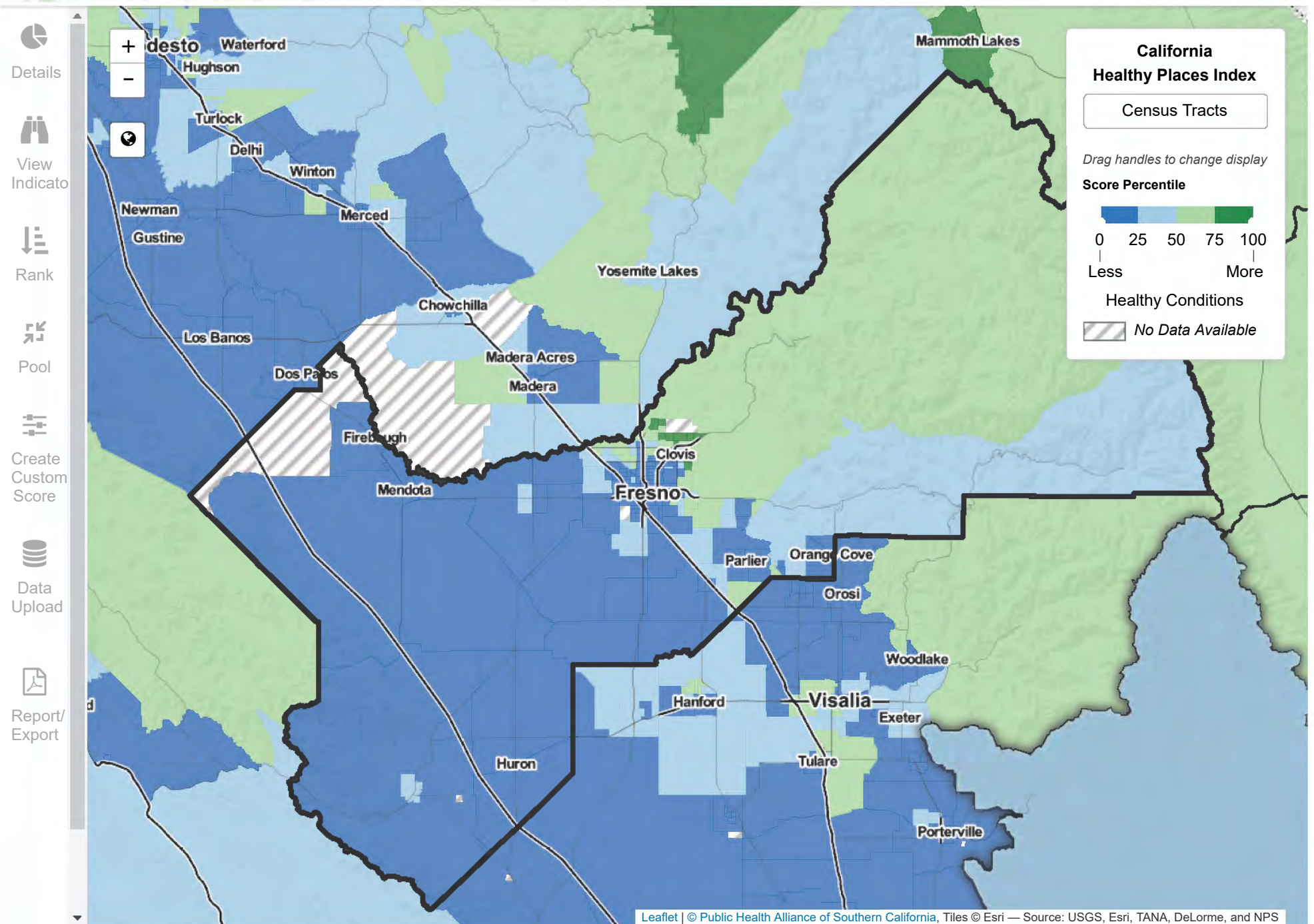

ATTACHMENT C

**COUNTY OF FRESNO
CALIFORNIA HEALTHY PLACES INDEX (HPI)**

DUC	HPI Score
Ashlan Avenue Community	21.6
Biola Community	21.6
Britten/Cherry Avenue	28.8
Burrel Community	12.5-15.7
Camden Avenue Community	15.7
Carillo Avenue Community	12.5
Caruthers	19.3
Chestnut Avenue/Shady Lakes	24.6
Church/Floyd Avenues	14.9
Cornelia/Floral Avenues	12.5-19.3
CSA 30/El Porvenir	0.8
CSA 32/Cantua Creek	3.3
CSA 39 Zone A	22.3
CSA 39 Zone B/West Park	22.3
CSA 43/Raisin City	12.5
CSA 49/O'Neill Farms/Westside	2.1
Del Rey	4.9
East Adams Avenue	48.4
Easton	28.8
Five Points	3.3
Flamingo Mobile Home Community	3.5
Hayes Road/Perrin Colony	12.5
Hughes/Magnolia Avenues	19.3
Lanare	15.7
Laton	11.6
Lost Hills	8.8
Madera Avenue	14.9
Malaga	3.5
Monmouth Community	21.5
Parlier/Elm Avenue	12.5
Riverdale	15.7
Russell Avenue	No data
Tombstone Territory	28.2
Tranquillity	3.3
Whitesbridge	3.3
Yuba Avenue	14.9

ATTACHMENT D

COUNTY OF FRESNO
COLLISION DATA (1/1/2018 to 10/15/21)

1. Ashlan Avenue Community

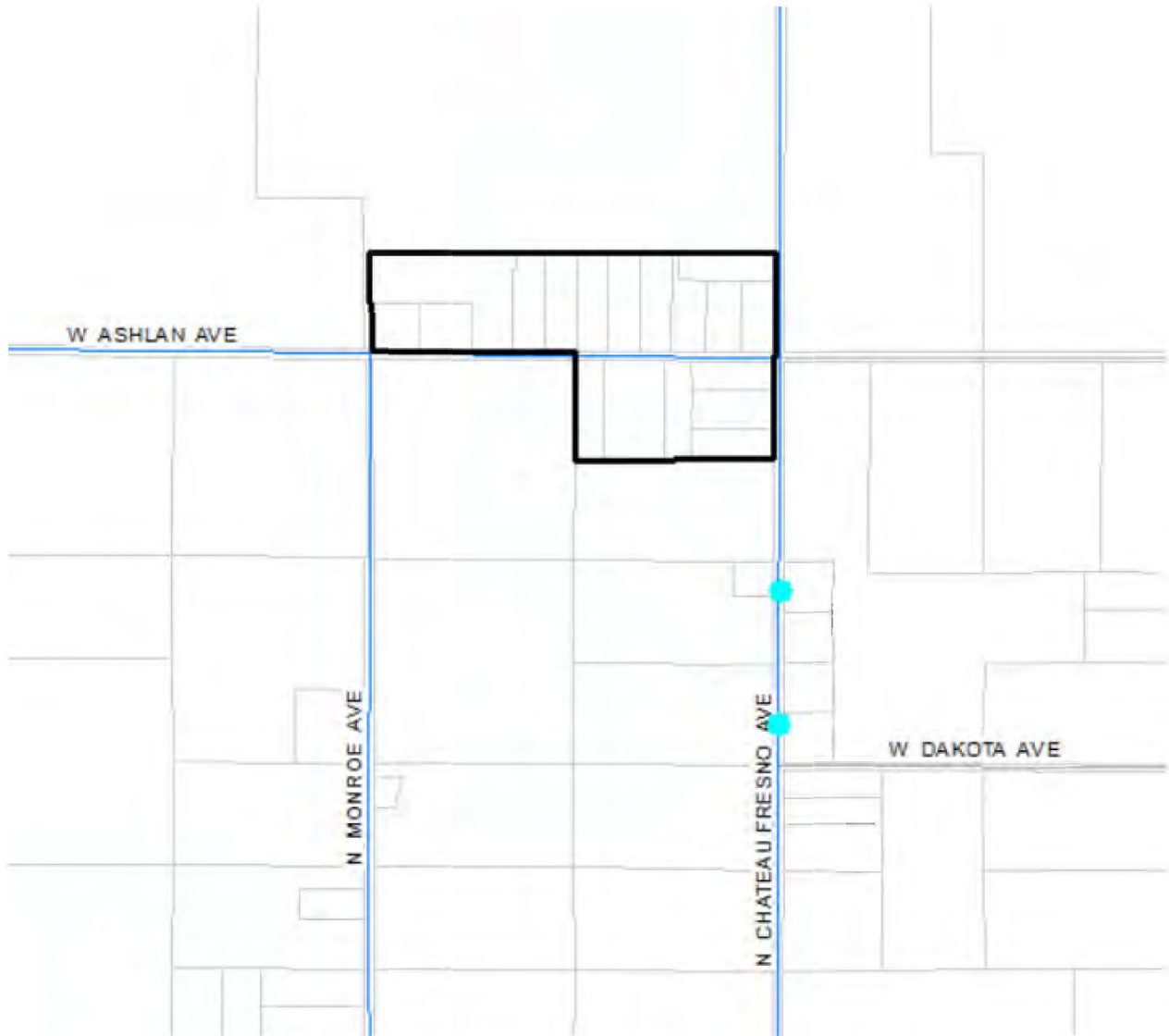

ReportNo	CollDate	CollTime	PriRoad	SecRoad	OfficerID *	NCICNo	Distance	Direction	InvolvedWi	CollType	PCF
9435201900054	1/7/2019	0611	CHATEAU FRESNO	DAKOTA	014672	9435	1108	North	Fixed Object	Hit Object	Improper Turning
9435201900283	1/18/2019	2500	CHATEAU FRESNO	DAKOTA	015751	9435	250	North	Fixed Object	Hit Object	Improper Turning

Collisions db (2 out of *2000 Selected)

COUNTY OF FRESNO
COLLISION DATA (1/1/2018 to 10/15/21)

2. Biola Community

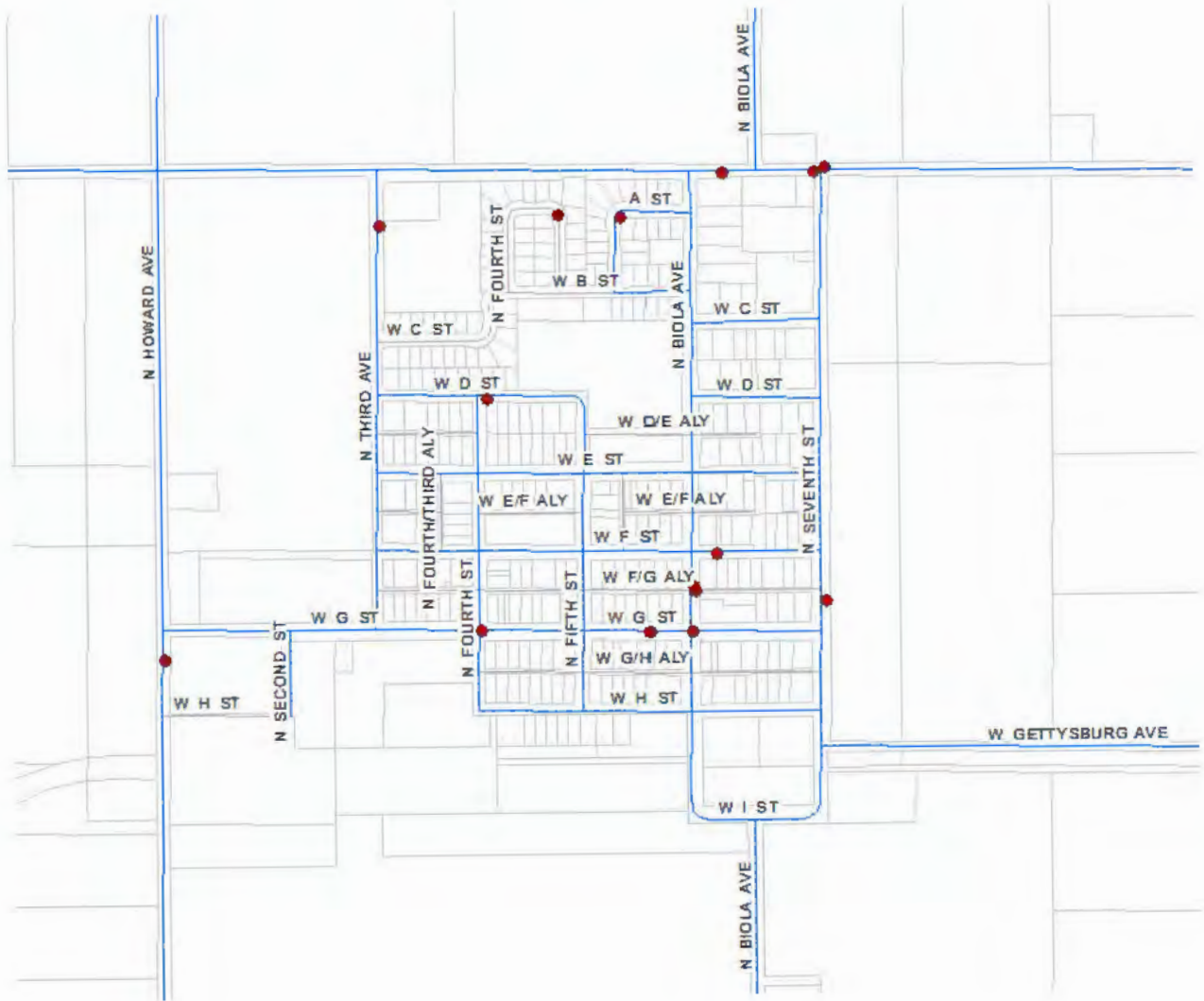

ATTACHMENT D

COUNTY OF FRESNO
COLLISION DATA (1/1/2018 to 10/15/21)

Biola Community

ReportNo	CollDate	CollTime	PriRoad	SecRoad	OfficerID *	NCICNo	Distance	Direction	InvolvedWi	CollType	PCF
9435201800378	1/29/2018	2005	HOWARD	G	019895	9435	100	South	Animal	Other	Other Than Driver
9435201802819	7/15/2018	2500	THIRD	SHAW	020680	9435	241	South	Other Motor Vehicle	Rear-End	Improper Turning
9435201803142	8/7/2018	2500	D	FOURTH (3)	014672	9435	20	East	Other Motor Vehicle	Sideswipe	Improper Turning
9435201803307	8/18/2018	2100	A	RAISIN	020078	9435	15	West	Parked Motor Vehicle	Broadside	Unsafe Speed
9435201804605	11/5/2018	0120	FIFTH	A	020062	9435	0	Not Stated	Parked Motor Vehicle	Broadside	Hazardous Parking
9435201900195	1/16/2019	1710	SHAW	SEVENTH	020733	9435	50	West	Other Motor Vehicle	Rear-End	Unsafe Speed
9435201913081	10/24/2019	1728	BIOLA	G	019789	9435	0	Not Stated	Other Motor Vehicle	Broadside	Auto R/W Violation
9435202000775	3/1/2020	1951	SEVENTH	G (N)	020481	9435	139	North	Fixed Object	HR Object	Improper Turning
9435202002386	7/16/2020	1200	BIOLA	G	015468	9435	180	North	Non-Collision	Sideswipe	Unsafe Starting or Backing
9435202002788	8/13/2020	1455	BIOLA	F	020871	9435	150	South	Fixed Object	HR Object	Improper Passing
9435202002815	8/15/2020	2220	F	BIOLA	019603	9435	103	East	Parked Motor Vehicle	Broadside	Improper Turning
9435202004511	12/4/2020	2500	SEVENTH	SHAW	020854	9435	20	North	Fixed Object	HR Object	Unsafe Speed
9435202100184	1/19/2021	2105	G	BIOLA	019603	9435	190	West	Parked Motor Vehicle	Rear-End	Unsafe Starting or Backing
9435202101123	3/27/2021	1610	G	FOURTH (W)	020387	9435	0	Not Stated	Other Motor Vehicle	Broadside	Unknown
9435202101747	5/2/2021	1930	SHAW	BIOLA (W)	019369	9435	130	East	Other Motor Vehicle	Broadside	Auto R/W Violation

Table Of Contents Table

ATTACHMENT D

COUNTY OF FRESNO
 COLLISION DATA (1/1/2018 to 10/15/21)

3. Britten Avenue / Cherry Avenue Community



ReportNo	CollDate	CollTime	PriRoad	SecRoad	OfficerID *	NCICNo	Distance	Direction	InvolvedWi	CollType	PCF
9435201800537	2/10/2018	1049	CHERRY	BRITTEN	018049	9435	20	North	Other Motor Vehicle	Rear-End	Unsafe Speed
9435201804323	10/16/2018	0640	CHERRY	BRITTEN	018912	9435	20	South	Other Object	Other	Other Than Driver
9435202003408	9/26/2020	1320	CHERRY	CENTRAL	020122	9435	2112	South	Other Motor Vehicle	Rear-End	Unsafe Speed
9435202110539	6/12/2021	1209	CHERRY	CENTRAL	015986	9435	1056	South	Other Motor Vehicle	Broadside	Auto R/W Violation

Table interface showing 4 out of 8325 Selected.

ATTACHMENT D

COUNTY OF FRESNO
 COLLISION DATA (1/1/2018 to 10/15/21)

4. Burrell Community

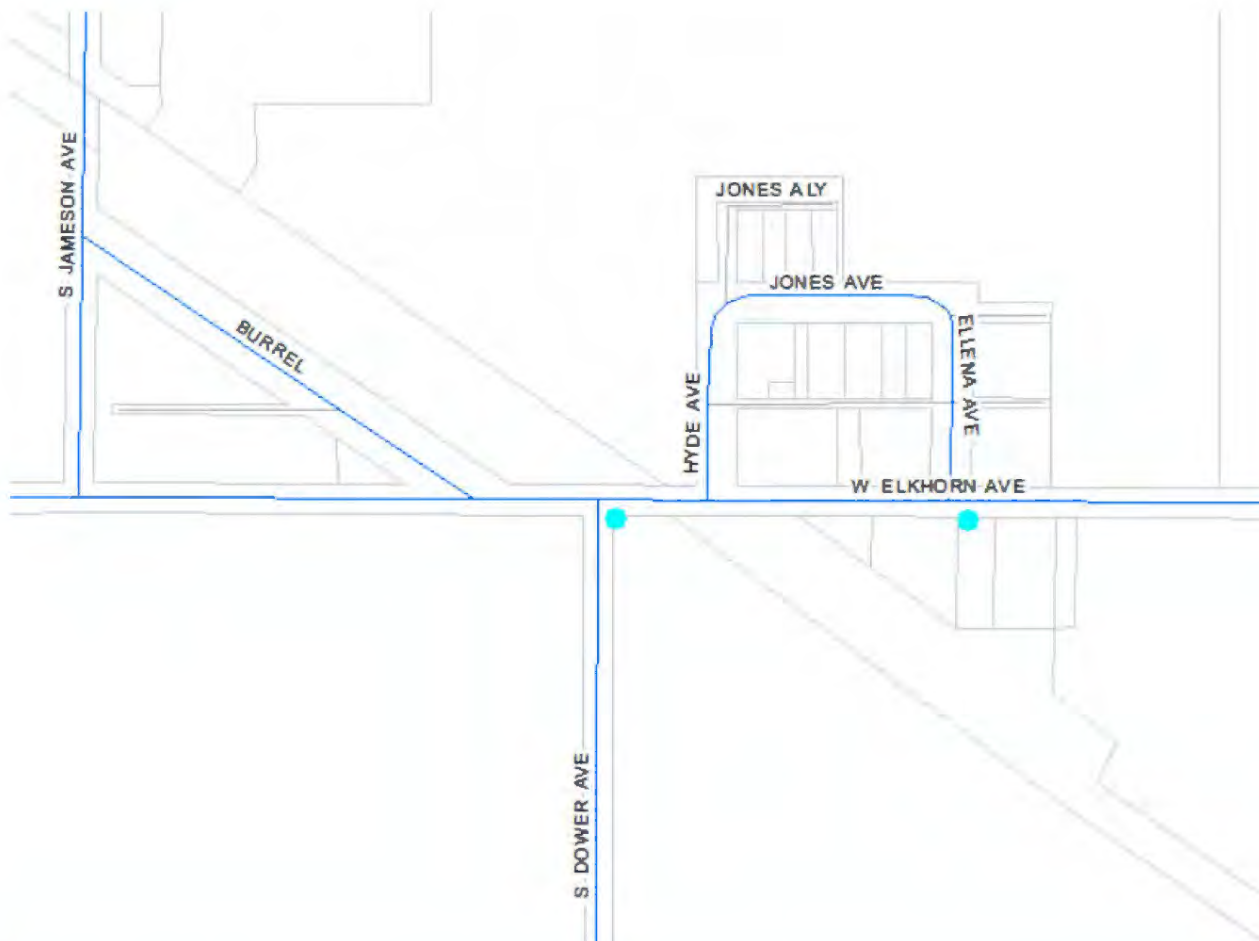

ReportNo	CollDate	CollTime	PriRoad	SecRoad	OfficerID *	NCICNo	Distance	Direction	InvolvedWi	CollType	PCF
9435201804477	10/27/2018	1915	ELKHORN	DOWER	021165	9435	0	Not Stated	Fixed Object	Hit Object	Driving Under Influen
9435202002397	7/17/2020	1555	ELKHORN	ELLENA	021178	9435	20	East	Other Motor Vehicle	Rear-End	Driving Under Influen

(2 out of 8325 Selected)

COUNTY OF FRESNO
 COLLISION DATA (1/1/2018 to 10/15/21)

5. Camden Avenue Community

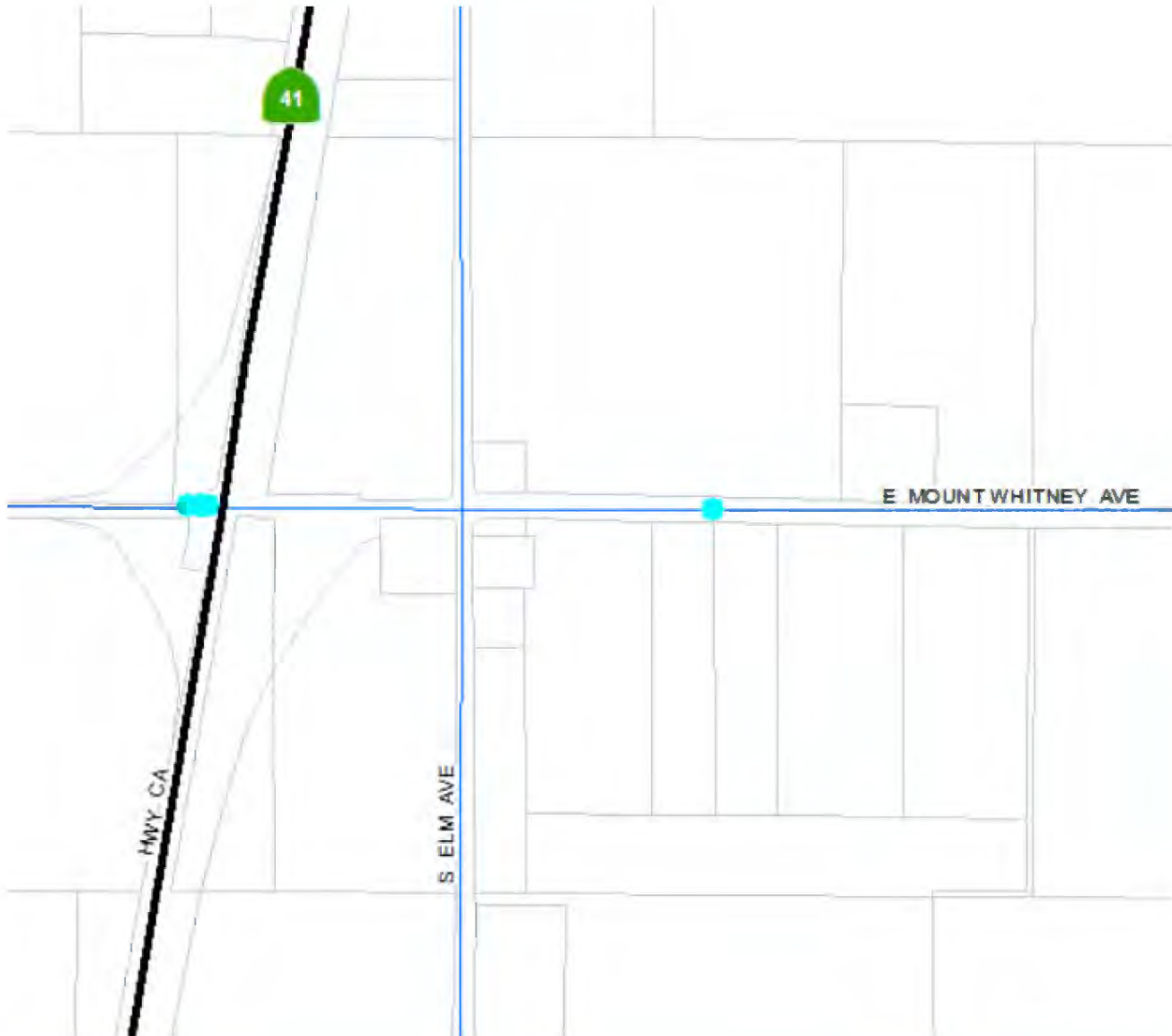

Table

Collisions db

ReportNo	CollDate	CollTime	PriRoad	SecRoad	OfficerID *	NCICNo	Distance	Direction	InvolvedWi	CollType	PCF
9435201802560	6/25/2018	2130	MOUNT WHITNEY	ELM	020481	9435	872	East	Fixed Object	Hit Object	Driving Under Influen
9435201900679	2/18/2019	1625	MOUNT WHITNEY	CA-41	018660	9435	100	West	Other Motor Vehicle	Rear-End	Unsafe Speed
9435202000993	3/16/2020	1618	MOUNT WHITNEY	CA-41	020122	9435	80	West	Other Motor Vehicle	Rear-End	Unsafe Speed
9435202001555	5/14/2020	1201	MOUNT WHITNEY	CA-41	019610	9435	150	West	Other Motor Vehicle	Rear-End	Unsafe Speed
9435202002556	7/29/2020	1805	MOUNT WHITNEY	CA-41	018892	9435	115	West	Other Motor Vehicle	Rear-End	Unsafe Speed

(5 out of 8325 Selected)

Collisions db

ATTACHMENT D

COUNTY OF FRESNO
COLLISION DATA (1/1/2018 to 10/15/21)

6. Carrillo Avenue Community



ReportNo	CollDate	CollTime	PriRoad	SecRoad	OfficerID *	NCICNo	Distance	Direction	InvolvedWi	CollType	PCF
9435202003664	10/13/2020	1905	CHERRY	MANNING	020836	9435	1584	South	Fixed Object	Hlt Object	Unsafe Speed

(1 out of 8325 Selected)

COUNTY OF FRESNO
COLLISION DATA (1/1/2018 to 10/15/21)

7. Caruthers Community

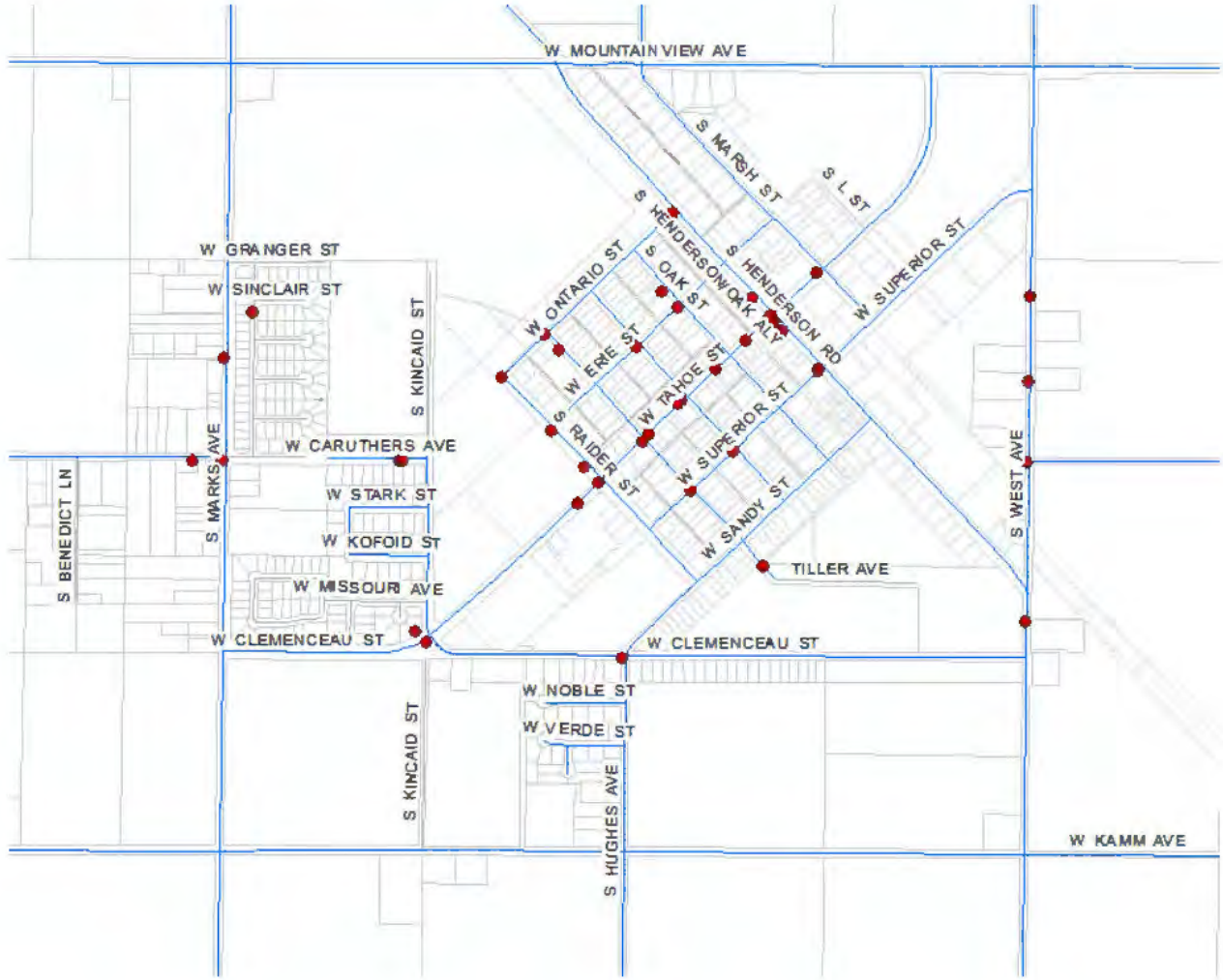

ATTACHMENT D

COUNTY OF FRESNO
COLLISION DATA (1/1/2018 to 10/15/21)

Caruthers Community

ReportNo	CollDate	CollTime	PrRoad	SecRoad	OfficerID *	NCICNo	Distance	Direction	InvolvedW/	CollType	PCF
943520180253	1/16/2018	1645	WEST	CARUTHER	019523	9435	0	Not Stated	Other Motor Vehicle	Broadside	-Hub
9435201801144	3/22/2018	1325	HENDERSON	TAHOE	020078	9435	0	Not Stated	Other Motor Vehicle	Broadside	Auto RWV Violation
9435201801483	4/19/2018	1710	TAHOE	HENDERSON	020871	9435	225	West	Fixed Object	Hit Object	Driving Under Influence
9435201801602	4/22/2018	2115	CLEMENCEAU	KINCAID	021031	9435	100	West	Fixed Object	Hit Object	Improper Turning
9435201802147	5/27/2018	1730	HENDERSON	TAHOE	020078	9435	50	South	Other Motor Vehicle	Sideswipe	Unsafe Starting or Backing
9435201802206	6/2/2018	2500	HENDERSON	SUPERIOR	020871	9435	0	Not Stated	Fixed Object	Hit Object	Improper Turning
9435201802230	6/7/2018	0958	CARUTHERS	MARKS	015996	9435	0	Not Stated	Other Motor Vehicle	Broadside	Auto RWV Violation
9435201802413	6/16/2018	1856	TAHOE	HENDERSON	020871	9435	0	Not Stated	Other Motor Vehicle	Broadside	Auto RWV Violation
9435201802944	7/24/2018	1520	HENDERSON	TAHOE	020082	9435	130	South	Other Motor Vehicle	Other	Auto RWV Violation
9435201803073	8/3/2018	1025	HENDERSON	TAHOE	013112	9435	0	Not Stated	Other Motor Vehicle	Broadside	Traffic Signals and Signs
9435201803713	9/11/2018	1520	TAHOE	RAIDER	020078	9435	198	West	Other Object	Hit Object	Unsafe Starting or Backing
9435201804685	11/9/2018	0830	TAHOE	PEAR	017310	9435	25	West	Other Motor Vehicle	Rear-End	Unsafe Speed
9435201805623	11/29/2018	1745	TAHOE	RAIDER	020082	9435	87	North	Animal	Other	Other Than Driver
9435201900169	1/14/2019	2348	WEST	HENDERSON	020592	9435	269	South	Fixed Object	Hit Object	Driving Under Influence
9435201900639	3/1/2019	0805	RAIDER	TAHOE	017591	9435	150	North	Other Motor Vehicle	Broadside	Auto RWV Violation
9435201901087	3/15/2019	0756	OAK	ERIE	017166	9435	0	Not Stated	Other Motor Vehicle	Broadside	Auto RWV Violation
9435201901360	4/2/2019	1000	TAHOE	OAK	019962	9435	100	West	Other Motor Vehicle	Broadside	Unsafe Starting or Backing
9435201901451	4/19/2019	0825	SUPERIOR	PEAR	017166	9435	0	Not Stated	Other Motor Vehicle	Broadside	Unknown
9435201902031	5/23/2019	1734	CLEMENCEAU	HUGHES	020095	9435	0	Not Stated	Other Motor Vehicle	Broadside	Auto RWV Violation
9435201902130	5/30/2019	0740	SUPERIOR	HENDERSON	017166	9435	0	Not Stated	Other Motor Vehicle	Broadside	Auto RWV Violation
9435201902975	7/22/2019	1145	SUPERIOR	HENDERSON	019451	9435	3	East	Fixed Object	Hit Object	Improper Turning
9435201911914	8/17/2019	2500	VANDEBURG	SINCLAR	020387	9435	65	South	Parked Motor Vehicle	Sideswipe	Improper Turning
9435201912001	8/22/2019	0750	RAIDER	TAHOE	017166	9435	150	North	Other Motor Vehicle	Sideswipe	Improper Passing
9435201912058	8/23/2019	1200	HENDERSON	SUPERIOR	018746	9435	0	Not Stated	Fixed Object	Hit Object	Improper Turning
9435201912312	9/9/2019	1605	WEST	SUPERIOR	019962	9435	745	South	Other Motor Vehicle	Rear-End	Unsafe Speed
9435201912503	9/20/2019	1425	TAHOE	PEAR	020871	9435	55	West	Other Motor Vehicle	Broadside	Unsafe Starting or Backing
9435201913038	10/14/2019	1207	SUPERIOR	PEAR	015755	9435	0	Not Stated	Motor Vehicle on Other Roadway	Broadside	Other Hazardous Movement
9435201913558	11/23/2019	0745	SUPERIOR	PEAR	019451	9435	0	Not Stated	Other Motor Vehicle	Broadside	Other Hazardous Movement
9435201913724	12/4/2019	0952	CARUTHERS	KINCAID	020019	9435	179	West	Parked Motor Vehicle	Rear-End	Improper Turning

ReportNo	CollDate	CollTime	PrRoad	SecRoad	OfficerID *	NCICNo	Distance	Direction	InvolvedW/	CollType	PCF
9435201913725	12/4/2019	0953	CARUTHERS	KINCAID	020019	9435	165	West	Parked Motor Vehicle	Sideswipe	Driving Under Influence
9435202000201	1/17/2020	1532	TAHOE	QUINCE	018860	9435	70	East	Parked Motor Vehicle	Rear-End	Driving Under Influence
9435202000535	2/13/2020	1854	TAHOE	KINCAID	020078	9435	0	Not Stated	Other Motor Vehicle	Broadside	Auto RWV Violation
9435202000815	3/3/2020	1445	QUINCE	TLLER	020387	9435	125	North	Pedestrian	Vehicle - Pedestrian	Unsafe Starting or Backing
9435202001246	4/12/2020	1935	QUINCE	ONTARIO	020078	9435	17	North	Other Object	Hit Object	Unsafe Speed
9435202001353	4/25/2020	2030	WEST	CARUTHER	021153	9435	538	North	Fixed Object	Hit Object	Driving Under Influence
9435202002054	6/22/2020	0518	WEST	CARUTHER	021153	9435	0	Not Stated	Other Motor Vehicle	Broadside	Auto RWV Violation
9450202000579	7/8/2020	0200	CARUTHERS	MARKS	018823	9435	200	West	Fixed Object	Hit Object	Improper Turning
9435202002745	8/10/2020	1405	RAIDER	ERIE	021230	9435	15	South	Other Motor Vehicle	Rear-End	Improper Turning
9435202003357	9/25/2020	0945	HENDERSON	SUPERIOR	018926	9435	0	Not Stated	Other Motor Vehicle	Broadside	Auto RWV Violation
9435202003370	9/25/2020	1935	TAHOE	RAIDER	020078	9435	198	West	Other Object	Hit Object	Driving Under Influence
9435202003400	9/27/2020	2246	TAHOE	RAIDER	020062	9435	0	Not Stated	Other Motor Vehicle	Head-On	Auto RWV Violation
9435202003524	10/5/2020	2330	OAK	ERIE	020580	9435	144	North	Fixed Object	Hit Object	Driving Under Influence
9435202003899	10/28/2020	1738	TAHOE	HENDERSON	020076	9435	75	West	Other Motor Vehicle	Sideswipe	Unsafe Starting or Backing
9435202004169	11/13/2020	1010	HENDERSON	TAHOE	015602	9435	177	North	Other Motor Vehicle	Sideswipe	Improper Passing
9435202004348	11/17/2020	1645	TAHOE	QUINCE	017310	9435	0	Not Stated	Other Motor Vehicle	Broadside	Auto RWV Violation
9435202100156	1/17/2021	0223	QUINCE	ONTARIO	021153	9435	130	East	Fixed Object	Hit Object	Improper Turning
9435202100424	2/3/2021	1612	PEAR	ERIE	018113	9435	0	Not Stated	Other Motor Vehicle	Broadside	Other Hazardous Movement
9435202100601	2/9/2021	1120	MARKS	GRANGER	014363	9435	625	South	Other Motor Vehicle	Sideswipe	Unknown
9435202100709	2/26/2021	1008	TAHOE	HENDERSON	019789	9435	0	Not Stated	Other Motor Vehicle	Broadside	Auto RWV Violation
9435202100845	3/9/2021	1243	HENDERSON	ONTARIO	019113	9435	0	Not Stated	Other Motor Vehicle	Head-On	Improper Turning
9435202100868	3/11/2021	1203	TAHOE	HENDERSON	019113	9435	10	East	Other Motor Vehicle	Broadside	Auto RWV Violation
9435202100869	3/11/2021	1310	TAHOE	MARSH	019113	9435	15	West	Other Motor Vehicle	Rear-End	Unsafe Speed
9435202101743	5/6/2021	2058	ONTARIO	RAIDER	021230	9435	5	East	Fixed Object	Hit Object	Improper Turning
9435202110343	5/26/2021	1520	QUINCE	SUPERIOR	020387	9435	0	Not Stated	Other Motor Vehicle	Broadside	Traffic Signals and Signs

ATTACHMENT D

COUNTY OF FRESNO
COLLISION DATA (1/1/2018 to 10/15/21)

8. Chestnut Avenue Community – Shady Lakes



Table

chestnut

ReportNo	CollDate	CollTime	PriRoad	SecRoad	OfficerID*	NCICNo	Distance	Direction	InvolvedWi	CollType	PCF
9435201800202	1/15/2018	1525	CHESTNUT	JEFFERSON	019473	9435	1093	South	Other Motor Vehicle	Rear-End	Unsafe Speed
9435201800608	2/14/2018	1907	CHESTNUT	JEFFERSON	015181	9435	500	South	Bicycle	Rear-End	Improper Turning
9435202001529	5/12/2020	2034	CHESTNUT	JEFFERSON	019789	9435	890	South	Pedestrian	Vehicle - Pedestrian	Pedestrian Violation

(0 out of 3 Selected)

chestnut

Table Of Contents Table

ATTACHMENT D

COUNTY OF FRESNO
COLLISION DATA (1/1/2018 to 10/15/21)

9. Church Avenue/Floyd Community

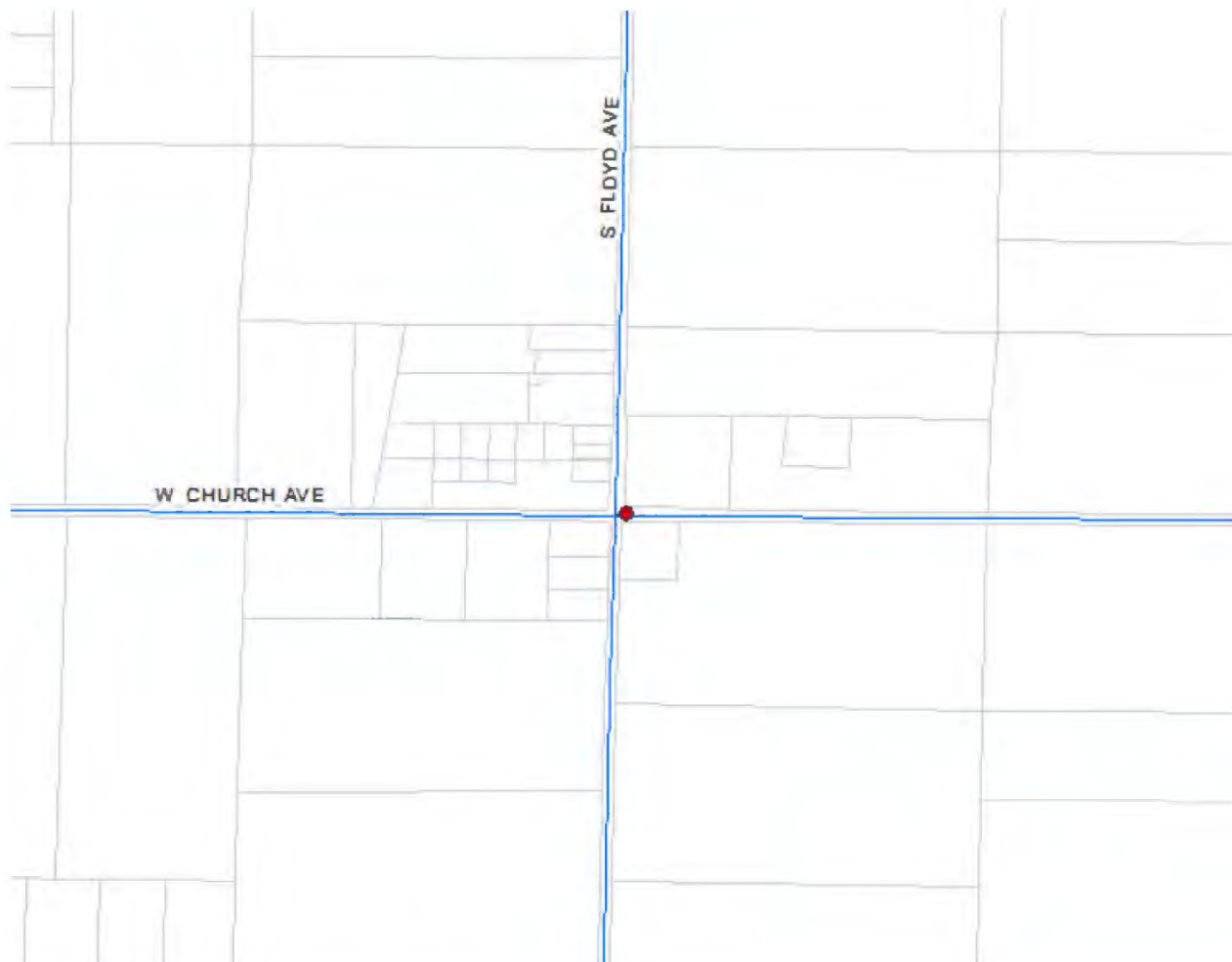

ReportNo	CollDate	CollTime	PriRoad	SecRoad	OfficerID *	NCICNo	Distance	Direction	InvolvedWi	CollType	PCF
9435202000778	3/1/2020	0918	FLOYD	CHURCH	017166	9435	0	Not Stated	Other Motor Vehicle	Broadside	Auto R/W Violation

Collisions db

1 (1 out of *2000 Selected)

Collisions db

Table Of Contents Table

COUNTY OF FRESNO
 COLLISION DATA (1/1/2018 to 10/15/21)

10. Cornelia Avenue/Floral Avenue Community



ReportNo	CollDate	CollTime	PriRoad	SecRoad	OfficerID *	NCICNo	Distance	Direction	InvolvedW/i	CollType	PCF
9435202003946	10/30/2020	1830	CORNELIA	ROSE	021178	9435	225	North	Parked Motor Vehicle	Head-On	Unsafe Speed

cornelia floral

Table Of Contents Table

ATTACHMENT D

COUNTY OF FRESNO
COLLISION DATA (1/1/2018 to 10/15/21)

11. CSA 30 Community – El Porvenir



Table

Collisions db

ReportNo	CollDate	CollTime	PriRoad	SecRoad	OfficerID *	NCICNo	Distance	Direction	InvolvedWi	CollType
9495202100006	1/4/2021	1830	EL PROGRESSO	HIDALGO (W	021029	9495	200	North	Other Motor Vehicle	Other

(1 out of *2000 Selected)

Collisions db

Table Of Contents Table

COUNTY OF FRESNO
COLLISION DATA (1/1/2018 to 10/15/21)

12. CSA 32 Community - Cantua Creek



Table

Collisions db

ReportNo	CollDate	CollTime	PriRoad	SecRoad	OfficerID *	NCICNo	Distance	Direction	InvolvedWi	CollType
----------	----------	----------	---------	---------	-------------	--------	----------	-----------	------------	----------

(0 out of *2000 Selected)

Collisions db

Table Of Contents Table

ATTACHMENT D

COUNTY OF FRESNO
COLLISION DATA (1/1/2018 to 10/15/21)

13. CSA 30 Zone "A" Community



ReportNo	CollDate	CollTime	PriRoad	SecRoad	OfficerID *	NCICNo	Distance	Direction	InvolvedWi	CollType	PCF
9435201800179	1/13/2018	1720	VALENTINE	MUSCAT	020871	9435	150	South	Fixed Object	Hit Object	Driving Under Influence

ATTACHMENT D

COUNTY OF FRESNO
COLLISION DATA (1/1/2018 to 10/15/21)

14. West Park (CSA 39 Zone "B")

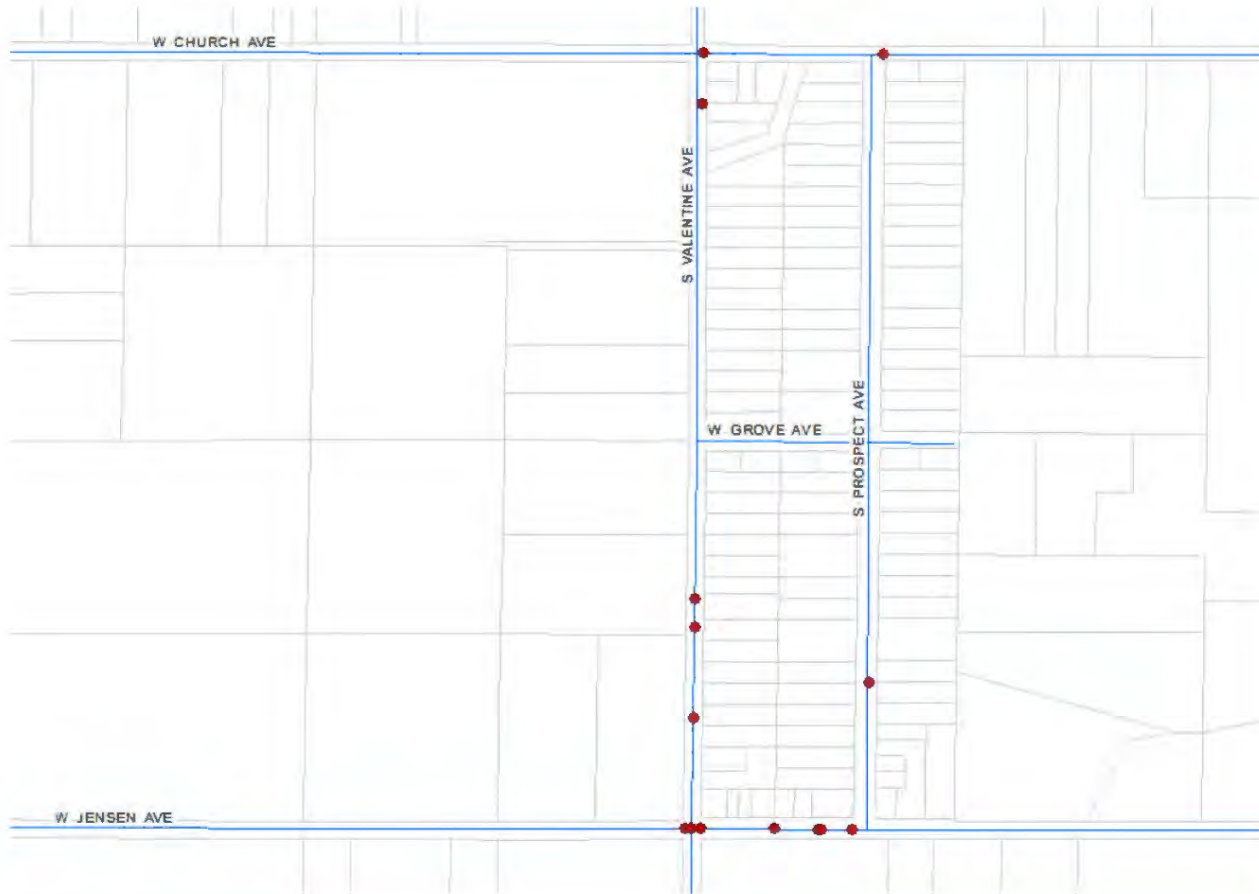

Table

csa 39 zone b

ReportNo	CollDate	CollTime	PriRoad	SecRoad	OfficerID *	NCICNo	Distance	Direction	InvolvedWi	CollType	PCF
9435201800107	1/8/2018	1330	JENSEN	VALENTINE	015181	9435	0	Not Stated	Other Motor Vehicle	Broadside	Auto R/W Violation
9435201802108	5/26/2018	1345	VALENTINE	CHURCH	020078	9435	0	Not Stated	Other Motor Vehicle	Broadside	Auto R/W Violation
9435201802126	5/27/2018	0010	VALENTINE	JENSEN	020062	9435	0	Not Stated	Other Motor Vehicle	Broadside	Auto R/W Violation
9435201802385	6/14/2018	1137	JENSEN	MARKS	015986	9435	2640	West	Fixed Object	Hit Object	Improper Turning
9435201802981	7/27/2018	0745	PROSPECT	JENSEN	018296	9435	500	North	Animal	Other	Other Than Driver
9435201803301	8/15/2018	1930	JENSEN	VALENTINE	020078	9435	430	East	Other Motor Vehicle	Broadside	Auto R/W Violation
9435201901351	3/31/2019	0410	JENSEN	VALENTINE	019523	9435	280	East	Parked Motor Vehicle	Sideswipe	Improper Turning
9435201901777	5/4/2019	0300	VALENTINE	JENSEN	020387	9435	375	North	Other Object	Hit Object	Improper Turning
9435201902669	7/5/2019	1920	VALENTINE	JENSEN	020871	9435	0	Not Stated	Other Motor Vehicle	Broadside	Traffic Signals and Signs
9435202000453	2/7/2020	0800	VALENTINE	GROVE	020019	9435	528	South	Other Motor Vehicle	Broadside	Improper Turning
9435202000696	2/25/2020	1530	JENSEN	VALENTINE	019789	9435	30	East	Fixed Object	Hit Object	Improper Turning
9435202001390	4/29/2020	1253	VALENTINE	CHURCH	019610	9435	0	Not Stated	Other Motor Vehicle	Rear-End	Auto R/W Violation
9435202001428	4/30/2020	0015	CHURCH	PROSPECT	019523	9435	19	East	Fixed Object	Hit Object	Improper Turning
9435202001482	5/9/2020	1110	JENSEN	PROSPECT	020871	9435	50	West	Other Motor Vehicle	Other	Auto R/W Violation
9435202001882	6/10/2020	1445	VALENTINE	CHURCH	019789	9435	0	Not Stated	Other Motor Vehicle	Broadside	Auto R/W Violation
9435202002344	7/13/2020	1820	VALENTINE	GROVE	020387	9435	620	South	Fixed Object	Hit Object	Improper Turning
9435202002625	8/3/2020	1759	CHURCH	VALENTINE	021230	9435	0	Not Stated	Other Motor Vehicle	Broadside	Auto R/W Violation
9435202002816	8/14/2020	2310	VALENTINE	JENSEN	020854	9435	0	Not Stated	Other Motor Vehicle	Broadside	Traffic Signals and Signs
9435202004544	12/8/2020	2010	JENSEN	VALENTINE	020387	9435	0	Not Stated	Other Motor Vehicle	Broadside	Traffic Signals and Signs
9435202100258	1/24/2021	1745	VALENTINE	CHURCH	020942	9435	175	South	Other Motor Vehicle	Rear-End	Other Than Driver
9435202100855	3/10/2021	1915	JENSEN	VALENTINE	020387	9435	0	Not Stated	Other Motor Vehicle	Broadside	Traffic Signals and Signs
9435202101508	4/21/2021	0537	JENSEN	PROSPECT	020019	9435	157	West	Other Motor Vehicle	Rear-End	Unsafe Speed

(0 out of 22 Selected)

csa 39 zone b

Table Of Contents Table

ATTACHMENT D

COUNTY OF FRESNO
COLLISION DATA (1/1/2018 to 10/15/21)

15. CSA 43 Community – Raisin City



ATTACHMENT D

COUNTY OF FRESNO
COLLISION DATA (1/1/2018 to 10/15/21)

CSA 43 Community – Raisin City

Table

csa 43 raisin city

ReportNo	CollDate	CollTime	PriRoad	SecRoad	OfficerID *	NCICNo	Distance	Direction	InvolvedWf	CollType	PCF
9435201801128	3/22/2018	0805	MANNING	HAYES	018049	9435	0	Not Stated	Other Motor Vehicle	Broadside	Unsafe Speed
9435201801442	4/12/2018	0050	ORMUS	HENDERSO	020481	9435	100	North	Fixed Object	Hit Object	Driving Under Influence
9435201802446	6/19/2018	0628	MANNING	HAYES	019451	9435	0	Not Stated	Other Motor Vehicle	Broadside	Auto RW Violation
9435201803603	9/5/2018	1345	MANNING	BRYAN	019962	9435	0	Not Stated	Other Motor Vehicle	Rear-End	Driving Under Influence
9435201805087	12/3/2018	1800	HENDERSO	BRYAN	020095	9435	0	Not Stated	Fixed Object	Hit Object	Improper Turning
9435201805430	12/26/2018	1455	FKE	ORMUS	019451	9435	435	West	Other Motor Vehicle	Rear-End	Other Improper Driving
9435201900383	1/29/2019	1755	MANNING	ORMUS	019962	9435	0	Not Stated	Other Motor Vehicle	Sideswipe	Auto RW Violation
9435201901343	4/2/2019	1648	MANNING	HAYES	018926	9435	0	Not Stated	Other Motor Vehicle	Broadside	Traffic Signals and Signs
9435201901479	4/12/2019	2230	BOWLES	OLEANDER	019705	9435	67	West	Fixed Object	Hit Object	Improper Turning
9435202000624	2/20/2020	1346	MANNING	BRYAN	020019	9435	74	West	Animal	Other	Other Than Driver
9435202001631	5/21/2020	2500	ORMUS	HENDERSO	019610	9435	0	Not Stated	Fixed Object	Hit Object	Unknown
9435202001844	6/8/2020	1300	RING	MYRTLE	020429	9435	0	Not Stated	Other Motor Vehicle	Sideswipe	Other Hazardous Movement
9435202004122	11/10/2020	2310	ORMUS	MANNING	018944	9435	0	Not Stated	Fixed Object	Hit Object	Improper Turning
9435202100089	1/9/2021	2200	BRYAN	HENDERSO	019523	9435	0	Not Stated	Fixed Object	Hit Object	Unsafe Speed
9435202101265	4/5/2021	0600	HENDERSO	ORMUS	019789	9435	0	Not Stated	Fixed Object	Hit Object	Improper Turning
9435202101765	5/8/2021	1530	MANNING	ORMUS	021230	9435	0	Not Stated	Other Motor Vehicle	Broadside	Auto RW Violation
9435202110440	6/5/2021	1405	MANNING	HAYES	021178	9435	0	Not Stated	Other Motor Vehicle	Broadside	Traffic Signals and Signs

(0 out of 17 Selected)

csa 43 raisin city

Table Of Contents Table

ATTACHMENT D

COUNTY OF FRESNO
COLLISION DATA (1/1/2018 to 10/15/21)

16. CSA 49 Community – O’Neill Farms/Westside



ReportNo	CollDate	CollTime	PriRoad	SecRoad	OfficerID *	NCICNo	Distance	Direction	InvolvedWi	CollType
----------	----------	----------	---------	---------	-------------	--------	----------	-----------	------------	----------

Collisions db (0 out of *2000 Selected)

Collisions db

Table Of Contents Table

ATTACHMENT D

COUNTY OF FRESNO
COLLISION DATA (1/1/2018 to 10/15/21)

17. Del Rey Community

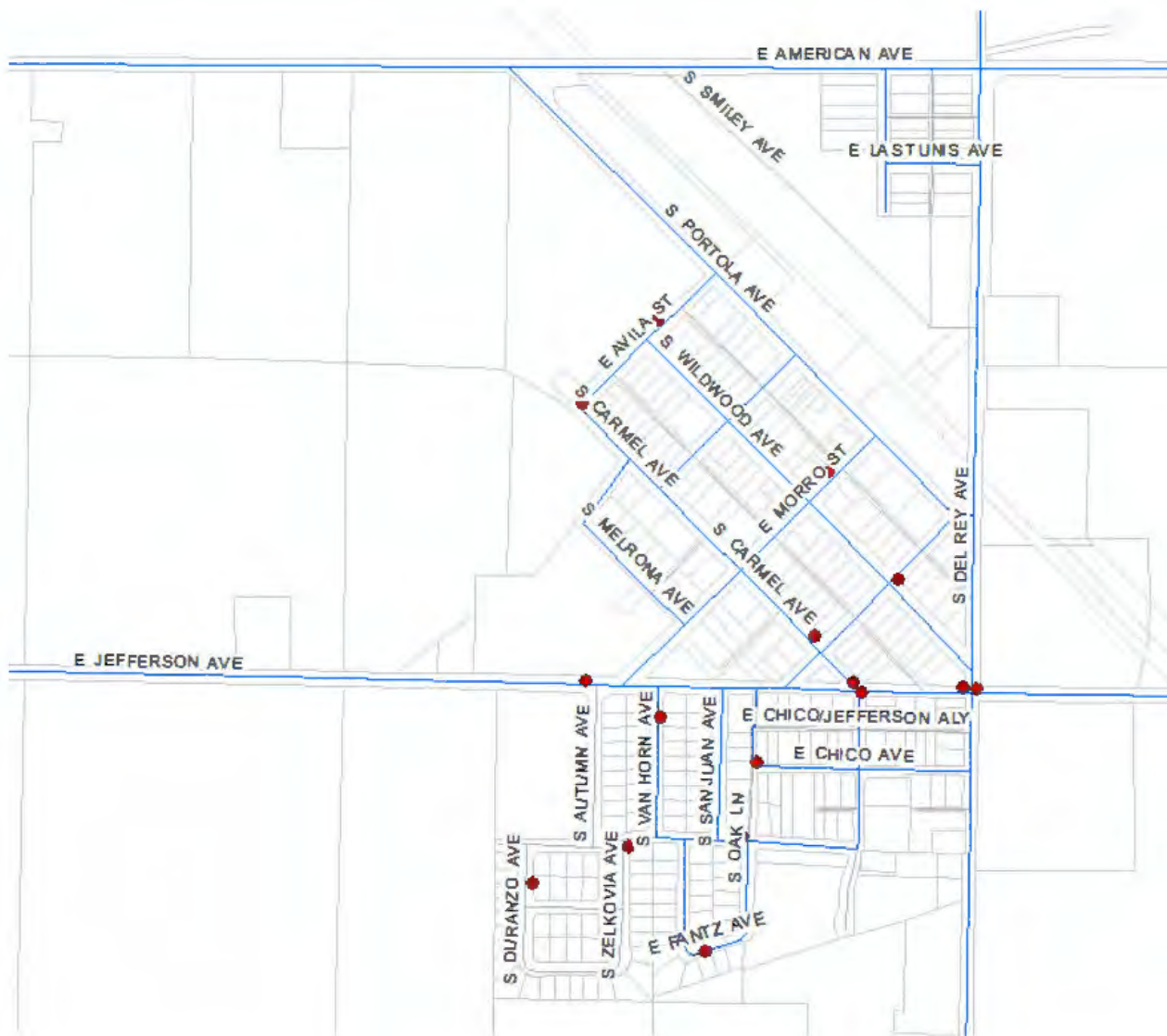

ATTACHMENT D

COUNTY OF FRESNO
COLLISION DATA (1/1/2018 to 10/15/21)

Del Rey Community

ReportNo	CollDate	CollTime	PriRoad	SecRoad	OfficerID *	NCICNo	Distance	Direction	InvolvedWi	CollType	PCF
9435201800450	2/3/2018	1045	JEFFERSON	DEL REY	017310	9435	0	Not Stated	Other Motor Vehicle	Broadside	Auto R/W Violation
9435201800908	3/8/2018	0910	JEFFERSON	DEL REY	015986	9435	0	Not Stated	Other Motor Vehicle	Broadside	Auto R/W Violation
9435201801561	4/19/2018	1812	REDONDO	SAN JUAN	018860	9435	80	East	Fixed Object	HR Object	Improper Turning
94352017802529	6/24/2018	2352	JEFFERSON	CARMEL	020450	9435	37	West	Parked Motor Vehicle	Sideswipe	Improper Turning
9435201804109	10/3/2018	1100	MORRO	WILDWOOD	013703	9435	110	East	Parked Motor Vehicle	Broadside	Improper Turning
9435201804288	10/13/2018	1240	AVILA	WILDWOOD	021230	9435	60	East	Other Motor Vehicle	Rear-End	Improper Turning
9435201805075	12/2/2018	0010	CARMEL	JEFFERSON	021165	9435	45	South	Fixed Object	HR Object	Improper Turning
9435201901594	4/21/2019	1144	WILDWOOD	MORRO	018284	9435	528	South	Other Motor Vehicle	Broadside	Unsafe Starting or Backing
9435201912435	9/15/2019	1820	ZELKOVIA	REDONDO	020824	9435	40	South	Fixed Object	HR Object	Improper Turning
9435201912777	10/5/2019	2130	VAN HORN	JEFFERSON	020062	9435	160	South	Parked Motor Vehicle	Head-On	Improper Turning
9435201913845	12/12/2019	2301	CARMEL	AVILA	019705	9435	14	East	Fixed Object	HR Object	Driving Under Influence
9435202001256	4/14/2020	2020	CHICO	OAK	020481	9435	0	Not Stated	Fixed Object	HR Object	Unsafe Speed
9435202001553	5/11/2020	1035	JEFFERSON	AUTUMN	015602	9435	60	West	Fixed Object	HR Object	Unsafe Speed
9435202002490	7/24/2020	1940	FANTZ	VAN HORN	021119	9435	50	East	Other Motor Vehicle	Sideswipe	Unsafe Speed
9435202003431	9/29/2020	1950	CARMEL	ESTRELLA	021165	9435	40	North	Other Motor Vehicle	Rear-End	Improper Turning
9435202003628	10/11/2020	1940	DURANZO	REDONDO	021148	9435	164	South	Other Motor Vehicle	Sideswipe	Improper Turning
9435202100881	3/13/2021	0200	JEFFERSON	DEL REY	021178	9435	55	West	Fixed Object	HR Object	Driving Under Influence
9435202101503	4/13/2021	2500	VAN HORN	FANTZ	014363	9435	45	West	Other Motor Vehicle	Head-On	Improper Turning

(0 out of 18 Selected)

Collisions db selection 2

ATTACHMENT D

COUNTY OF FRESNO
COLLISION DATA (1/1/2018 to 10/15/21)

18. East Adams Avenue Community

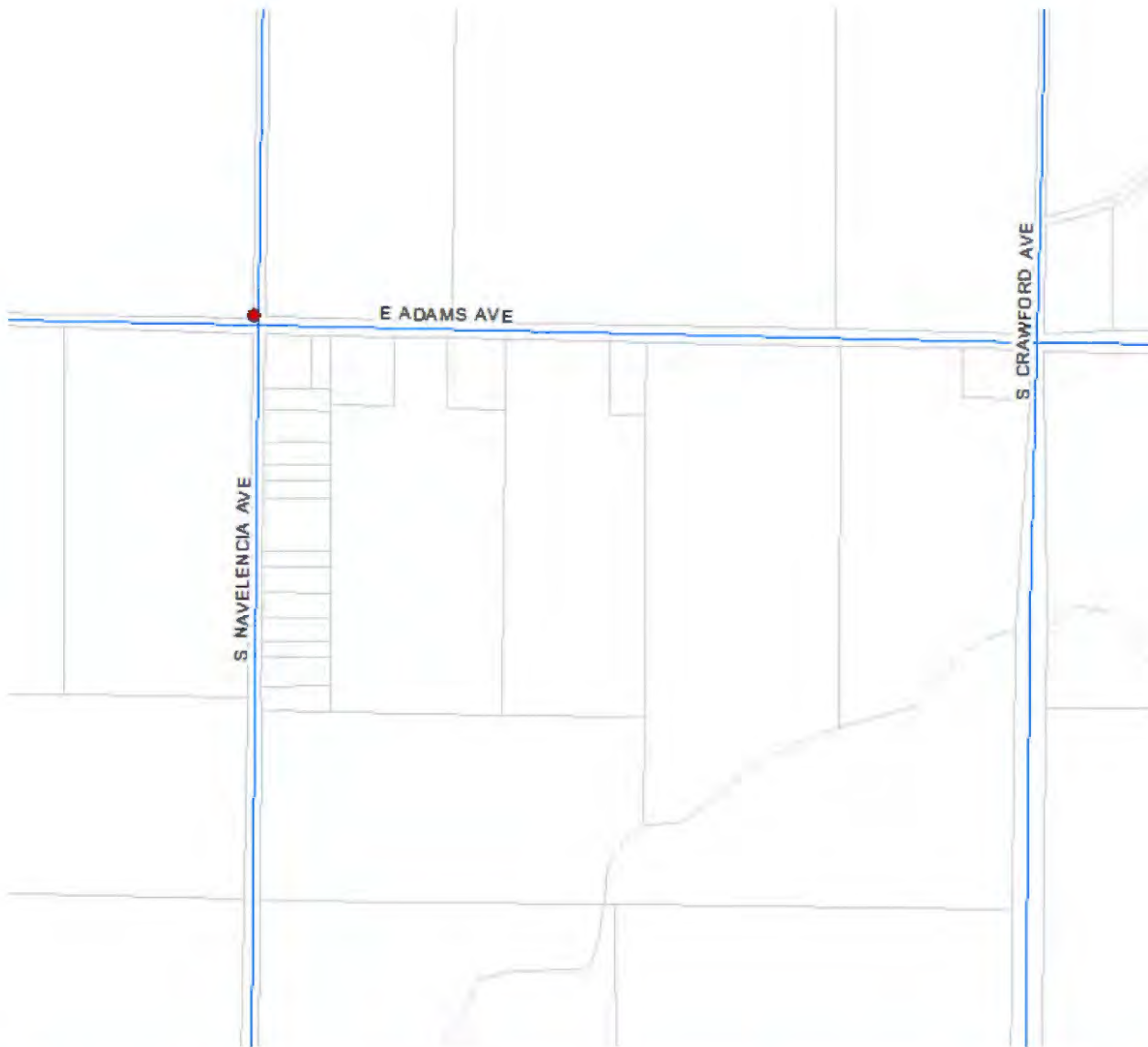

ReportNo	CollDate	CollTime	PriRoad	SecRoad	OfficerID *	NCICNo	Distance	Direction	InvolvedWi	CollType	PCF
9435201900068	1/8/2019	1345	NAVELENCIA	ADAMS	016507	9435	0	Not Stated	Other Motor Vehicle	Broadside	Auto R/W Violation
9435201901926	5/14/2019	1546	ADAMS	NAVELENCIA	016270	9435	0	Not Stated	Other Motor Vehicle	Sideswipe	Wrong Side of Road

adams navalencia

(0 out of 2 Selected)

adams navalencia

COUNTY OF FRESNO
COLLISION DATA (1/1/2018 to 10/15/21)

19. Easton Community

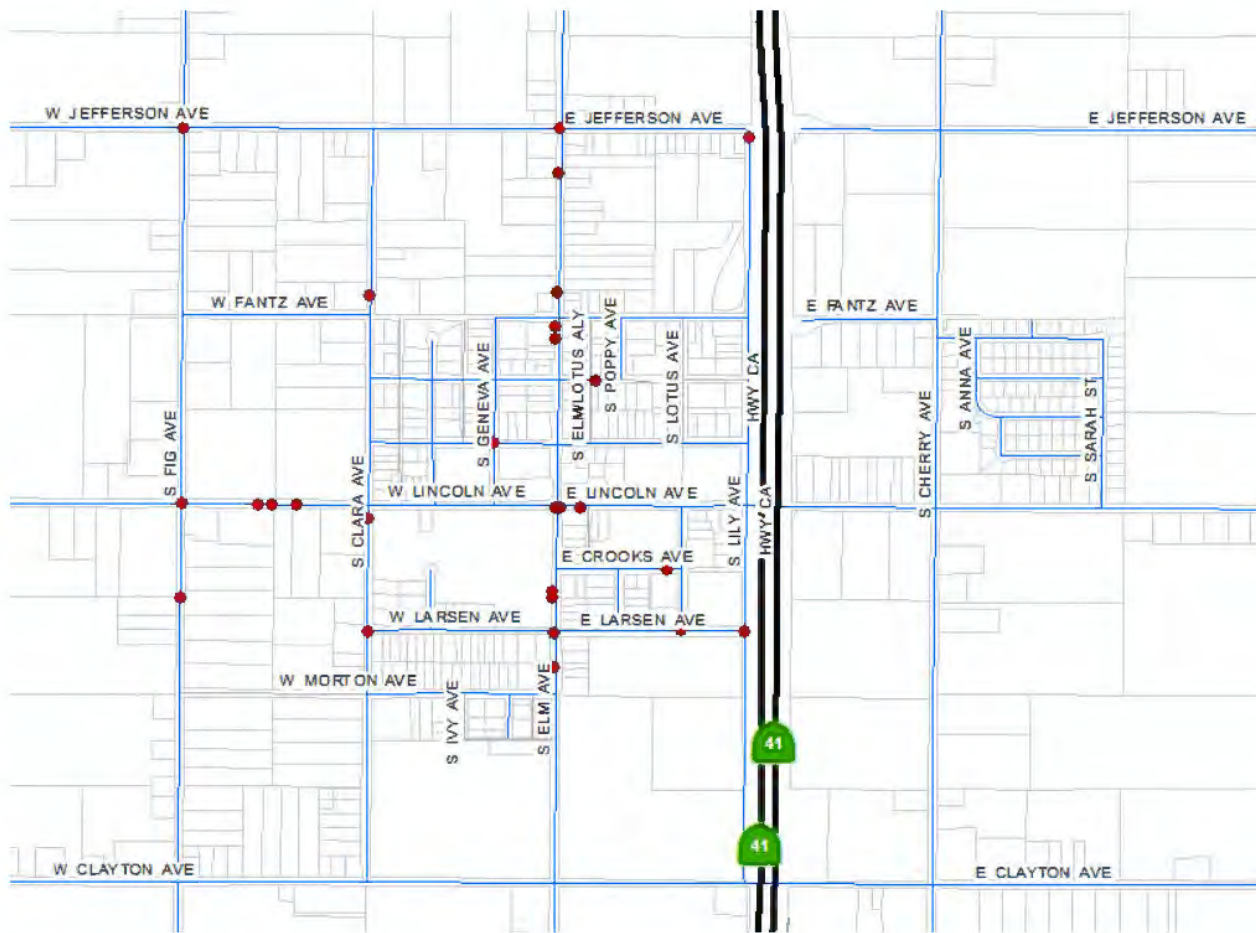

ATTACHMENT D

COUNTY OF FRESNO
COLLISION DATA (1/1/2018 to 10/15/21)

Easton Community

ReportNo	CollDate	CollTime	PriRoad	SecRoad	OfficerID *	NCICNo	Distance	Direction	InvolvedWi	CollType	PCF
9435201800803	3/1/2018	0830	ELM	LARSEN	019980	9435	250	North	Other Motor Vehicle	Broadside	Auto R/W Violation
9435201801004	3/12/2018	1117	ELM	FANTZ	018049	9435	146	South	Fixed Object	Hit Object	Improper Turning
9435201801181	3/25/2018	0015	ELM	LINCOLN	020592	9435	0	Not Stated	Other Motor Vehicle	Broadside	Traffic Signals and Signs
9435201801639	4/25/2018	0850	LINCOLN	ELM	014363	9435	35	East	Other Motor Vehicle	Head-On	Other Than Driver
9435201801660	4/26/2018	0805	ELM	LINCOLN	013112	9435	0	Not Stated	Other Motor Vehicle	Broadside	Unknown
9435201802607	6/29/2018	1013	CROOKS	LOTUS	015986	9435	92	West	Fixed Object	Hit Object	Improper Turning
9435201802969	7/25/2018	2500	CLARA	LINCOLN	013112	9435	95	South	Parked Motor Vehicle	Sideswipe	Improper Turning
9435201804155	10/5/2018	1054	FIG	JEFFERSON	015986	9435	0	Not Stated	Other Motor Vehicle	Broadside	Auto R/W Violation
9435201804672	11/8/2018	0745	LOTUS	LARSEN	017166	9435	20	North	Other Motor Vehicle	Sideswipe	Wrong Side of Road
9435201900276	1/9/2019	0805	ELM	FANTZ	015755	9435	60	South	Other Motor Vehicle	Broadside	Auto R/W Violation
9435201900223	1/18/2019	1525	ELM	LARSEN	020824	9435	0	Not Stated	Other Motor Vehicle	Broadside	Auto R/W Violation
9435201901703	4/28/2019	0145	ELM	JEFFERSON	020854	9435	310	South	Parked Motor Vehicle	Rear-End	Driving Under Influence
9435201901850	5/8/2019	2228	LINCOLN	FIG	020854	9435	528	East	Fixed Object	Hit Object	Improper Turning
9435201902688	7/7/2019	1234	LINCOLN	ELM	017166	9435	0	Not Stated	Other Motor Vehicle	Broadside	Traffic Signals and Signs
9435201912640	9/27/2019	0757	ELM	CROOKS	017166	9435	150	South	Other Motor Vehicle	Broadside	Auto R/W Violation
9435201913528	11/15/2019	2125	FIG	JEFFERSON	019523	9435	0	Not Stated	Other Motor Vehicle	Broadside	Auto R/W Violation
9435202000657	2/22/2020	1628	HOPKINS	POPPY	019789	9435	160	West	Fixed Object	Hit Object	Driving Under Influence
9435202000752	2/29/2020	1207	ELM	JEFFERSON	019789	9435	0	Not Stated	Other Motor Vehicle	Broadside	Auto R/W Violation
9435202000756	2/29/2020	1715	LINCOLN	CLARA	020871	9435	670	West	Other Motor Vehicle	Broadside	Auto R/W Violation
9435202000787	3/2/2020	1500	FIG	LINCOLN	018892	9435	0	Not Stated	Other Motor Vehicle	Broadside	Auto R/W Violation
9435202000977	3/13/2020	1520	GENEVA	WILLAMETTE	020481	9435	0	Not Stated	Other Motor Vehicle	Broadside	Auto R/W Violation
9435202001213	4/9/2020	1630	FIG	LINCOLN	020078	9435	655	South	Other Object	Hit Object	Improper Turning
9435202001279	4/17/2020	0634	LINCOLN	ELM	021031	9435	175	East	Fixed Object	Hit Object	Unsafe Starting or Backing
9435202001468	5/7/2020	1932	ELM	LARSEN	019789	9435	245	South	Other Motor Vehicle	Rear-End	Driving Under Influence
9435202001694	5/22/2020	1159	CLARA	FANTZ	018746	9435	156	North	Other Motor Vehicle	Broadside	Auto R/W Violation
9435202002370	7/15/2020	2145	LINCOLN	CLARA	021031	9435	500	West	Parked Motor Vehicle	Sideswipe	Improper Turning
9435202002826	8/16/2020	2115	LINCOLN	ELM	021153	9435	0	Not Stated	Fixed Object	Hit Object	Unsafe Speed
9435202003519	10/5/2020	1620	ELM	FANTZ	020481	9435	185	North	Other Motor Vehicle	Broadside	Wrong Side of Road
9435202003968	11/2/2020	0123	LILY	JEFFERSON	021153	9435	50	South	Fixed Object	Hit Object	Unsafe Speed
9435202004395	11/28/2020	1055	LINCOLN	ELM	020122	9435	0	Not Stated	Other Motor Vehicle	Broadside	Auto R/W Violation
9435202100396	2/1/2021	0706	CLARA	LARSEN	019789	9435	20	South	Fixed Object	Hit Object	Driving Under Influence
9435202100397	2/1/2021	0707	LARSEN	LILY	019789	9435	0	Not Stated	Fixed Object	Hit Object	Driving Under Influence
9435202100713	2/27/2021	1545	LINCOLN	ELM	020871	9435	0	Not Stated	Other Motor Vehicle	Broadside	Auto R/W Violation

(0 out of 33 Selected)

easton

COUNTY OF FRESNO
COLLISION DATA (1/1/2018 to 10/15/21)

20. Five Points Community

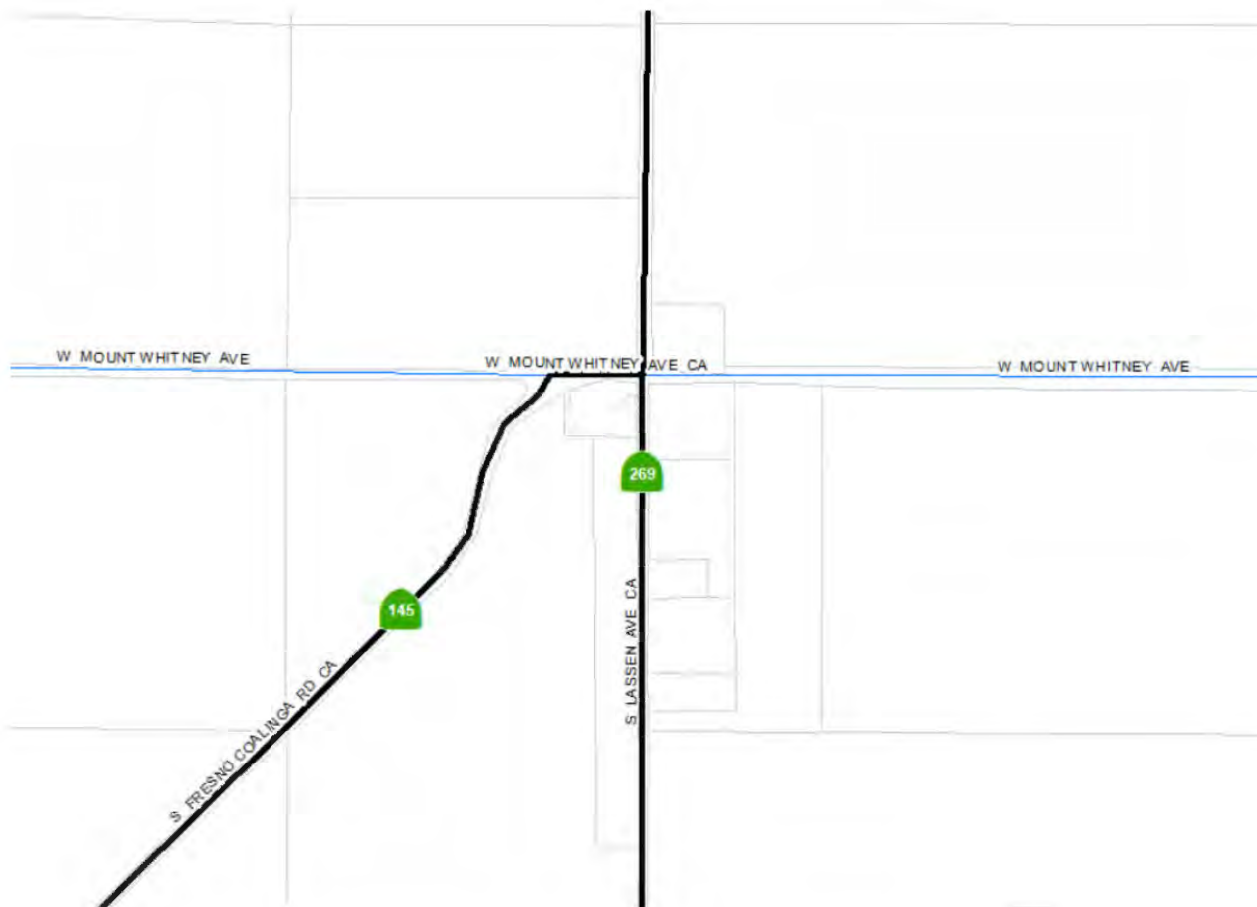

Table

Collisions db

ReportNo	CollDate	CollTime	PriRoad	SecRoad	OfficerID *	NCICNo	Distance	Direction	InvolvedWi	CollType
----------	----------	----------	---------	---------	-------------	--------	----------	-----------	------------	----------

(0 out of *2000 Selected)

Collisions db

Table Of Contents Table

COUNTY OF FRESNO
COLLISION DATA (1/1/2018 to 10/15/21)

21. Flamingo Mobile Home Community



flamingo

ReportNo	CollDate	CollTime	PriRoad	SecRoad	OfficerID *	NCICNo	Distance	Direction	InvolvedWi	CollType	PCF
9435201804506	10/29/2018	1410	CENTRAL	MAPLE	019895	9435	620	East	Other Motor Vehicle	Rear-End	Unsafe Speed
9435201913669	12/2/2019	1339	CENTRAL	CA-99 SB	021153	9435	2	East	Non-Collision	Rear-End	Unsafe Speed
9435202000899	3/10/2020	1615	CENTRAL	MAPLE	020095	9435	600	East	Other Motor Vehicle	Rear-End	Unsafe Starting or Backing
9435202000902	3/10/2020	1640	CENTRAL	CA-99 NB	020095	9435	230	West	Other Motor Vehicle	Rear-End	Unsafe Speed
9435202003537	10/6/2020	1623	CENTRAL	CA-99 SB	020481	9435	326	West	Other Motor Vehicle	Rear-End	Unsafe Speed

flamingo

ATTACHMENT D

COUNTY OF FRESNO
COLLISION DATA (1/1/2018 to 10/15/21)

22. Hayes Road Community/Perrin Community

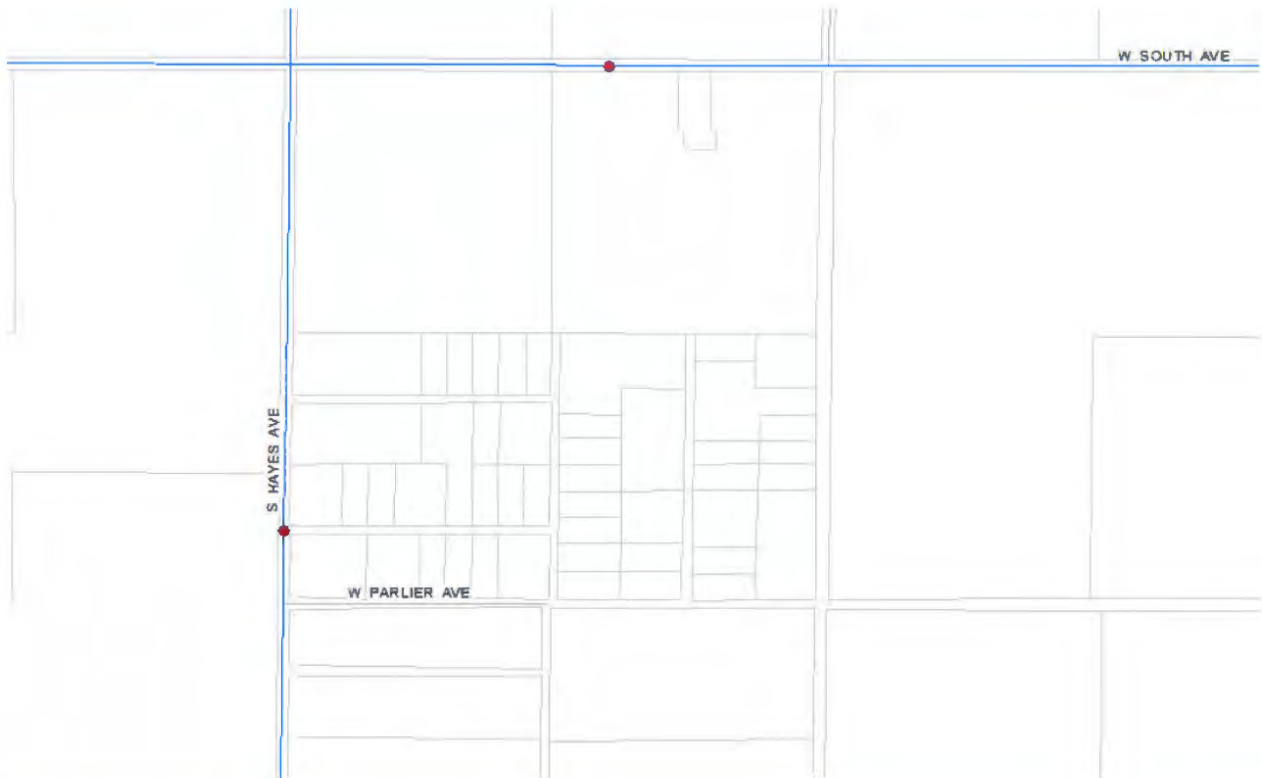

ReportNo	CollDate	CollTime	PriRoad	SecRoad	OfficerID*	NCICNo	Distance	Direction	InvolvedWi	CollType	PCF	
9435201805389	12/22/2018	1820	HAYES	PARLIER	019962	9435	350	North	Other Motor Vehicle	Broadside	Auto RAW Violation	Di
9435201913795	12/4/2019	1120	SOUTH	HAYES	017310	9435	1584	East	Other Motor Vehicle	Rear-End	Unsafe Speed	Di

Collisions db selection 3

(0 out of 2 Selected)

Collisions db selection 3

ATTACHMENT D

COUNTY OF FRESNO
COLLISION DATA (1/1/2018 to 10/15/21)

23. Hughes Avenue/Magnolia Avenue Community



ATTACHMENT D

COUNTY OF FRESNO
COLLISION DATA (1/1/2018 to 10/15/21)

Hughes Avenue/Magnolia Avenue Community

ReportNo	CollDate	CollTime	PriRoad	SecRoad	OfficerID *	NCICNo	Distance	Direction	InvolvedWi	CollType
----------	----------	----------	---------	---------	-------------	--------	----------	-----------	------------	----------

(0 out of *2000 Selected)

Table Of Contents Table

COUNTY OF FRESNO
COLLISION DATA (1/1/2018 to 10/15/21)

24. Lanare Community



ReportNo	CollDate	CollTime	PriRoad	SecRoad	OfficerID *	NCICNo	Distance	Direction	InvolvedWi	CollType	PCF
9435201800463	2/4/2018	0740	MOUNT WHITNEY	GRANTLAND	017489	9435	1056	West	Other Motor Vehicle	Rear-End	Unsafe Speed
9435201800825	3/1/2018	1535	MOUNT WHITNEY	CHATEAU FRESNO	018944	9435	0	Not Stated	Other Motor Vehicle	Sideswipe	Wrong Side of Road
9435201803336	8/18/2018	1950	GARFIELD	MOUNT WHITNEY	020837	9435	30	South	Other Motor Vehicle	Broadside	Improper Turning
9435201901984	5/18/2019	1907	CHATEAU FRESNO	MOUNT WHITNEY	018912	9435	1056	North	Fixed Object	Hit Object	Unsafe Speed
9435201902296	6/9/2019	2220	MOUNT WHITNEY	GRANTLAND	021165	9435	100	West	Fixed Object	Hit Object	Other Equipment
9435201903132	8/2/2019	1150	MOUNT WHITNEY	GRANTLAND	018746	9435	0	Not Stated	Non-Collision	Rear-End	Improper Turning
9435201911844	8/12/2019	1640	MOUNT WHITNEY	GRANTLAND	019962	9435	30	West	Other Motor Vehicle	Rear-End	Unsafe Speed
9435202000673	2/21/2020	2320	MOUNT WHITNEY	GARFIELD	020854	9435	1300	West	Other Motor Vehicle	Sideswipe	Improper Turning
9435202000875	3/8/2020	1825	MOUNT WHITNEY	GRANTLAND	020871	9435	0	Not Stated	Other Motor Vehicle	Rear-End	Driving Under Influence
9435202001554	5/14/2020	0735	MOUNT WHITNEY	GARFIELD	019610	9435	1320	East	Fixed Object	Hit Object	Improper Turning
9435202002396	7/17/2020	1540	MOUNT WHITNEY	GARFIELD	021178	9435	40	West	Other Motor Vehicle	Rear-End	Unsafe Speed
9435202002408	7/18/2020	0830	MOUNT WHITNEY	GARFIELD	019789	9435	300	West	Fixed Object	Hit Object	Driving Under Influence
9435202002764	8/11/2020	1815	MOUNT WHITNEY	GARFIELD	020887	9435	538	East	Other Motor Vehicle	Sideswipe	Improper Passing
9435202003866	10/26/2020	1720	MOUNT WHITNEY	CHATEAU FRESNO	018914	9435	0	Not Stated	Non-Collision	Overtaken	Improper Turning
9435202100700	2/26/2021	0320	MOUNT WHITNEY	CHATEAU FRESNO	021153	9435	300	East	Fixed Object	Hit Object	Improper Turning
9435202110781	6/26/2021	2215	MOUNT WHITNEY	CHATEAU FRESNO	020854	9435	20	East	Fixed Object	Hit Object	Traffic Signals and Signs

(0 out of 16 Selected)

lanare

COUNTY OF FRESNO
COLLISION DATA (1/1/2018 to 10/15/21)

26. Lost Hills Community



ReportNo	CollDate	CollTime	PriRoad	SecRoad	OfficerID*	NCICNo	Distance	Direction	InvolvedWi	CollType
----------	----------	----------	---------	---------	------------	--------	----------	-----------	------------	----------

Collisions db (0 out of *2000 Selected)

Collisions db

Table Of Contents Table

ATTACHMENT D

COUNTY OF FRESNO
COLLISION DATA (1/1/2018 to 10/15/21)

27. Madera Avenue Community

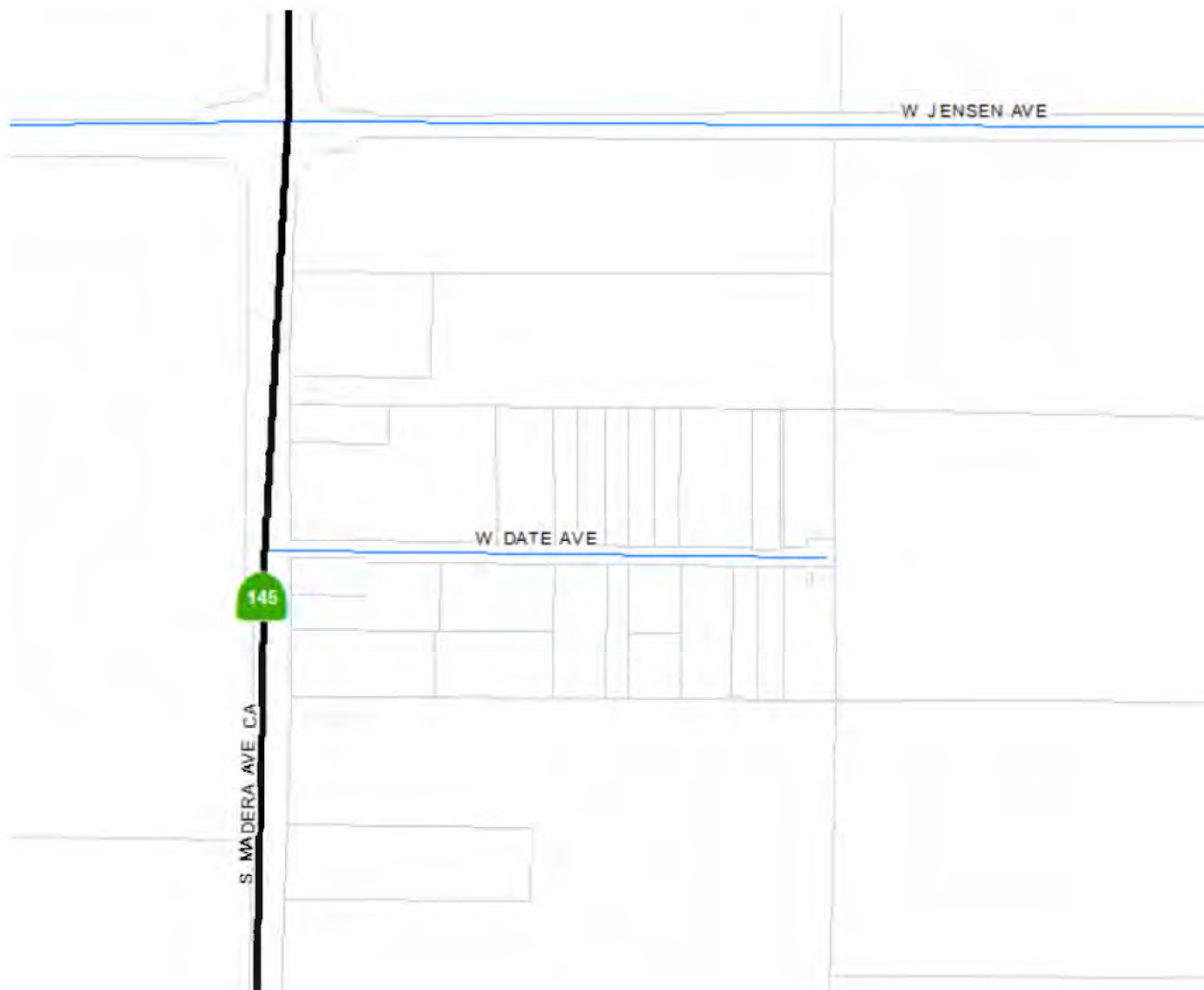

ReportNo	CollDate	CollTime	PriRoad	SecRoad	OfficerID *	NCICNo	Distance	Direction	InvolvedWi	CollType
----------	----------	----------	---------	---------	-------------	--------	----------	-----------	------------	----------

Collisions db (0 out of *2000 Selected)

Table Of Contents Table

ATTACHMENT D

COUNTY OF FRESNO
COLLISION DATA (1/1/2018 to 10/15/21)

Malaga Community

ReportNo	CollDate	CollTime	PriRoad	SecRoad	OfficerID *	NCICNo	Distance	Direction	InvolvedWi	CollType	PCF
9435201800788	2/24/2018	1730	CALVIN	OLNEY	020078	9435	50	South	Parked Motor Vehicle	Rear-End	Improper Turning
9435201801317	4/4/2018	0620	MUSCAT	CHESTNUT	014363	9435	0	Not Stated	Other Motor Vehicle	Broadside	Auto R/W Violation
9435201801998	5/19/2018	1455	MUSCAT	FRANK	019895	9435	200	West	Fixed Object	Hit Object	Improper Turning
9435201900811	2/20/2019	0744	CHESTNUT	CALVIN	018912	9435	0	Not Stated	Fixed Object	Overturned	Unsafe Speed
9435201900730	2/21/2019	1330	FRONT	OLNEY	021119	9435	20	North	Parked Motor Vehicle	Sideswipe	Improper Turning
9435201901133	3/19/2019	1215	CHESTNUT	CALVIN	017591	9435	0	Not Stated	Other Motor Vehicle	Broadside	Auto R/W Violation
9435201901714	4/18/2019	1120	CHESTNUT	CALVIN	014363	9435	20	South	Fixed Object	Hit Object	Other Equipment
9435201902484	6/23/2019	0020	WARD	GRAND	020450	9435	50	South	Parked Motor Vehicle	Sideswipe	Improper Turning
9435201902940	7/24/2019	1531	HARDING	MUSCAT	020122	9435	290	South	Non-Collision	Vehicle - Pedestrian	Auto R/W Violation
9435201911952	8/19/2019	1600	FRANK	OLNEY	020837	9435	0	Not Stated	Fixed Object	Hit Object	Unsafe Speed
9435201912228	9/5/2019	0733	CALVIN	CHESTNUT	014363	9435	60	East	Pedestrian	Vehicle - Pedestrian	Unsafe Speed
9435201912543	9/22/2019	2500	MUSCAT	FRANK	018865	9435	150	West	Other Motor Vehicle	Sideswipe	Improper Turning
9435201913095	10/25/2019	1415	FRONT	OLNEY	020592	9435	145	South	Parked Motor Vehicle	Rear-End	Improper Turning
9435201913621	11/27/2019	1710	CHESTNUT	MUSCAT	021165	9435	0	Not Stated	Other Motor Vehicle	Rear-End	Auto R/W Violation
9435201913681	12/1/2019	0940	VICTORIA	MUSCAT	017310	9435	0	Not Stated	Other Motor Vehicle	Broadside	Auto R/W Violation
9435201913660	12/1/2019	1625	GOULD	HARDING	020078	9435	115	West	Other Object	Hit Object	Improper Turning
9435202000709	2/26/2020	1135	MUSCAT	CHESTNUT	013703	9435	30	East	Other Motor Vehicle	Rear-End	Unsafe Starting or Backing
9435202001222	4/11/2020	0125	WAWONA	WINERY	020586	9435	75	East	Parked Motor Vehicle	Head-On	Improper Turning
94352020002464	7/22/2020	1005	CHESTNUT	CALVIN	015890	9435	2	South	Other Motor Vehicle	Broadside	Improper Turning
9435202003243	9/14/2020	1036	MUSCAT	VICTORIA	014363	9435	105	West	Other Motor Vehicle	Rear-End	Improper Turning
9435202003658	10/9/2020	1341	FRONT	OLNEY	017310	9435	170	South	Other Motor Vehicle	Broadside	Improper Turning
9435202004238	11/16/2020	1520	CHESTNUT	MUSCAT	021178	9435	50	South	Other Motor Vehicle	Rear-End	Unsafe Speed
9435202100195	1/20/2021	0650	CHESTNUT	MUSCAT	020078	9435	0	Not Stated	Other Motor Vehicle	Broadside	Traffic Signals and Signs
9435202100288	1/25/2021	0227	OLNEY	CALVIN	014363	9435	98	South	Other Motor Vehicle	Rear-End	Improper Turning
9435202100415	1/28/2021	0545	MUSCAT	CHESTNUT	014363	9435	37	East	Fixed Object	Hit Object	Unsafe Speed
9435202101329	4/2/2021	1228	HARDING	MUSCAT	014363	9435	54	South	Other Motor Vehicle	Sideswipe	Improper Turning
9435202101234	4/3/2021	0345	CALVIN	FRONT	019369	9435	90	South	Parked Motor Vehicle	Rear-End	Improper Turning
9435202110037	5/11/2021	1350	CHESTNUT	MUSCAT	020824	9435	36	North	Fixed Object	Hit Object	Auto R/W Violation

1 (0 out of 28 Selected)

malaga

COUNTY OF FRESNO
 COLLISION DATA (1/1/2018 to 10/15/21)

29. Monmouth Community



ReportNo	CollDate	CollTime	PriRoad	SecRoad	OfficerID *	NCICNo	Distance	Direction	InvolvedWi	CollType	PCF
9435202003787	10/21/2020	1610	NEBRASKA	CHESTNUT	020871	9435	600	West	Other Motor Vehicle	Head-On	Driving Under Influence
9435202100414	1/27/2021	1115	CHESTNUT	NEBRASKA	018746	9435	0	Not Stated	Other Motor Vehicle	Broadside	Traffic Signals and Signs

(0 out of 2 Selected)

ATTACHMENT D

COUNTY OF FRESNO
 COLLISION DATA (1/1/2018 to 10/15/21)

30. Parlier Avenue/Elm Avenue Community

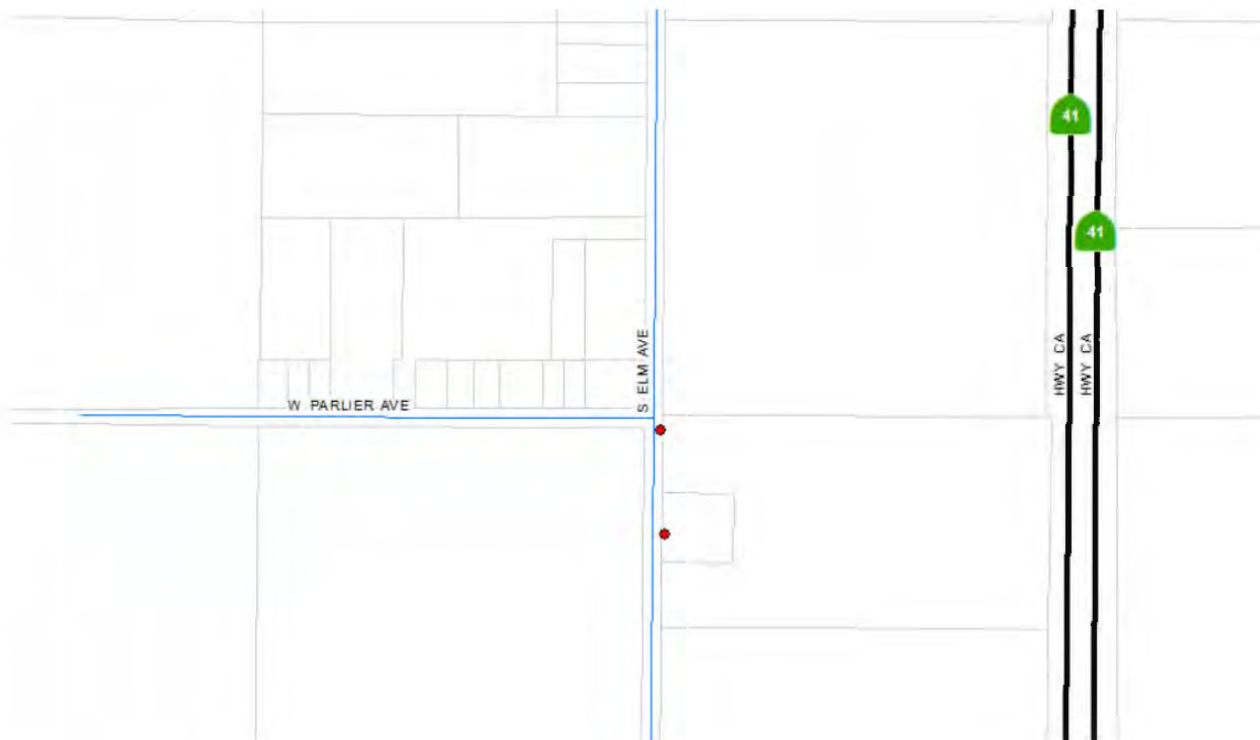

Table

Collisions db selection 7

ReportNo	CollDate	CollTime	PriRoad	SecRoad	OfficerID *	NCICNo	Distance	Direction	InvolvedWi	CollType	PCF
9435201902138	5/30/2019	2113	ELM	PARLIER	018860	9435	350	South	Fixed Object	Hit Object	Improper Turning
9435201913335	11/8/2019	1140	PARLIER	ELM	019789	9435	14	West	Other Motor Vehicle	Sideswipe	Improper Turning

(0 out of 2 Selected)

Collisions db selection 7

ATTACHMENT D

COUNTY OF FRESNO
COLLISION DATA (1/1/2018 to 10/15/21)

31. Riverdale Community

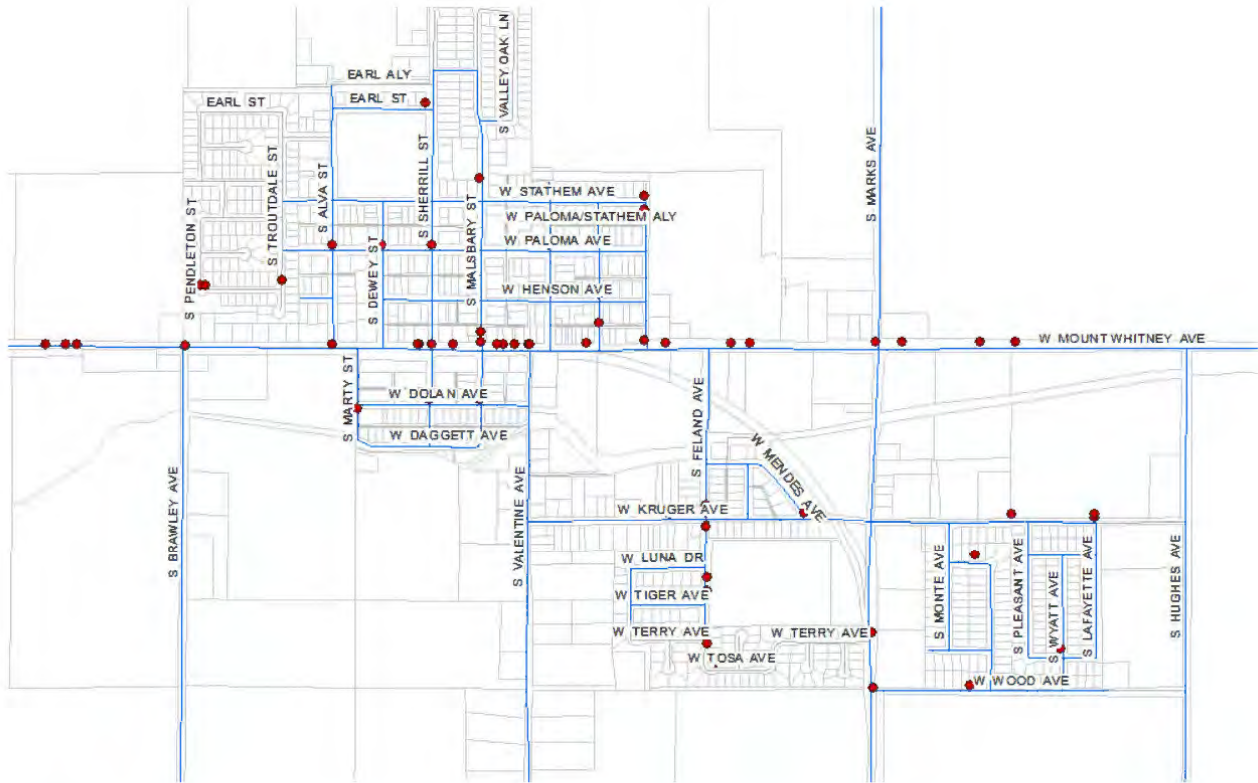

ReportNo	CoNDate	CoITime	PrRoad	SecRoad	OfficerID	ICICNo	Distance	Direction	InvolvedVeh	CoIType	PCF
9435201800877	3/1/2018	1520	MALSBARY	MOUNT WHITNEY	018944	9435	100	North	Other Motor Vehicle	Sideswipe	Unsafe Starting or Backing
9435201800876	3/6/2018	0605	MOUNT WHITNEY	ALVA	018824	9435	0	Not Stated	Motor Vehicle on Other Roadway	Broadside	Auto RRV Violation
9435201800985	3/10/2018	2030	TOSA	FELAND	020078	9435	50	East	Parked Motor Vehicle	Broadside	Unsafe Speed
9435201801000	3/15/2018	0700	PALOMA	VALENTINE	018049	9435	0	Not Stated	Other Motor Vehicle	Broadside	Auto RRV Violation
9435201801247	4/27/2018	1305	WOOD	KRUGER	019049	9435	150	South	Parked Motor Vehicle	Sideswipe	Improper Passing
9435201801681	4/27/2018	2500	FELAND	KRUGER	014363	9435	58	North	Other Motor Vehicle	Sideswipe	Improper Turning
9435201801714	4/29/2018	2500	FELAND	TERRY	019962	9435	85	South	Other Motor Vehicle	Broadside	Improper Turning
9435201802000	5/18/2018	1845	MALSBARY	MOUNT WHITNEY	019523	9435	17	North	Other Motor Vehicle	Sideswipe	Driving Under Influence
9435201802116	5/27/2018	0020	LAFAYETTE	KRUGER	020586	9435	30	South	Parked Motor Vehicle	Rear-End	Improper Turning
9435201802157	5/29/2018	1713	ALVA	PALOMA	020095	9435	0	Not Stated	Other Motor Vehicle	Broadside	Auto RRV Violation
9435201802207	6/2/2018	1935	MARKS	MOUNT WHITNEY	020671	9435	0	Not Stated	Other Motor Vehicle	Broadside	Auto RRV Violation
9435201802699	7/6/2018	1610	HASLAM	MOUNT WHITNEY	02689	9435	160	North	Fixed Object	Hit Object	Improper Turning
9435201802717	7/7/2018	2255	MOUNT WHITNEY	FELAND	020481	9435	186	East	Pedestrian	Vehicle - Pedestrian	Improper Turning
9435201803786	9/9/2018	1035	TROUTDALE	HENSON	015755	9435	40	North	Other Object	Hit Object	Unknown
9435201803788	9/15/2018	0315	MOUNT WHITNEY	BRAWLEY	019523	9435	1056	West	Other Motor Vehicle	Sideswipe	Driving Under Influence
9435201803894	9/20/2018	0743	MOUNT WHITNEY	VALENTINE (E)	014363	9435	275	East	Other Motor Vehicle	Rear-End	Unsafe Speed
9435201804451	10/25/2018	1720	MOUNT WHITNEY	VALENTINE (W)	019895	9435	0	Not Stated	Other Motor Vehicle	Sideswipe	Unknown
9435201804525	10/30/2018	1316	FELAND	KRUGER	020095	9435	0	Not Stated	Other Motor Vehicle	Broadside	Auto RRV Violation
9435201804560	11/1/2018	1845	MOUNT WHITNEY	BRAWLEY	020540	9435	815	West	Other Motor Vehicle	Sideswipe	Unsafe Speed
9435201804813	11/15/2018	0810	MOUNT WHITNEY	VALENTINE (W)	017186	9435	15	East	Other Motor Vehicle	Rear-End	Unsafe Speed
9435201804804	11/16/2018	1655	FELAND	TIGER	020450	9435	60	North	Other Motor Vehicle	Broadside	Other Than Driver
9435201805107	12/4/2018	0759	PALOMA	SHERRILL	019113	9435	0	Not Stated	Other Motor Vehicle	Broadside	Traffic Signals and Signs
9435201900117	1/11/2019	1824	MOUNT WHITNEY	MARKS	020122	9435	795	East	Other Motor Vehicle	Broadside	Unsafe Speed
9435201900544	1/30/2019	0620	PALOMA	DEWEY	015755	9435	0	Not Stated	Other Motor Vehicle	Broadside	Auto RRV Violation
9435201900464	2/4/2019	1054	MARKS	WOOD	018912	9435	30	South	Fixed Object	Hit Object	Improper Turning
9435201901182	3/22/2019	1558	MOUNT WHITNEY	MARKS	020122	9435	0	Not Stated	Other Motor Vehicle	Broadside	Auto RRV Violation
9435201901319	4/1/2019	0805	SHERRILL	PALOMA	018065	9435	0	Not Stated	Other Motor Vehicle	Broadside	Auto RRV Violation
9435201901492	4/13/2019	1730	SHERRILL	DOLAN	020481	9435	0	Not Stated	Other Motor Vehicle	Broadside	Unknown
9435201901826	4/23/2019	1842	PALOMA	VALENTINE	019962	9435	0	Not Stated	Other Motor Vehicle	Broadside	Auto RRV Violation
9435201901779	5/4/2019	1236	MOUNT WHITNEY	HAZEL	020387	9435	155	East	Other Motor Vehicle	Broadside	Improper Turning
9435201901889	5/12/2019	1730	TERRY	WYATT	020481	9435	0	Not Stated	Other Motor Vehicle	Broadside	Driving Under Influence
9435201902797	7/16/2019	2110	PENDELTON	HENSON	020871	9435	0	Not Stated	Parked Motor Vehicle	Sideswipe	Improper Turning
9435201902945	7/17/2019	1435	KRUGER	MENDIS	021165	9435	20	East	Fixed Object	Hit Object	Improper Turning
9435201903168	8/10/2019	1710	HAZEL	STATHEM	020871	9435	160	South	Other Motor Vehicle	Sideswipe	Unknown
9435201911955	8/19/2019	1500	HAZEL	MOUNT WHITNEY	019962	9435	20	North	Other Motor Vehicle	Rear-End	Auto RRV Violation
9435201912177	8/22/2019	0821	FELAND	KRUGER	015755	9435	105	South	Other Motor Vehicle	Broadside	Auto RRV Violation
9435201912114	8/28/2019	1830	LUNA	KRUGER	018885	9435	100	West	Other Motor Vehicle	Broadside	Improper Turning
9435201912289	9/7/2019	2121	EARL	SHERRILL	020481	9435	20	West	Fixed Object	Hit Object	Improper Turning
9435201912520	9/21/2019	1150	MOUNT WHITNEY	MARKS	018926	9435	0	Not Stated	Non-Collision	Rear-End	Auto RRV Violation

ATTACHMENT D

COUNTY OF FRESNO
COLLISION DATA (1/1/2018 to 10/15/21)

Riverdale Community

ReportNo	CollDate	CollTime	PriRoad	SecRoad	OfficerID *	NCICNo	Distance	Direction	InvolvedVl	CollType	PCF
9435201912598	9/24/2019	1840	HENSON	HASLAM	020071	9435	0	Not Stated	Other Motor Vehicle	Broadside	Other Hazardous Movement
9435201913573	11/23/2019	1958	MOUNT WHITNEY	SHERRILL	019962	9435	100	West	Other Motor Vehicle	Sideswipe	Unsafe Speed
9435201913940	12/19/2019	2205	FELAND	LUNA	020193	9435	125	South	Parked Motor Vehicle	Rear-End	Improper Turning
9435201913987	12/21/2019	1310	MOUNT WHITNEY	MARKS	021165	9435	200	East	Other Object	Hit Object	Unsafe Speed
9435201914082	12/29/2019	0048	SHERRILL	MOUNT WHITNEY	019523	9435	0	Not Stated	Fixed Object	Hit Object	Driving Under Influence
9435202000012	1/2/2020	0644	MOUNT WHITNEY	MARKS	018926	9435	0	Not Stated	Other Motor Vehicle	Broadside	Auto RW Violation
9435202000301	1/25/2020	1736	MOUNT WHITNEY	VALENTINE (W)	020481	9435	100	West	Parked Motor Vehicle	Broadside	Improper Turning
9435202000373	1/31/2020	1730	MOUNT WHITNEY	BRAWLEY	019789	9435	10	East	Other Motor Vehicle	Rear-End	Unsafe Speed
9435202000636	3/5/2020	0920	MOUNT WHITNEY	SHERRILL	015179	9435	105	West	Other Motor Vehicle	Broadside	Auto RW Violation
9435202001298	4/20/2020	1738	MOUNT WHITNEY	MALSBARY	020122	9435	165	East	Other Motor Vehicle	Broadside	Wrong Side of Road
9435202001644	5/21/2020	1120	PALOMA	SHERRILL	017166	9435	0	Not Stated	Other Motor Vehicle	Broadside	Traffic Signals and Signs
9435202002179	6/29/2020	1732	MOUNT WHITNEY	MARKS	020078	9435	0	Not Stated	Other Motor Vehicle	Broadside	Traffic Signals and Signs
9435202002204	7/2/2020	2315	MOUNT WHITNEY	BRAWLEY	019523	9435	900	West	Other Motor Vehicle	Rear-End	Driving Under Influence
9435202002260	7/7/2020	2120	VALENTINE	HENSON	020062	9435	44	North	Fixed Object	Hit Object	Unsafe Speed
9435202002329	7/13/2020	1755	MARTY	DOLAN	018892	9435	65	South	Parked Motor Vehicle	Broadside	Improper Turning
9435202002498	7/25/2020	0615	HENSON	PENCKLETON	017166	9435	40	East	Other Motor Vehicle	Sideswipe	Improper Turning
9435202002659	8/5/2020	1804	MARKS	TERRY	020942	9435	0	Not Stated	Other Motor Vehicle	Broadside	Auto RW Violation
9435202002673	8/6/2020	0630	KRUGER	FELAND	020387	9435	275	West	Fixed Object	Hit Object	Improper Turning
9435202002896	8/21/2020	1200	PALOMA	DEWEY	020078	9435	0	Not Stated	Other Motor Vehicle	Broadside	Unknown
9435202003135	9/5/2020	2200	MARKS	MOUNT WHITNEY	020680	9435	0	Not Stated	Other Motor Vehicle	Broadside	Driving Under Influence
9435202003602	10/10/2020	1715	MALSBARY	DOLAN	021178	9435	0	Not Stated	Other Motor Vehicle	Broadside	Unknown
9435202003841	10/23/2020	0310	MOUNT WHITNEY	FELAND	019523	9435	330	East	Fixed Object	Hit Object	Improper Turning
9435202004272	11/19/2020	1832	MOUNT WHITNEY	MALSBARY	020078	9435	120	West	Other Motor Vehicle	Rear-End	Unsafe Speed
9435202004454	12/2/2020	1845	KRUGER	PLEASANT	020193	9435	110	West	Fixed Object	Hit Object	Improper Turning
9435202004785	12/27/2020	0430	MOUNT WHITNEY	SHERRILL	019523	9435	160	East	Fixed Object	Hit Object	Improper Turning
9435202100079	1/8/2021	2235	MALSBARY	STATHEM	020654	9435	130	North	Parked Motor Vehicle	Rear-End	Improper Turning
9435202100314	1/27/2021	1000	MOUNT WHITNEY	MARKS	014650	9435	1058	East	Fixed Object	Hit Object	Unsafe Speed
9435202101189	3/31/2021	1335	HAZEL	STATHEM	020078	9435	0	Not Stated	Other Object	Hit Object	Unsafe Speed
9435202110333	5/28/2021	1415	KRUGER	FELAND	021165	9435	0	East	Other Motor Vehicle	Sideswipe	Improper Turning
9435202111742	8/25/2021	2054	KRUGER	LAFAYETTE	020078	9435	0	Not Stated	Other Object	Hit Object	Unsafe Speed

ATTACHMENT D

COUNTY OF FRESNO
COLLISON DATA (1/1/2018 to 10/15/21)

32. Russell Avenue Community



ATTACHMENT D

COUNTY OF FRESNO
COLLISION DATA (1/1/2018 to 10/15/21)

Russell Avenue Community

The screenshot shows a software interface for a data table. The window title is "Table". Below the title bar is a toolbar with various icons. The table itself is titled "Collisions db" and has the following columns: ReportNo, CollDate, CollTime, PriRoad, SecRoad, OfficerID *, NCICNo, Distance, Direction, InvolvedWi, and CollType. The table body is currently empty. At the bottom of the table, there is a status bar that says "(0 out of *2000 Selected)". Below the table, there are two buttons: "Table Of Contents" and "Table".

ReportNo	CollDate	CollTime	PriRoad	SecRoad	OfficerID *	NCICNo	Distance	Direction	InvolvedWi	CollType
----------	----------	----------	---------	---------	-------------	--------	----------	-----------	------------	----------

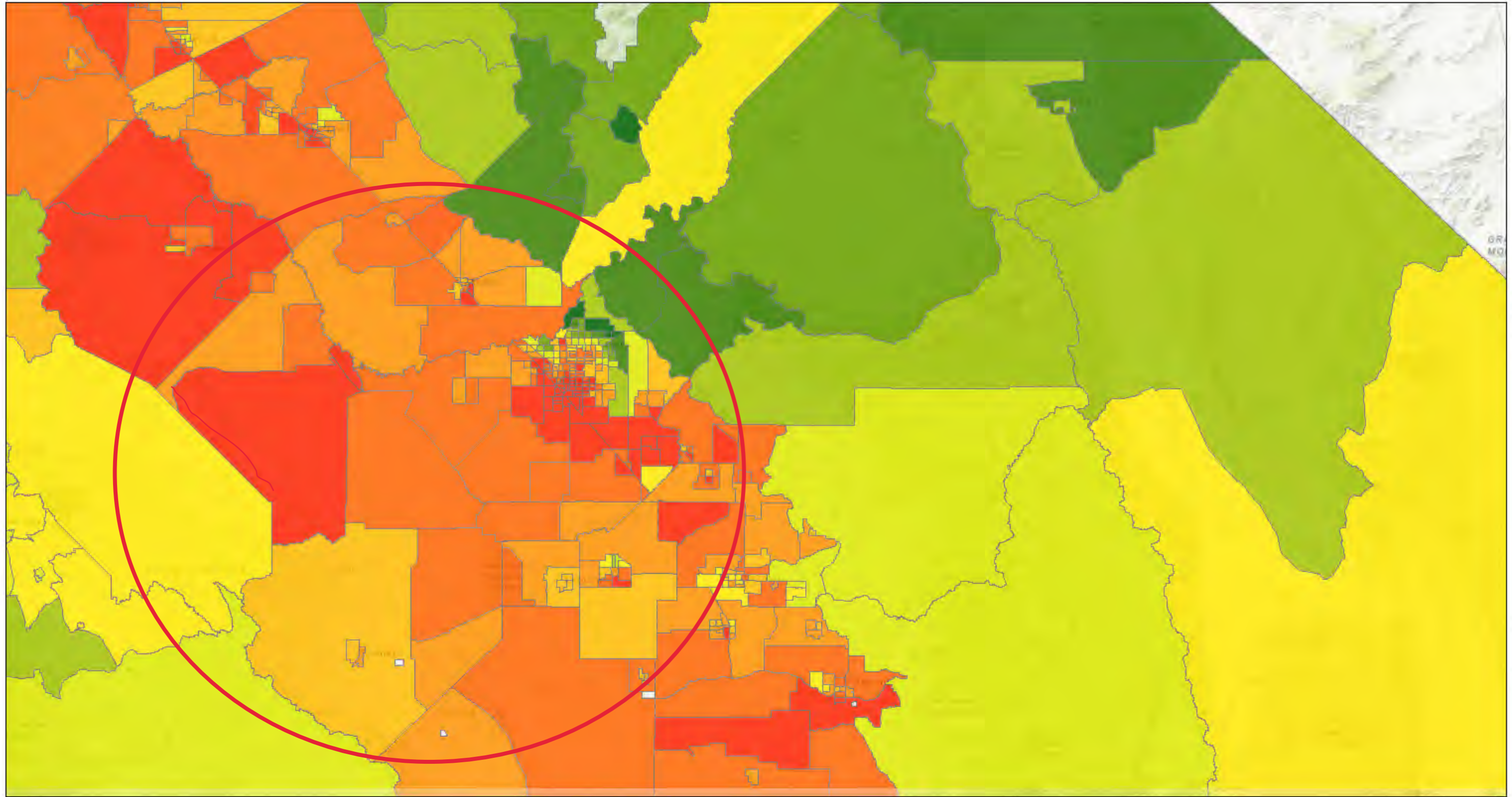

10/20/2021, 3:21:10 PM

CalEnviroScreen 3.0

- 1 - 10%
- 11 - 20%
- 21 - 30%
- 31 - 40%
- 41 - 50%
- 51 - 60%
- 61 - 70%
- 71 - 80%
- 81 - 90%
- 91 - 100%
- High Pollution, Low Population

CalEnviroScreen 3.0 Results (June 2018 Update)

- 1 - 10% (Lowest Scores)
- 11 - 20%
- 21 - 30%
- 31 - 40%
- 41 - 50%
- 51 - 60%
- 61 - 70%
- 71 - 80%
- 81 - 90%
- 91 - 100% (Highest Scores)

1:1,155,581

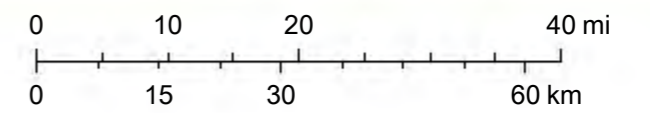

Esri, HERE, Garmin, FAO, USGS, NGA, EPA, NPS, OEHA

October 26, 2021

County of Fresno
Department of Public Works & Planning
2220 Tulare Street, 6th Floor
Fresno, CA 93721

RE: Letter of Support for Caltrans' FY 2022-23 Sustainable Transportation Planning Grant Application

To Whom it May Concern:

Fresno Council of Governments (Fresno COG) is pleased to provide this letter of support for the County of Fresno's proposal for a Caltrans Sustainable Communities grant to conduct a countywide study to identify the multimodal transportation needs of its 36 Disadvantaged Unincorporated Communities (DUCs). We understand that by preparing this study the County will be better positioned to pursue grants and partnerships to implement improvements that will expand multimodal options for the County.

The Disadvantaged Unincorporated Communities have many infrastructure needs including community-wide bicycle and pedestrian facilities, drainage, road repairs, and/or traffic control options. The County's efforts to plan for the needs of the region's DUCs will not only contribute to GHG reduction targets, but also to compliment Caltrans' planning goals.

Fresno COG works to provide efficient, safe, integrated transportation systems to serve the mobility needs of people, including accessible pedestrian and bicycle facilities, while fostering economic prosperity and development, and minimizing mobile sources of air pollution. We are committed to creating safe, active, and healthy environments in Fresno County. The proposed project supports Fresno COG's regional vision and goals. Fresno COG strongly supports the County of Fresno's application. We truly hope that Caltrans will provide Fresno County with this important grant and look forward to working with Fresno County on this project and others that improve transportation options for our communities.

Sincerely,



Tony Boren
Executive Director

City of Clovis
City of Coalinga
City of Firebaugh
City of Fowler
City of Fresno
City of Huron
City of Kerman
City of Kingsburg
City of Mendota
City of Orange Cove
City of Parlier
City of Reedley
City of San Joaquin
City of Sanger
City of Selma
County of Fresno



Fresno County Rural Transit Agency

2035 Tulare Street, Suite 201, Fresno, CA 93721
tel 559-233-6789 Fax 559-233-9645
www.ruraltransit.org

October 25, 2021

From: Moses Stites
Fresno County Rural Transit Agency
2035 Tulare Street, Suite 201
Fresno, CA 93721

To: County of Fresno
Department of Public Works & Planning
2220 Tulare Street, 6th Floor
Fresno, CA 93721

RE: Letter of Support for Caltrans' FY 2022-23 Sustainable Transportation Planning Grant Application

To Whom it May Concern:

Fresno County Rural Transit Agency (FCRTA) is pleased to provide this letter of support for the Caltrans Sustainable Transportation Planning Grant proposed by the Fresno County Department of Public Works and Planning (County) to conduct a county-wide study to identify the multi-modal transportation needs of its 36 Disadvantaged Unincorporated Communities (DUCs).

The 36 unincorporated communities in Fresno County are small, severely disadvantaged communities. These communities have many infrastructure needs including community-wide bicycle and pedestrian facilities, drainage, road repairs, and/or traffic control options. The project will help identify and highlight which communities should be the subject of focus for future multi-modal grant opportunities.

In conclusion, FCRTA believes the County's efforts to plan for the needs of the region's DUCs will not only contribute to GHG reduction targets, but also to compliment Caltrans' planning goals. I fully support the efforts the County is taking as they seek external funding to support a study designed to help address the needs of its DUCs. Any funding programs that can help our residents travel more safely, either as drivers, cyclists, or pedestrians, is greatly needed. I appreciate Caltrans' consideration of this project and am very pleased to submit this letter of support.

Sincerely,

Moses Stites
Fresno County Rural Transit Agency

ATTACHMENT F

October 21st, 2021

From: Mr. Henry F Murrieta
CAC President
3534 S Harding Ave
Malaga CA 93725

To: County of Fresno
Department of Public Works & Planning
2220 Tulare Street, 6th Floor
Fresno, CA 93721

RE: Letter of Support for Caltrans' FY 2022-23 Sustainable Transportation Planning Grant Application

To Whom it May Concern:

Malaga County Water District is pleased to provide this letter of support for the Caltrans Sustainable Transportation Planning Grant proposed by the Fresno County Department of Public Works and Planning (County) to conduct a county-wide study to identify the multi-modal transportation needs of its 36 Disadvantaged Unincorporated Communities (DUCs).

The unincorporated community of Malaga is a small, severely disadvantaged community. The community has many infrastructure needs including community-wide bicycle and pedestrian facilities, drainage, road repairs, and/or traffic control options. The project will help identify and highlight which communities should be the subject of focus for future multi-modal grant opportunities.

In conclusion, we believe the County's efforts to plan for the needs of the region's DUCs will not only contribute to GHG reduction targets, but also to compliment Caltrans' planning goals. I fully support the efforts the County is taking as they seek external funding to support a study designed to help address the needs of its DUCs. Any funding programs that can help our residents travel more safely, either as drivers, cyclists, or pedestrians, is greatly needed. I appreciate Caltrans' consideration of this project and am very pleased to submit this letter of support.

Sincerely,

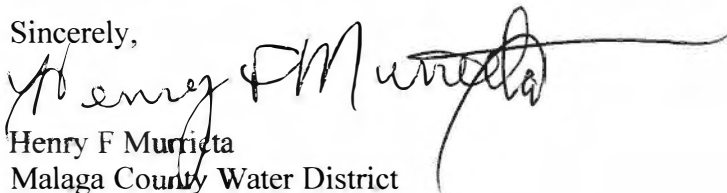

Henry F Murrieta
Malaga County Water District

October 20, 2021

From: Mr. Donald Pauley
2380 Howard St.
Kingsburg, CA 93631

To: County of Fresno
Department of Public Works & Planning
2220 Tulare Street, 6th Floor
Fresno, CA 93721

RE: Letter of Support for Caltrans' FY 2022-23 Sustainable Transportation Planning Grant Application

To Whom it May Concern:

I am pleased to provide this letter of support for the Caltrans Sustainable Transportation Planning Grant proposed by the Fresno County Department of Public Works and Planning (County) to conduct a county-wide study to identify the multi-modal transportation needs of its 36 Disadvantaged Unincorporated Communities (DUCs).

The unincorporated community of Del Rey is a small, severely disadvantaged community. The community has many infrastructure needs including community-wide bicycle and pedestrian facilities, drainage, road repairs, and/or traffic control options. The project will help identify and highlight which communities should be the subject of focus for future multi-modal grant opportunities.

In conclusion, I believe the County's efforts to plan for the needs of the region's DUCs will not only contribute to GHG reduction targets, but also to compliment Caltrans' planning goals. I fully support the efforts the County is taking as they seek external funding to support a study designed to help address the needs of its DUCs. Any funding programs that can help our residents travel more safely, either as drivers, cyclists, or pedestrians, is greatly needed. I appreciate Caltrans' consideration of this project and am very pleased to submit this letter of support.

Sincerely,

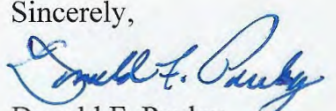

Donald F. Pauley

LATON COMMUNITY SERVICES DISTRICT
20798 S. Fowler Ave. ~ P.O. Box 447~ Laton, CA 93242
(559) 923-4802 Fax (559) 923-9501
latonwater@sbcglobal.net

October 20, 2021

From: Laton Community Services District
Po Box 447
Laton, CA 93242

To: County of Fresno
Department of Public Works & Planning
2220 Tulare Street, 6th Floor
Fresno, CA 93721

RE: Letter of Support for Caltrans' FY 2022-23 Sustainable Transportation Planning Grant Application

To Whom it May Concern:

Laton Community Services District is pleased to provide this letter of support for the Caltrans Sustainable Transportation Planning Grant proposed by the Fresno County Department of Public Works and Planning (County) to conduct a county-wide study to identify the multi-modal transportation needs of its 36 Disadvantaged Unincorporated Communities (DUCs).

The unincorporated community of Laton is a small, severely disadvantaged community. The community has many infrastructure needs including community-wide bicycle and pedestrian facilities, drainage, road repairs, and/or traffic control options. The project will help identify and highlight which communities should be the subject of focus for future multi-modal grant opportunities.

In conclusion, we believe the County's efforts to plan for the needs of the region's DUCs will not only contribute to GHG reduction targets, but also to compliment Caltrans' planning goals. I fully support the efforts the County is taking as they seek external funding to support a study designed to help address the needs of its DUCs. Any funding programs that can help our residents travel more safely, either as drivers, cyclists, or pedestrians, is greatly needed. I appreciate Caltrans' consideration of this project and am very pleased to submit this letter of support.

Sincerely,

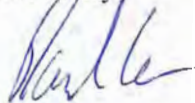

Paul Garcia
Board President

ATTACHMENT G

MEDIAN HOUSEHOLD INCOME (MHI)
COUNTY OF FRESNO DISADVANTAGED UNICORPORATED COMMUNITIES

COMMUNITY	MHI
ASHLAN AVE COMMUNITY	\$37,268
BIOLA COMMUNITY	\$36,208
BRITTEN AVENUE/CHERRY AVENUE COMMUNITY	\$51,029
BURRELL COMMUNITY	\$34,541
CAMDEN AVENUE COMMUNITY	\$34,541
CARILLO AVENUE COMMUNITY	\$34,541
CARUTHERS COMMUNITY	\$42,683
CHESTNUT AVENUE COMMUNITY - SHADY LAKES	\$49,500
CHURCH AVENUE/FLOYD AVENUE COMMUNITY	\$33,993
CORNELIA AVENUE/FLORAL AVENUE COMMUNITY	\$38,612
CSA 30 - EL PORVENIR	\$26,071
CSA 32 - CANTUA CREEK	\$30,111
CSA 39 - ZONE A COMMUNITY	\$50,795
CSA 39 - ZONE B COMMUNITY	\$50,795
CSA 43 - RAISIN CITY	\$34,541
CSA 49 - O'NEILL FARMS/WESTSIDE	\$22,543
DEL REY COMMUNITY	\$26,193
EAST ADAMS AVENUE COMMUNITY	\$47,639
EASTON COMMUNITY	\$43,646
FIVE POINTS COMMUNITY	\$26,327
FLAMINGO MOBILE HOME COMMUNITY	\$30,458
HAYES ROAD COMMUNITY/PERRIN COLONY	\$34,541
HUGHES AVENUE/MAGNOLIA AVENUE COMMUNITY	\$42,683
LANARE COMMUNITY	\$26,375
LATON COMMUNITY	\$30,743
LOST HILLS COMMUNITY	\$34,875
MADERA AVENUE COMMUNITY	\$33,993

ATTACHMENT G

MEDIAN HOUSEHOLD INCOME (MHI)
COUNTY OF FRESNO DISADVANTAGED UNINCORPORATED COMMUNITIES

MALAGA COMMUNITY	\$30,458
MONMOUTH COMMUNITY	\$32,969
PARLIER AVENUE/ELM AVENUE COMMUNITY	\$34,541
RIVERDALE COMMUNITY	\$46,513
RUSSELL AVENUE COMMUNITY	\$40,086
TOMBSTONE TERRITORY	\$27,000
TRANQUILLITY COMMUNITY	\$30,111
WHITESBRIDGE COMMUNITY	\$30,111
YUBA AVENUE COMMUNITY	\$33,993
AVG MHI	\$35,862

Source: FFIEC Geocoding/Mapping System, retrieved 10/14/2021
<https://geomap.ffiec.gov/FFIECGeocMap/GeocodeMap1.aspx>

State Controller's Office

Remittance Advice

Highway Users Tax Counties

Claim Schedule: 2100075A

Issue Date: September 30, 2021

Fiscal Year: 2021-2022

Collection Period: August 24, 2021 - September 23, 2021

Description: Streets & Highways Code sections 2103, 2104, 2105 and 2106.

For assistance, please contact Mr. Tam Nguyen at 916-327-0064 or at CNNguyen@sco.ca.gov.

ATTACHMENT H

COUNTY OF FRESNO

HIGHWAY USERS TAX (HUTA)

County	Registered Vehicles by County	Maintained Miles by County	2103 Amount	2104 Amount	2105 Amount	2106 Amount	Payment Amount	Year to Date
Total	33,984,949	65,368.96	\$30,258,246.29	\$33,710,294.99	\$17,630,974.09	\$2,701,829.78	\$84,301,345.15	\$247,300,189.94
Fresno County Treasurer	866,445	3,488.48	\$982,265.04	\$853,114.69	\$529,139.55	\$97,164.57	\$2,461,683.85	\$7,232,947.47
Kern County Treasurer	787,207	3,329.02	\$910,900.45	\$771,471.81	\$490,695.88	\$170,863.98	\$2,343,932.12	\$6,888,183.50
Los Angeles County Treasurer	7,695,508	3,289.75	\$5,519,421.84	\$7,424,605.85	\$3,392,632.48	\$202,657.13	\$16,539,317.30	\$48,388,514.37
Tulare County Treasurer	421,530	2,965.48	\$624,647.89	\$414,482.33	\$336,493.63	\$61,679.43	\$1,437,303.28	\$4,234,734.00
Imperial County Treasurer	217,851	2,572.15	\$443,123.29	\$211,175.16	\$238,707.68	\$36,137.14	\$929,143.27	\$2,758,834.88
San Bernardino County Treasurer	1,924,828	2,560.10	\$1,581,574.55	\$1,927,580.65	\$887,089.90	\$110,217.34	\$4,506,462.44	\$13,202,176.75
Riverside County Treasurer	2,100,829	2,210.63	\$1,658,659.41	\$2,030,942.90	\$942,340.74	\$125,968.82	\$4,757,911.87	\$13,923,072.00
Sacramento County Treasurer	1,375,109	2,209.42	\$1,173,914.84	\$1,324,114.71	\$669,642.04	\$188,003.16	\$3,355,674.75	\$9,827,587.71
San Diego County Treasurer Public Works Road	2,911,334	1,945.50	\$2,169,198.62	\$2,811,112.26	\$1,317,683.59	\$154,519.33	\$6,452,513.80	\$18,876,318.10
Merced County Treasurer	249,665	1,756.14	\$369,937.81	\$241,770.81	\$199,283.08	\$51,101.77	\$862,093.47	\$2,538,919.86
San Joaquin County Treasurer	710,702	1,649.28	\$665,432.51	\$685,151.89	\$358,463.96	\$77,375.20	\$1,786,423.56	\$5,236,454.27
Stanislaus County Treasurer	522,781	1,507.23	\$523,508.80	\$504,427.54	\$282,010.68	\$63,616.15	\$1,373,563.17	\$4,033,353.13
Madera County Treasurer	152,598	1,499.96	\$275,475.24	\$150,690.52	\$148,396.54	\$42,924.16	\$617,486.46	\$1,821,459.02
Sonoma County Treasurer	520,718	1,368.78	\$506,109.64	\$506,709.37	\$272,637.74	\$81,455.22	\$1,366,911.97	\$4,014,091.66
Siskiyou County Treasurer	66,570	1,361.23	\$201,975.48	\$130,486.90	\$108,802.90	\$17,824.75	\$459,090.03	\$1,372,795.06
San Luis Obispo County Treasurer	306,239	1,349.32	\$360,637.87	\$298,675.28	\$194,273.13	\$55,889.77	\$909,476.05	\$2,675,365.04
Butte County Treasurer	220,826	1,285.32	\$296,196.61	\$221,234.95	\$159,559.21	\$35,441.42	\$712,432.19	\$2,100,202.07
Monterey County Treasurer	397,702	1,261.67	\$411,569.98	\$385,680.65	\$221,709.97	\$76,625.32	\$1,095,585.92	\$3,213,552.98
Humboldt County Treasurer	152,651	1,201.88	\$241,016.52	\$154,905.33	\$129,833.87	\$35,670.72	\$561,426.44	\$1,657,089.46
Shasta County Treasurer	217,985	1,179.44	\$282,046.97	\$226,221.63	\$151,936.72	\$34,343.57	\$694,548.89	\$2,046,563.16
Inyo County Treasurer	29,562	1,095.59	\$146,523.00	\$80,583.66	\$78,930.87	\$10,780.88	\$316,818.41	\$948,227.98
Tehama County Treasurer	77,285	1,088.80	\$177,604.62	\$85,704.45	\$95,674.47	\$23,099.34	\$382,082.88	\$1,140,862.75
El Dorado County Treasurer	232,231	1,082.69	\$280,363.83	\$316,789.92	\$188,400.28	\$73,379.03	\$858,933.06	\$2,529,021.26
Placer County Treasurer	441,678	1,055.88	\$417,121.03	\$523,912.34	\$276,830.73	\$71,515.37	\$1,289,379.47	\$3,786,016.48
Mendocino County Treasurer	117,398	1,016.86	\$196,065.39	\$117,928.43	\$105,619.21	\$35,445.92	\$455,058.95	\$1,344,377.22
Modoc County Treasurer	14,477	982.87	\$123,405.82	\$72,338.37	\$66,477.90	\$5,529.49	\$267,751.58	\$802,200.98
San Francisco County Treasurer	462,198	943.07	\$417,768.92	\$446,587.95	\$225,049.33	\$800.00	\$1,090,206.20	\$3,205,284.61
Kings County Treasurer	121,380	926.50	\$188,267.84	\$118,398.62	\$101,418.72	\$18,690.82	\$426,776.00	\$1,259,465.97
Lassen County Treasurer	37,470	879.13	\$126,754.65	\$78,273.08	\$68,281.81	\$10,990.88	\$284,300.42	\$850,814.25
Glenn County Treasurer	39,829	861.45	\$126,283.95	\$63,120.93	\$68,028.34	\$12,463.14	\$269,896.36	\$806,664.75
Santa Barbara County Treasurer	400,207	827.93	\$363,049.88	\$389,739.72	\$204,876.55	\$70,205.80	\$1,027,871.95	\$3,013,427.91
Sutter County Treasurer	108,544	759.60	\$160,382.68	\$106,054.19	\$86,397.04	\$17,531.68	\$370,365.59	\$1,091,737.22
Yolo County Treasurer	197,123	752.09	\$218,662.86	\$191,240.96	\$117,792.31	\$14,298.46	\$541,994.59	\$1,594,105.72
Colusa County Treasurer	31,302	713.24	\$103,438.98	\$51,419.13	\$55,721.91	\$9,991.84	\$220,571.86	\$659,560.54
Trinity County Treasurer	19,910	692.63	\$93,446.88	\$58,270.00	\$50,339.35	\$8,415.04	\$210,471.27	\$629,981.99
Calaveras County Treasurer	79,102	689.64	\$132,626.74	\$89,496.52	\$71,445.13	\$28,884.35	\$322,452.74	\$951,532.39
Plumas County Treasurer	34,358	681.50	\$101,806.65	\$87,518.82	\$54,990.37	\$13,524.29	\$257,840.13	\$771,122.93

State Controller's Office
 Remittance Advice
 Highway Users Tax Counties
 Claim Schedule: 2100075A
 Issue Date: September 30, 2021
 Fiscal Year: 2021-2022
 Collection Period: August 24, 2021 - September 23, 2021

ATTACHMENT H
COUNTY OF FRESNO
HIGHWAY USERS TAX (HUTA)

Description: Streets & Highways Code sections 2103, 2104, 2105 and 2106.

For assistance, please contact Mr. Tam Nguyen at 916-327-0064 or at CNNguyen@sco.ca.gov.

County	Registered Vehicles by County	Maintained Miles by County	2103 Amount	2104 Amount	2105 Amount	2106 Amount	Payment Amount	Year to Date
Mono County Treasurer	18,125	679.26	\$90,707.74	\$64,850.04	\$48,863.56	\$2,649.11	\$207,070.45	\$620,464.36
Contra Costa County Treasurer	1,034,441	661.63	\$767,319.62	\$1,000,899.22	\$481,977.21	\$76,542.41	\$2,326,738.46	\$6,803,853.14
Yuba County Treasurer	76,048	655.21	\$126,603.14	\$78,165.11	\$68,200.14	\$25,128.49	\$298,096.88	\$879,330.91
Santa Clara County Treasurer HUT and Traffic Congestion	1,564,692	624.16	\$1,117,062.32	\$1,506,522.86	\$691,092.56	\$22,417.46	\$3,337,095.20	\$9,765,899.90
Lake County Treasurer	91,058	615.58	\$132,040.14	\$89,411.41	\$71,129.08	\$30,309.94	\$322,890.57	\$951,915.14
Tuolumne County Treasurer	79,003	608.79	\$123,204.59	\$92,163.27	\$66,369.50	\$28,524.24	\$310,261.60	\$915,771.73
Santa Cruz County Treasurer	252,986	596.45	\$237,954.94	\$250,032.13	\$137,258.32	\$56,650.20	\$681,895.59	\$2,000,206.38
Solano County Treasurer	426,186	576.27	\$351,275.19	\$411,531.75	\$189,229.62	\$15,381.45	\$967,418.01	\$2,835,317.61
Nevada County Treasurer	130,827	562.19	\$152,417.82	\$150,059.63	\$82,106.42	\$27,584.90	\$412,168.77	\$1,215,201.06
Mariposa County Treasurer	28,317	560.50	\$83,770.49	\$44,975.76	\$45,126.64	\$11,630.49	\$185,503.38	\$554,163.66
Ventura County Treasurer	791,790	542.97	\$591,556.28	\$768,319.36	\$365,273.09	\$51,108.96	\$1,776,257.69	\$5,198,341.52
Alameda County Treasurer	1,275,672	473.37	\$906,617.65	\$1,229,581.18	\$568,055.10	\$32,346.32	\$2,736,600.25	\$8,009,230.31
San Benito County Treasurer	70,056	450.59	\$98,923.11	\$69,485.96	\$53,289.31	\$13,981.39	\$235,679.77	\$693,972.81
Marin County Treasurer	233,751	421.64	\$204,881.45	\$228,041.67	\$114,263.54	\$25,411.50	\$572,598.16	\$1,682,239.08
Napa County Treasurer	142,782	419.10	\$143,842.34	\$139,793.51	\$77,486.86	\$27,553.87	\$388,676.58	\$1,141,505.96
Amador County Treasurer	59,669	410.11	\$87,302.73	\$63,018.93	\$47,029.33	\$16,900.55	\$214,251.54	\$631,390.25
Sierra County Treasurer	6,050	391.48	\$49,342.39	\$36,113.05	\$26,580.27	\$2,978.27	\$115,013.98	\$344,514.46
Orange County Treasurer	2,746,585	328.15	\$1,872,024.98	\$2,643,089.80	\$1,201,417.93	\$53,992.54	\$5,770,525.25	\$16,864,627.32
San Mateo County Treasurer Department of Public Works	662,322	316.16	\$478,856.45	\$638,624.67	\$305,085.66	\$23,931.24	\$1,446,498.02	\$4,230,759.22
Del Norte County Treasurer	28,485	300.14	\$53,753.56	\$29,441.81	\$28,956.63	\$9,844.46	\$121,996.46	\$360,856.62
Alpine County Treasurer	2,972	134.96	\$17,602.28	\$24,241.55	\$14,575.71	\$1,936.71	\$58,356.25	\$174,009.06

ATTACHMENT I

COUNTY OF FRESNO
VEHICLE MILES TRAVELED (VMT)
IN 36 DISADVANTAGED UNINCORPORATED COMMUNITIES

DUC	TAZ*	VMT
Ashlan Avenue Community	2374	22.38
Biola Community	2031	22.58
Britten/Cherry Avenue	2459	15.46
Burrel Community	2465	33.37
Camden Avenue Community	2490	36.36
Carillo Avenue Community	2498	26.45
Caruthers	2071, 2072, 2073, 2074, 2473	24.36, 22.28, 23.70, 22.94, 26.26
Chestnut Avenue/Shady Lakes	2502	24.19
Church/Floyd Avenues	2406	23.95
Cornelia/Floral Avenues	2142, 2472	27.62, 27.23
CSA 30/El Porvenir	2270	25.96
CSA 32/Cantua Creek	2061	19.84
CSA 39 Zone A	2440	18.76
CSA 39 Zone B/West Park	2432	15.38
CSA 43/Raisin City	2141, 2142, 2143	25.67, 27.62, 26.48
CSA 49/O'Neill Farms/Westside	2292, 2293	35.32, 32.04
Del Rey	2081, 2082	17.20, 18.86
East Adams Avenue	2607	23.82
Easton	2092, 2093, 2095, 2096, 2097, 2099	19.73, 20.01, 18.44, 17.99, 21.31, 19.10
Five Points	2062, 2287, 2294	36.04, 33.51, 33.55
Flamingo Mobile Home Community	2629	27.24
Hayes Road/Perrin Colony	2141	25.67
Hughes/Magnolia Avenues	2470	28.97
Lanare	2121, 2466	36.62, 34.79
Laton	2131	37.2
Lost Hills	2327	24.32
Madera Avenue	2400	19.32
Malaga	2051	12.67
Monmouth Community	2519	26.19
Parlier/Elm Avenue	2479	26.02
Riverdale	2152, 2153, 2154, 2155	22.91, 26.03, 20.96, 24.68
Russell Avenue	2223	25.52
Tombstone Territory	2647	15.52
Tranquillity	2181	28.48
Whitesbridge	2263	30.61
Yuba Avenue	2395	21.7

Low	12.67
High	36.36
Average	25.02

*TAZ = Transportation Analysis Zone