

ANNEXATION MAP NO. 11A OF COMMUNITY FACILITIES DISTRICT NO. 2006-01
(POLICE PROTECTION SERVICES), COUNTY OF FRESNO, STATE OF CALIFORNIA

EXHIBIT "A"

IN THE COUNTY OF FRESNO, THE STATE OF CALIFORNIA

SITE #1

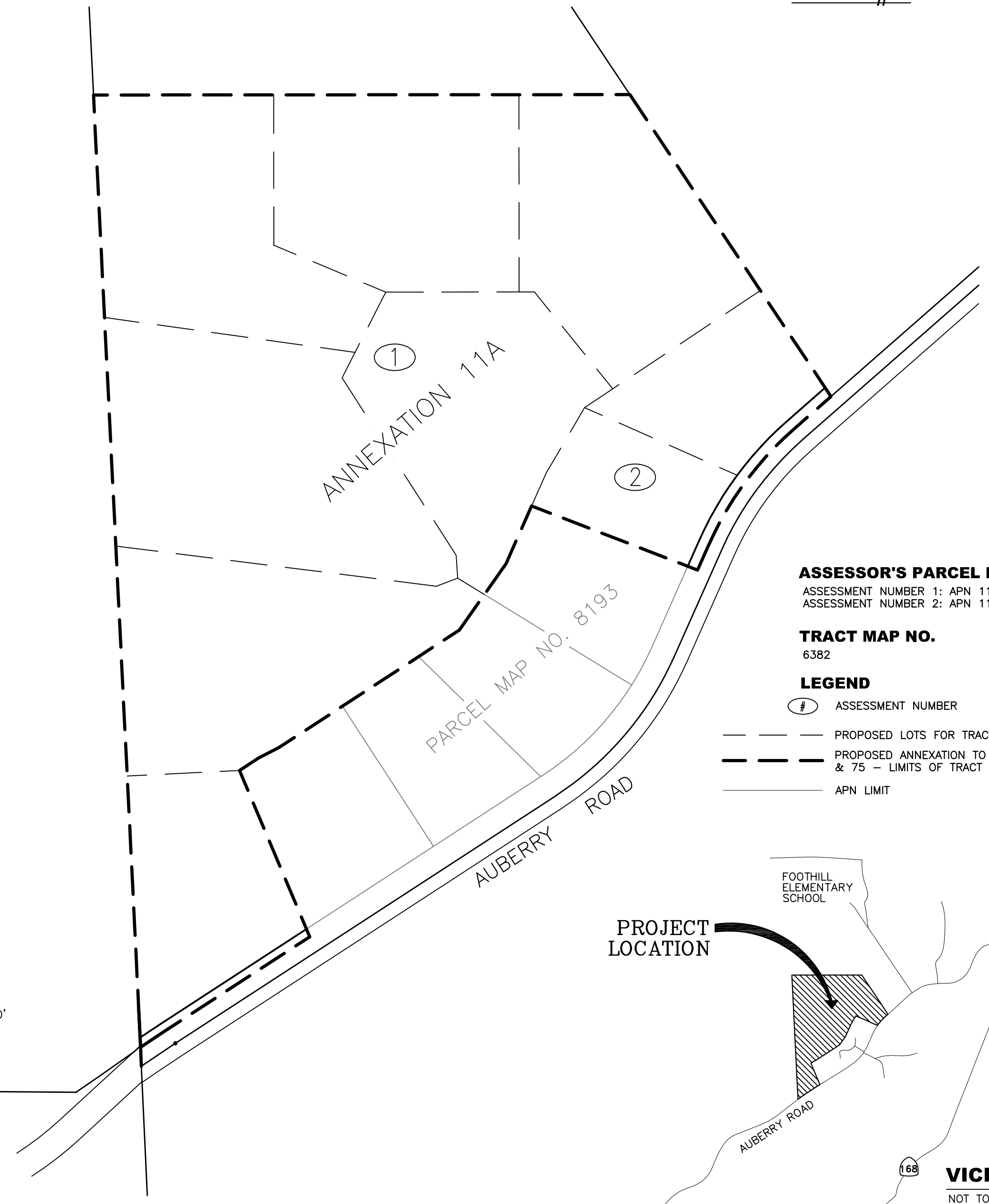

ASSESSOR'S PARCEL NUMBER:
ASSESSMENT NUMBER 1: APN 118-340-69
ASSESSMENT NUMBER 2: APN 118-340-75

TRACT MAP NO.
6382

LEGEND

- (#) ASSESSMENT NUMBER
- PROPOSED LOTS FOR TRACT 6382
- PROPOSED ANNEXATION TO CFD APN: 118-340-69 & 75 - LIMITS OF TRACT 6382
- APN LIMIT

I HEREBY CERTIFY THAT THE WITHIN MAP SHOWING BOUNDARIES OF ANNEXATION NO. 11A OF COMMUNITY FACILITIES DISTRICT NO. 2006-01 (POLICE PROTECTION SERVICES), COUNTY OF FRESNO, STATE OF CALIFORNIA WAS APPROVED BY THE BOARD OF SUPERVISORS OF THE COUNTY OF FRESNO AT A REGULAR MEETING THEREOF HELD ON THE ____ DAY OF ____, 20__ BY ITS RESOLUTION NO. _____

FILED IN THE OFFICE OF THE CLERK TO THE BOARD OF SUPERVISORS THIS ____ DAY OF _____, 20__.

CLERK TO THE BOARD OF SUPERVISORS
OF THE COUNTY OF FRESNO

FILE THIS ____ DAY OF _____, 20__ AT THE HOUR OF _____ O'CLOCK ____M, IN BOOK _____ AT PAGE(S) _____

MAPS OF ASSESSMENT AND COMMUNITY FACILITIES DISTRICTS AND AS INSTRUMENT NO _____ IN THE OFFICE OF THE COUNTY RECORDER IN THE COUNTY OF FRESNO, STATE OF CALIFORNIA.

PAUL DICTOS, CPA
COUNTY ASSESSOR-RECORDER
OF THE COUNTY OF FRESNO

BY: _____ FRESNO COUNTY RECORDER
DEPUTY RECORDER

THE LINES AND DIMENSIONS OF EACH LOT OR PARCEL SHOWN ON THIS DIAGRAM SHALL BE THOSE LINES AND DIMENSIONS AS SHOWN ON THE FRESNO COUNTY ASSESSOR'S MAP FOR THOSE PARCELS LISTED.

THE FRESNO COUNTY ASSESSOR'S MAP SHALL GOVERN FOR ALL DETAIL CONCERNING THE LINES AND DIMENSIONS OF SUCH LOTS AND PARCELS.

THE BOARD OF SUPERVISORS OF THE COUNTY OF FRESNO APPROVED THE ORIGINAL BOUNDARY MAP OF THE DISTRICT, ENTITLED "MAP OF PROPOSED BOUNDARIES OF COMMUNITY FACILITIES DISTRICT NO. 2006-01 (POLICE PROTECTION SERVICES), COUNTY OF FRESNO, STATE OF CALIFORNIA", WHICH WAS FILED PURSUANT TO SECTION 3111 OF THE CALIFORNIA STREETS AND HIGHWAYS CODE, ON APRIL 3, 2006, IN BOOK 41, AT PAGE(S) 80 AND 81 OF MAPS OF ASSESSMENT AND COMMUNITY FACILITIES DISTRICTS, IN THE OFFICE OF THE COUNTY RECORDER OF THE COUNTY OF FRESNO, STATE OF CALIFORNIA, AS INSTRUMENT NO. 20060068943.

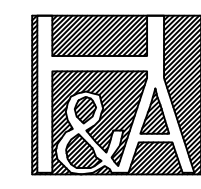
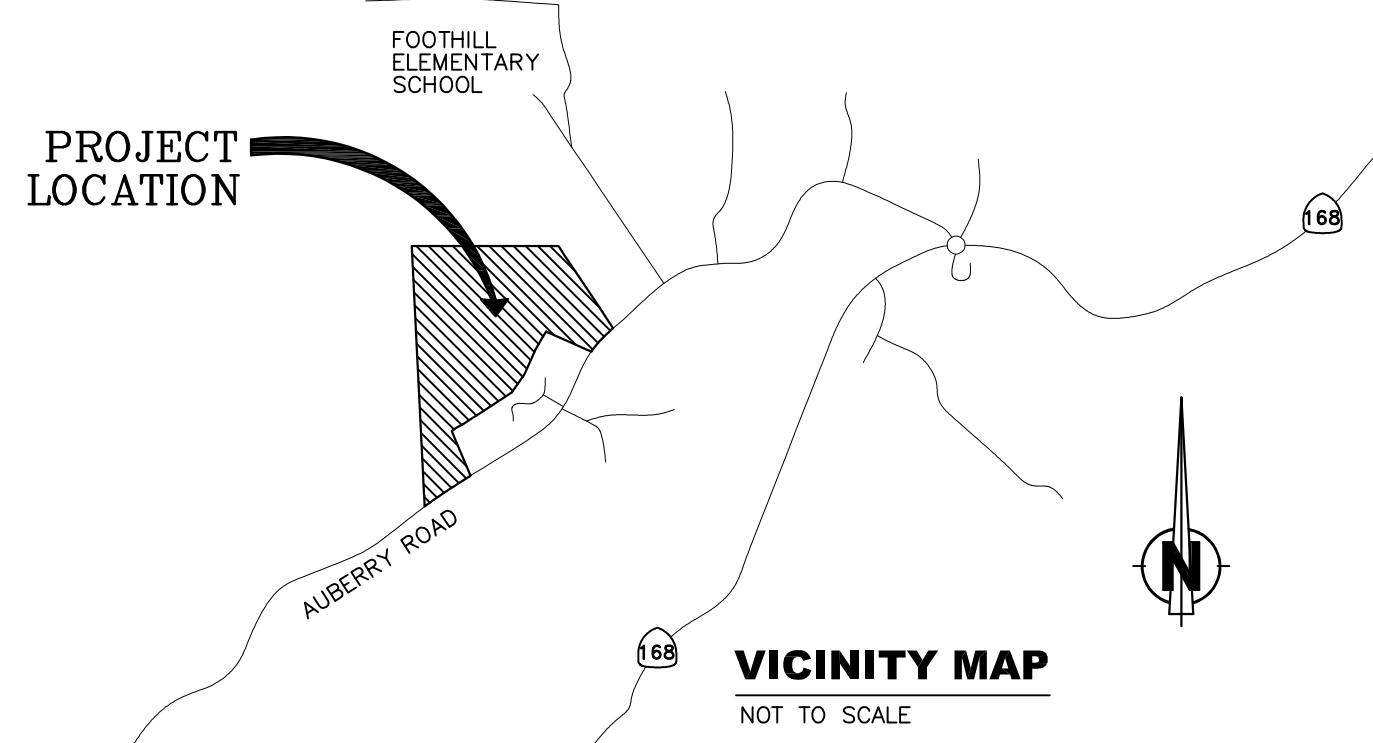
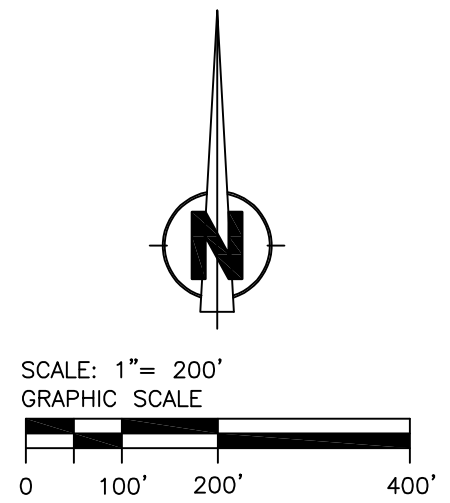

Harbour & Associates
Civil Engineers
389 Clovis Avenue, Suite 300 • Clovis, California 93612
(559) 325-7676 • Fax (559) 325-7699

EXHIBIT "A"
Legal Description

For APN/Parcel ID(s): 118-340-69 and 118-340-75

THE LAND REFERRED TO HEREIN BELOW IS SITUATED IN THE UNINCORPORATED AREA IN COUNTY OF FRESNO, STATE OF CALIFORNIA AND IS DESCRIBED AS FOLLOWS:

PARCEL 1: APN 118-340-69

PARCEL A AS SHOWN ON THE CERTIFICATE OF COMPLIANCE PLA NO. 19-10(a), RECORDED JANUARY 10, 2020 AS INSTRUMENT NO. 2020-0003200 OF OFFICIAL RECORDS.

ALL THAT PORTION OF SECTION 25, TOWNSHIP 10 SOUTH, RANGE 22 EAST, MOUNT DIABLO BASE AND MERIDIAN, AS DESCRIBED IN THE DEED RECORDED DECEMBER 12, 2019 AS DOCUMENT NO. 2019-0146220, OFFICIAL RECORDS FRESNO COUNTY.

EXCEPTING THEREFROM:

ALL THAT PORTION DESCRIBED MORE PARTICULARLY AS FOLLOWED:

COMMENCING AT A POINT ON THE NORTHERLY LINE OF AUBERRY ROAD BEING THE WESTERLY TERMINUS OF COURSE NUMBER 21 AS DESCRIBED IN THE DEED FROM THE EARL L. WILSON TESTAMENTARY TRUST TO FRESNO COUNTY RECORDED MAY 7, 1984 AS DOCUMENT NO. 84043737, OFFICIAL RECORDS FRESNO COUNTY; THENCE ALONG COURSE NO. 22 OF SAID DEED SOUTH 62°38'32" WEST, A DISTANCE OF 50.25 FEET TO THE POINT OF BEGINNING; THENCE ALONG COURSE NO. 23 OF SAID DEED SOUTH 56°55'54" WEST, A DISTANCE OF 100.00 FEET; THENCE LEAVING SAID NORTHERLY LINE, NORTH 22°56'03" WEST, A DISTANCE OF 394.15 FEET; THENCE ALONG A LINE PARALLEL WITH AND 388.00 FEET NORTHWESTERLY OF SAID COURSE NO. 23, NORTH 56°55'54" EAST, A DISTANCE OF 50.00 FEET; THENCE SOUTH 30°12'47" EAST A DISTANCE OF 388.48 FEET TO THE POINT OF BEGINNING.

PARCEL 2: APN 118-340-75

ALL THAT PORTION OF SECTION 25, TOWNSHIP 10 SOUTH, RANGE 22 EAST, MOUNT DIABLO BASE AND MERIDIAN, ACCORDING TO THE OFFICIAL PLAT THEREOF, MORE PARTICULARLY DESCRIBED AS FOLLOWS:

BEGINNING AT A POINT ON THE NORTHERLY LINE OF AUBERRY ROAD BEING THE WESTERLY TERMINUS OF COURSE NUMBER 21 AS DESCRIBED IN THE DEED FROM THE EARL L. WILSON TESTAMENTARY TRUST TO FRESNO COUNTY RECORDED MAY 7, 1984 AS DOCUMENT NO. 84043737, OFFICIAL RECORDS FRESNO COUNTY;

THENCE ALONG COURSE NO. 22 OF SAID DEED SOUTH 62°38'32" WEST, A DISTANCE OF 50.25 FEET;

THENCE ALONG COURSE NO. 23 OF SAID DEED SOUTH 56°55'54" WEST, A DISTANCE OF 100.00 FEET;

THENCE LEAVING SAID NORTHERLY LINE, NORTH 22°56'03" WEST, A DISTANCE OF 394.15 FEET;

THENCE ALONG A LINE PARALLEL WITH AND 388.00 FEET NORTHWESTERLY OF SAID COURSE NO. 23, NORTH 56°55'54" EAST, A DISTANCE OF 50.00 FEET;

THENCE ALONG A LINE PARALLEL WITH AND 388.00 FEET NORTHWESTERLY OF SAID COURSE NO. 22, NORTH 62°38'32" EAST, A DISTANCE OF 50.25 FEET;

THENCE ALONG A LINE PARALLEL WITH AND 388.00 FEET NORTHWESTERLY OF COURSE NO. 21 OF SAID DEED NORTH 56°55'54" EAST, A DISTANCE OF 469.73 FEET;

THENCE ALONG A LINE PARALLEL WITH AND 388.00 FEET NORTHWESTERLY OF COURSE NO. 19 OF SAID DEED, NORTH 35°01'38" EAST, A DISTANCE OF 177.24 FEET;

EXHIBIT "A"
Legal Description

THENCE ALONG A LINE PARALLEL WITH AND 388.00 FEET NORTHWESTERLY OF COURSE NO. 18 OF SAID DEED, NORTH 23° 54' 51" EAST, A DISTANCE OF 217.32 FEET;

THENCE NORTH 30°23'20" EAST, A DISTANCE OF 164.66 FEET;

THENCE SOUTH 66°05'09" EAST, A DISTANCE OF 388.00 FEET TO THE INTERSECTION WITH SAID NORTHERLY LINE OF AUBERRY ROAD BEING A CURVE CONCAVE TO THE SOUTHEAST HAVING A RADIUS OF 730.00 FEET THE CENTER OF SAID CURVE BEARS SOUTH 53°08'09" EAST; THENCE SOUTHERLY ALONG SAID CURVE THROUGH A CENTRAL ANGLE OF 12° 57" 02", AN ARC LENGTH OF 165.00 FEET;

THENCE CONTINUING ALONG SAID NORTHERLY LINE OF AUBERRY ROAD THE FOLLOWING (4) FOUR COURSES:

- 1) ALONG COURSE NO. 18 OF SAID DEED SOUTH 23°54'51" WEST, A DISTANCE OF 255.07 FEET;
- 2) THENCE ALONG COURSE NO. 19 OF SAID DEED SOUTH 35°01'38" WEST, A DISTANCE OF 258.34 FEET TO THE BEGINNING OF A NON-TANGENT CURVE, CONCAVE TO THE NORTHWEST, HAVING A RADIUS 670.00 FEET, THE CENTER OF WHICH BEARS NORTH 43°51'17" WEST;
- 3) THENCE ALONG COURSE NO. 20 OF SAID DEED SOUTHWESTERLY ALONG SAID NON TANGENT CURVE THROUGH A CENTRAL ANGLE OF 10°47'08", AN ARC DISTANCE OF 126.12 FEET;
- 4) THENCE ALONG COURSE NO. 21 OF SAID DEED SOUTH 56°55'54" WEST, A DISTANCE OF 468.23 FEET TO THE POINT OF BEGINNING.

PURSUANT TO CERTIFICATE OF COMPLIANCE PLA 19-10(B) RECORDED JANUARY 10, 2020, INSTRUMENT NO. 2020-0003201, OFFICIAL RECORDS.

EXCEPTING THEREFROM PARCELS 1, 2, 3 AND 4 OF PARCEL MAP NO. 8193, IN THE UNINCORPORATED AREA, COUNTY OF FRESNO, STATE OF CALIFORNIA, AS PER PLAT RECORDED IN BOOK 76, PAGES 5 THRU 7 OF PARCEL MAPS, RECORDS OF SAID COUNTY.